

MICROCOPY RESOLUTION TEST CHART

R80-142
OCTOBER 1980

18

LEVEL II

AD A 097165

FINAL REPORT

15kW GENERAL PURPOSE POWER CONDITIONER

(FREQUENCY CHANGER)

INVERTER/CONVERTER INTEGRATION

CONTRACT DAAK 70-77-C-0157

Prepared for

U.S. ARMY MOBILITY EQUIPMENT
RESEARCH and DEVELOPMENT COMMAND
Fort Belvoir, Virginia

DTIC
ELECTE
MAR 31 1981
S B

DTIC FILE COPY

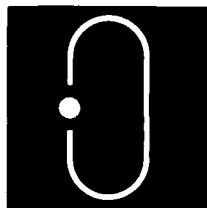

Delco Electronics

General Motors Corporation
- Santa Barbara Operations
Santa Barbara, California

DISTRIBUTION STATEMENT A
Approved for public release;
Distribution Unlimited

81 3 05 054

R80-142

OCTOBER 1980

FINAL REPORT

15kW GENERAL PURPOSE POWER CONDITIONER

(FREQUENCY CHANGER).

INVERTER/CONVERTER INTEGRATION.

CONTRACT DAAK 70-77-C-0157

Prepared for

U.S. ARMY MOBILITY EQUIPMENT
RESEARCH and DEVELOPMENT COMMAND
Fort Belvoir, Virginia

Contract Initiated: *September 1977*

Prelim. Design Completed: *March 1978*

Inverter Fabrication/Assembly Completed: *October 1978*

Inverter/Converter Integration Completed: *November 1979*

Project Engineer: *A.H. Barrett, Delco Electronics*

Program Manager: *R.F. Brewster, Delco Electronics*

Contracting Officer's

Representative: *R. Williams, MERADCOM*

DISTRIBUTION STATEMENT A

Approved for public release;
Distribution Unlimited

400400

TABLE OF CONTENTS

<u>Section</u>	<u>Page</u>
I Introduction	1
II Prior Contract Effort	3
2.1 Introduction	3
2.2 Preliminary Design	3
2.3 Inverter Fabrication and Assembly	5
III Inverter/Converter Integration	8
3.1 Development Aspects	8
3.2 Inverter Group	8
3.3 Converter Group	11
3.4 Support Functions	14
IV Summary of Test Performance	31
4.1 Summary	31
V Conclusions and Recommendations	44
5.1 Parameter 2 — Frequency Changer Input Frequency and Parameter 3 — Input Current,	44
5.2 Parameter 13 — Short Circuit Current	44
5.3 Parameter 16 — No Load Losses, Parameter 17 — Efficiency at Full Load, Parameter 18 — Efficiency at Rated Load	45
5.4 Recommendations	45
 APPENDIX: Parts Lists and Diagrams (See divider for contents.)	 A-1

Accession For	
NTIS GRA&I	<input checked="" type="checkbox"/>
DTIC TAB	<input type="checkbox"/>
Unannounced	<input type="checkbox"/>
Justification	
PER LETTER	
By	
Distribution/	
Availability Codes	
Avail and/or	
Dist	Special
A	

LIST OF ILLUSTRATIONS

<u>Figure</u>		<u>Page</u>
1	Family Tree, 15 kW Power Conditioner	9
2	Block Diagram, 15 kW Frequency Changer	10
3	Inverter Power Assembly Divisions	12
4	Power Conditioner CCA's	13
5	Three-Phase Power Assembly Division	15
6	Resonant Converter Assembly	16
7	Input/Output Assembly	17
8	Input/Output Circuit and Power Supply Assemblies	19
9	Auxiliary Power Supply Assembly A24	21
10	A20, Converter Sense CCA	22
11	A-21, Start/Protect CCA No. 1	24
12	A-22, Start/Protect CCA No. 2	25
13	A23, Regulator A	28
14	15 kW Frequency Changer	29
15	Control Panel	30
16	Output Voltage Regulation, 60 Hz	33
17	Output Voltage Regulation, 400 Hz	34
18	Frequency Changer Losses, 60 Hz Output	35
19	Frequency Changer Losses, 400 Hz Output	36
20	Converter/Inverter Losses vs Load, 60 Hz Output	37
21	Converter/Inverter Losses vs Load, 400 Hz Output	38
22	Converter/Inverter and Frequency Changer Efficiency, 60 Hz Output	39
23	Converter/Inverter and Frequency Changer Efficiency, 400 Hz Output	40
24	Total Harmonic Distortion versus Load, 60 Hz Output	41
25	Total Harmonic Distortion versus Load, 400 Hz Output	42

PREFACE

The work reported herein was performed by Delco Electronics Division, Santa Barbara Operations, under contract to the United States Army Mobility Equipment Research and Development Command (Contract DAAK70-77-C-0157). The Contracting Officer's Representative is Robert Williams at Fort Belvoir, Virginia.

This report is the final report of effort associated with development of the 15kW General Purpose Power Conditioner. Since this is the Final Report, a summary of tasks previously covered by the following Interim Reports is provided.

1. Inverter Preliminary Design (R78-67, July 1978)
2. Inverter Fabrication & Assembly (R78-117, October 1978).

The main body of the report, however, concentrates upon the Inverter/Converter Integration phase of the contract, a phase which has not previously been reported. The integration effort was started in November 1978 and finished in November of 1979 and was followed by successful completion of the required Performance and Endurance Tests as reported in test report R80-122, dated September 1980.

DELCO ELECTRONICS DIVISION • SANTA BARBARA OPERATIONS • GENERAL MOTORS CORPORATION

SECTION I
INTRODUCTION

This report covers effort under Contract DAAK70-77-C-0157. The contract requires that Delco Electronics — Santa Barbara Operations furnish the engineering, labor, tools, services, materials, equipment, and facilities necessary to design, assemble, test, and deliver one Advanced Development Unit (per definition of MLL-STD-280A) Inverter Section for a 15 kW General Purpose Power Conditioner Unit (PCU) in general accordance with Purchase Description EED 76061101, "Inverter Section of 15 kW General Purpose Power Conditioner," dated October 1976, and as amended by Addendum 1, dated January 1977.

The required effort was originally proposed by Delco as an integrated program that assumed concurrent and/or serial performance of various tasks to achieve coherence and cost effectivity. Due to FY 1978 funding limitations the contract was awarded on an incremental funding basis and required a shift in performance schedules. The initial funding increment was directed toward the first contract line item, CLIN 0001, Preliminary Design, which was completed in March 1978, and recorded in the first interim report (R78-67, dated July 1978) after funding for selected data items was released in May 1978. The Preliminary Design effort involved breadboard inverter development to overcome performance deficiencies previously encountered in MERADCOM testing of Delco inverters; cost tradeoff investigations of three different ways of implementing the new inverter; final inverter design and mechanical/thermal packaging of the recommended approach; and preliminary frequency changer layout showing integration of the recommended inverter with the ac-to-dc converter developed by Delco under separate contract (DAAK70-77-C-0035) as reported in Final Report, R78-28, dated April 1978. The CLIN 0001 effort resulted in MERADCOM approval to proceed with CLIN 0002, Inverter Fabrication and Assembly, using the design recommended and established during preliminary design.

Upon receiving MERADCOM approval for CLIN 0002, all drawings and lists generated during final design were released to the fabrication and assembly cycle. The second interim report (R78-117, dated October 1978) provided the details of the results of that

effort. Section II of that report provided circuit schematics and photographs of the inverter control circuit card assemblies (CCA's). Section III included the power circuit schematic, the modular divisions established during the packaging effort, and photographs showing the mechanical/electrical features of the five separate power module assemblies. Section IV provided an update of CLIN 0001 concepts concerning the configuration for the completed power conditioner or frequency changer. The update showed the overall enclosure concept and provided a new weight estimate which included the actual weights of those internal modules which were fabricated/assembled under CLIN 0002 and/or under the earlier converter development contract (DAAK70-77-C-0035).

MERADCOM approval of the CLIN 0002 effort and the associated interim report resulted in release of funds (November 1978) to proceed with CLIN 0003, Inverter/Converter Integration. CLIN 0003 required design, development, fabrication, and assembly of all system support functions including the enclosure and auxiliary power supplies as well as all start-up and protection control circuits.

Following a brief summary of CLIN 0001 and CLIN 0002 efforts in Section II, this report presents the CLIN 0003 integration details as Section III. The section includes system aspects, provides overall functional block diagrams, and presents schematics and details of the newly developed control circuits. Section IV of the report provides a summary of the power conditioner performance and endurance tests and Section V presents Delco's recommendations concerning items to be considered for future Engineering Development.

SECTION II
PRIOR CONTRACT EFFORT
(CLIN 0001 & 0002 Summary)

2.1 INTRODUCTION

The work and services under contract DAAK70-77-C-0157 required that, as Contract Line Item CLIN 0001, a preliminary design effort be performed and approved by MERADCOM before proceeding with CLIN 0002, Inverter Fabrication and Assembly. The Delco effort under these two contract line items is summarized in the following pages. Details of the effort may be found in Delco interim reports R78-67, Preliminary Design, and R78-117, Inverter Fabrication and Assembly, submitted in July 1978 and October 1978, respectively.

2.2 PRELIMINARY DESIGN (CLIN 0001)

Compliance with CLIN 0001 required that tradeoff investigations into methods of implementing the Delco power center inverter be performed. The study was to trade off the use of capacitors versus solid state devices in the inverter design and to project production cost estimates for the designs evolved. A basic overriding criteria for the designs considered was that the performance deficiencies evident with previous Army/Delco developed power center inverters be overcome.

Previous Delco effort under Contract DAAK02-72-C-0210 had provided a breadboard system which established the feasibility of using the Delco power center inverter coupled with an ac-to-dc resonant converter for the 15 kW General Purpose Power Conditioner (frequency changer). MERADCOM testing of that breadboard system revealed major performance deficiencies attributable to the ac-to-dc converter and minor deficiencies which could be ascribed to the inverter.

The ac-to-dc converter has been redesigned, fabricated, and tested by Delco under a separate contract (DAAK70-77-C-0035). Performance capability substantially meeting Army Purchase Description (PD) requirements has been reported in Delco Test Report R78-28, dated March 1978, and Final Report R78-38, dated April 1978, under that contract.

The power center inverter performance deficiencies were corrected under the contract effort reported herein and were associated with the following:

- Failure to meet voltage waveform harmonic distortion requirements
- Inverter instabilities due to triplen inductor saturation under certain load transients
- Inverter commutation failures under two-per-unit loading.

Solution of these inverter problems resulted through implementation of a 20-step inverter internal line-to-neutral waveform and use of a new, more cost effective commutation scheme. The previous breadboard inverter used a 16-step waveform and required 32 SCR's. The new inverter provides added steps (thus, lower voltage waveform harmonic distortion) while requiring only 28 SCR's.

Beyond correcting the inverter performance deficiencies, the Preliminary Design effort included cost tradeoff investigations of three different ways of implementing the new inverter. The investigations concentrated upon methods of replacing capacitors with solid state switches (SCR's or transistors) and resulted in recommendation (and subsequent MERADCOM approval) of the inverter configuration successfully used by Delco in a previous Army funded program (Firefinder). The recommendation was based upon both cost and a development status considerations.

As part of the Preliminary Design, production cost projections for the alternate configurations considered were attempted. The approach used indicated that the recommended or baseline inverter may cost approximately \$15,600 per unit if a production buy were tooled and released for 1,000 units at a rate of 30 units per month. The indicated figure included material, hands-on-hardware labor, and profit. It assumed a 90% learning curve in the production cycle and was stated in December 1977 dollars.

The information and conclusions which resulted from the tradeoff studies and through correction of the inverter deficiencies were presented to MERADCOM during a design review at Delco during the first week of February 1978. The review resulted in formal approval to proceed with the final design of the baseline inverter. The final design required modification of control circuit schematics and parts lists used in the Firefinder inverter and a complete mechanical/thermal/package redesign of the inverter circuits

for dual frequency, higher power operations. Subsequent to the completion of the final design, MERADCOM provided authorization and funds to proceed with CLIN 0002 of the contract.

2.3 INVERTER FABRICATION AND ASSEMBLY (CLIN 0002)

Upon receiving MERADCOM approval for CLIN 0002, all drawings and lists generated during final design were released to the fabrication and assembly cycle. The released inverter consisted of three circuit card assemblies (CCA's) and five power circuit modules. A brief description of each of these assemblies is provided below. Note that the assembly numbers provided agree with the Family Tree breakdown included as Figure 1 in Section III of this report and have been updated from the assembly numbers used in the previous reports.

2.3.1 WAVEFORM GENERATOR CCA (A-18)

The waveform generator CCA contains the circuitry necessary to develop the SCR drive timing pulses, as well as the circuitry necessary to synchronize output phases when two similar power center inverters are operated in parallel. The major portion of the waveform generator circuit was unchanged from a first generation Firefinder CCA; therefore, Delco utilized the printed wire board (PWB) previously evolved and modified the board as necessary to include a dual frequency capability. The resulting CCA is 11.0 inches long by 9.5 inches wide and weighs 18 ounces.

2.3.2 SCR DRIVER CCA (A-19)

The SCR driver assembly accepts logic or drive pulses from the waveform generator and converts them to radio frequency (RF) bursts or triggers to be fed to separate isolation/converter circuits at or near the SCR's. This assembly is identical to the SCR driver assembly developed for the first Firefinder inverters. The driver CCA contains 28 identical SCR driver circuits assembled on a board which is 11.0 inches long by 9.5 inches wide. The CCA weighs 20 ounces.

2.3.3 SCR ISOLATOR CCA (P/N 7557961)

The inverter uses four SCR isolator CCA's which are called out as separate part numbers (P/N's) in the power module assemblies. They therefore do not have separate assembly numbers, nor do they appear on the assembly level family tree.

The isolator CCA's provide isolation between the low voltage SCR driver assembly and the high voltage SCR's in the power circuit assemblies. The assembly and interconnecting cable have been fully developed and will be used directly in both inverter and converter sections of the frequency changer. The assembly is 4.5 inches long by 3.5 inches wide and weighs 2.5 ounces.

2.3.4 T+, T- MODULE (A5)

The T+, T- module contains the power circuit components associated with the square wave inverter that operates at three times the system output frequency and drives the step-forming circuitry contained in the step forming module (A3). Interconnection with other system modules is achieved via a terminal strip on the top shelf of the module. The shelf also contains a four-channel SCR Isolator CCA (Para 2.3.3) which can be replaced without removing the module from a complete system. The module is 20-1/2 inches high by 7-5/8 inches deep by 4-5/8 inches wide and weighs 26-1/4 pounds including the CCA.

2.3.5 POWER CENTER MODULE (A4)

The Power Center Module contains the power circuit components associated with generating the broad center portion of the system's line-to-line output waveform. The circuit is essentially a six-SCR, three phase inverter plus the required two-SCR commutation circuit. The top shelf of the module contains an eight-channel SCR Isolation CCA and the terminal strip which provides interconnections to other modules. The module is 20-1/2 inches high by 7-5/8 inches deep by 4-5/8 inches wide and weighs 25-1/2 pounds.

2.3.6 STEPS/MAGNETICS MODULE (A3)

The Steps/Magnetics Module contains the ten SCR's required to form the ascending and descending steps in the output waveform, the six phase-selector SCR's which connect either the power center SCR's of A4 or the step SCR's to the output at the appropriate time, and the inverter magnetic components consisting of T1, T2, and L18. The module is 20-1/2 inches high by 7-5/8 inches deep by 4-5/8 inches wide (top), by 7 inches wide (bottom), and weighs 64-1/2 pounds. The weight is due to the heavy magnetic components, and future packaging effort should consider separating the magnetics of this section to provide more easily replaceable modules in terms of weight. The upper shelf of the module has two eight-channel SCR Isolator CCA's mounted back-to-back and an interconnect terminal strip.

2.3.7 OUTPUT FILTER MODULE (A2)

The Output Filter Module contains all of the inverter output filter and power factor correction capacitors, the contactor used to add capacitors when operating at 60 Hz, and the system output contactor. The complete module weighs 35-1/4 pounds. It is 20-1/2 inches high by 7-5/8 inches deep by 7 inches wide.

2.3.8 INPUT FILTER MODULE (A8)

The Input Filter Module contains added filter components required between the converter and the inverter. The filter includes several ac-capacitors necessary to filter out converter high frequency components and two inductors which provide added filtering and energy storage for transient loading. The module is 20-1/2 inches high by 4-1/4 inches wide by 15-1/4 inches deep. The weight of the module is 33-1/4 pounds. The upper section of the assembly provides space and securing means for installing an auxiliary power supply assembly (A24) which is presented in a later section of this report.

SECTION III
INVERTER/CONVERTER
INTEGRATION

3.1 DEVELOPMENT ASPECTS

The final development of the 15 kW Power Conditioner required integration of the power center inverter developed under this contract with the converter developed and tested under an earlier contract (DAAK70-77-C-0035). The integration involved development of all the support functions associated with combining and operating the two major sub-systems as a frequency changer capable of meeting the specified requirements. It also required conversion of three converter-control breadboard circuits to printed wire board form and some relatively minor modifications to converter power modules.

Figure 1 provides a family tree which includes drawing numbers and weights for all the assemblies of the power conditioner (frequency changer). The integration phase primarily involved development of the Support Functions and the resulting assemblies are treated in detail in paragraph 3.4. A brief summary of the Inverter Group assemblies is included as paragraph 3.2 and the Converter Group control circuit and power circuit modifications are presented in paragraph 3.3.

To put the entire power conditioner in perspective, a block diagram showing interconnections and primary power/signal flow is provided in Figure 2. The block diagram is arranged to depict the relative physical location of all assemblies and terminal boards. The inverter and converter power modules and terminal boards TB2 through TB5 are made accessible by removing the unit's top cover. Removing the back plate of the unit reveals all of the control circuit card assemblies and TB1. The remaining assemblies associated with sensing circuits, control panels, input/output terminals, and cooling are available via the front of the unit.

3.2 INVERTER GROUP

The assemblies of the Inverter Group were summarized in paragraph 2.3 of this report and were covered in detail in CLIN 0002 interim report R78-117, Inverter Fabrication and Assembly. That report provided schematics, parts lists, photographs, and detailed

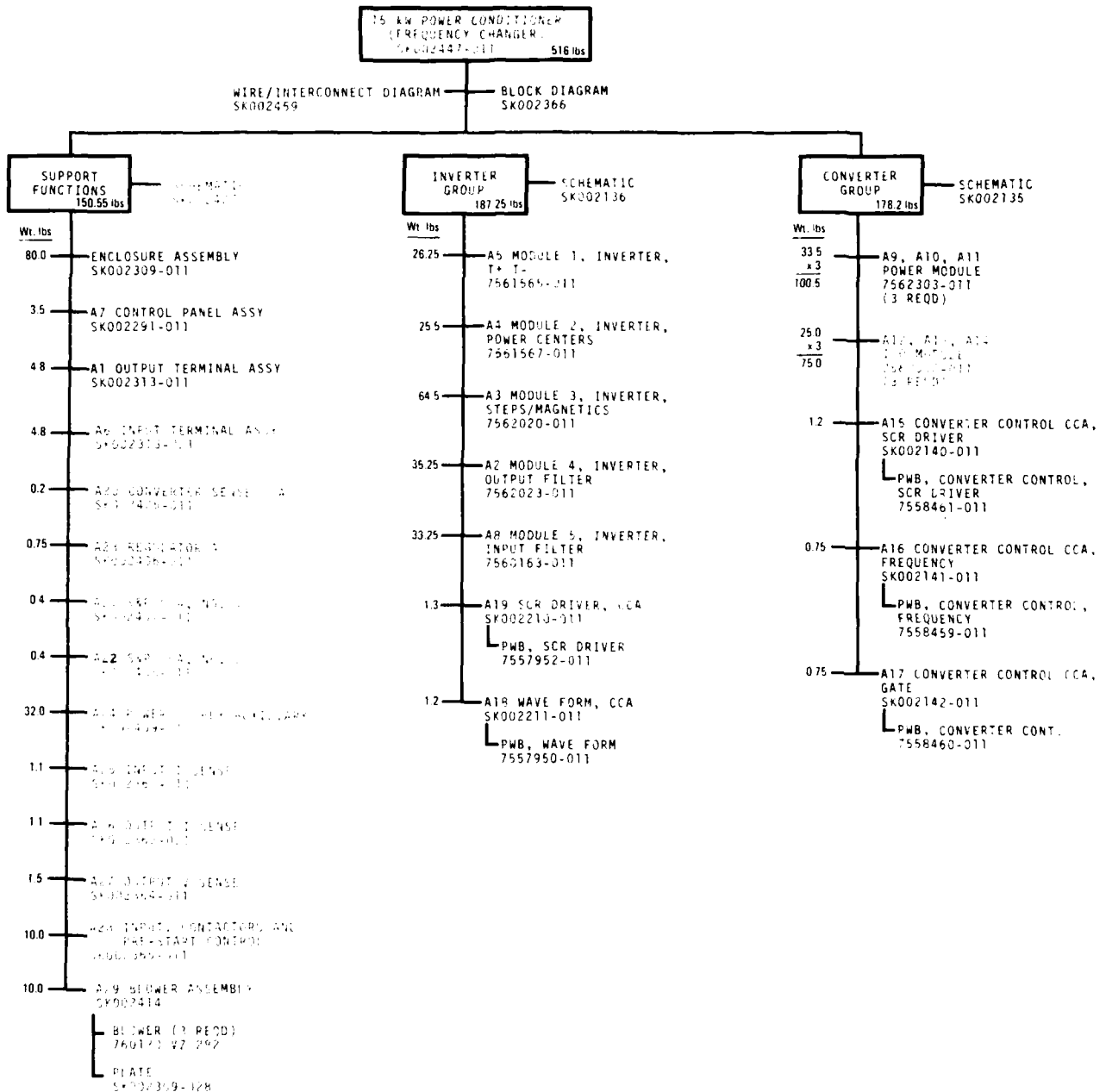
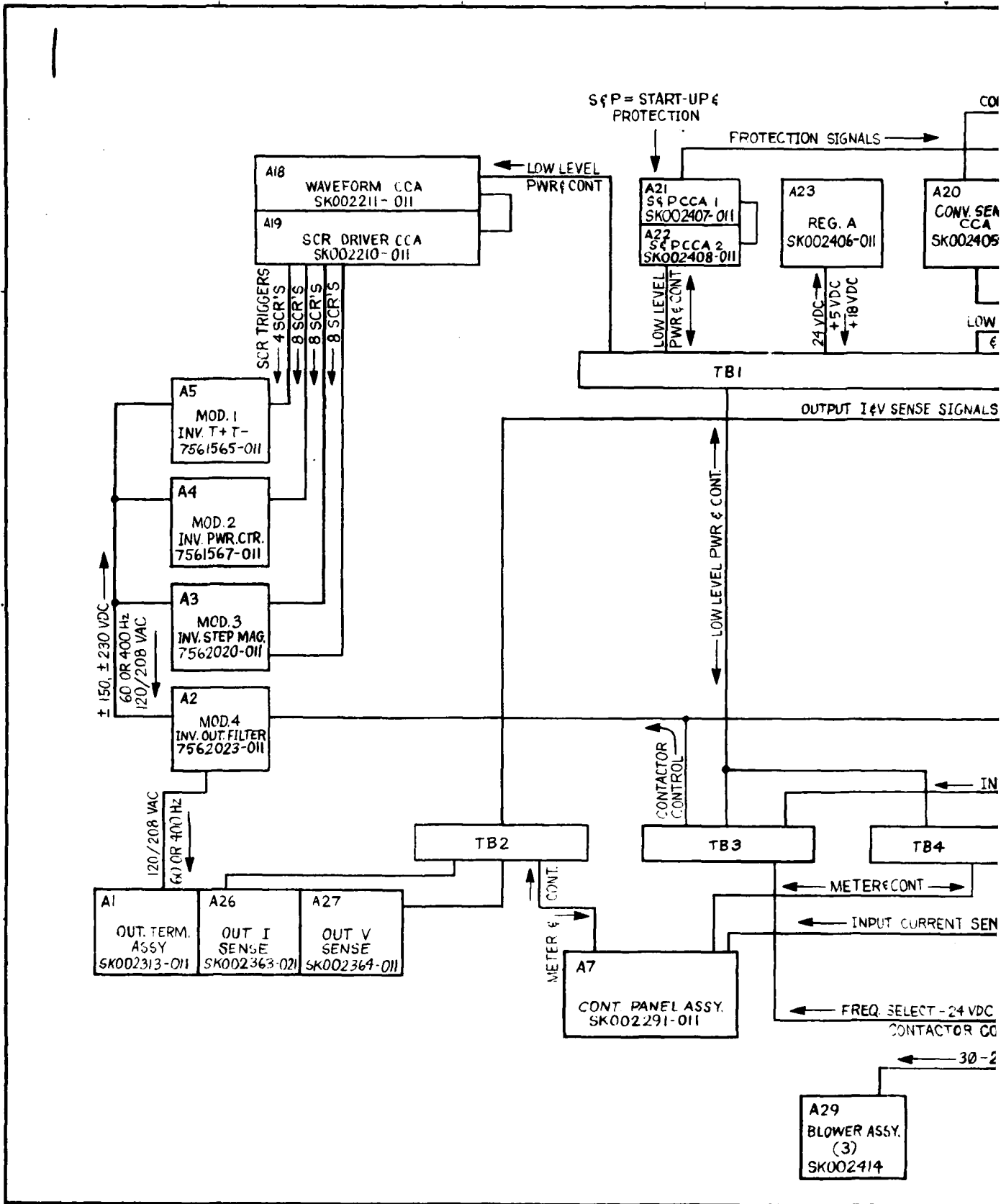
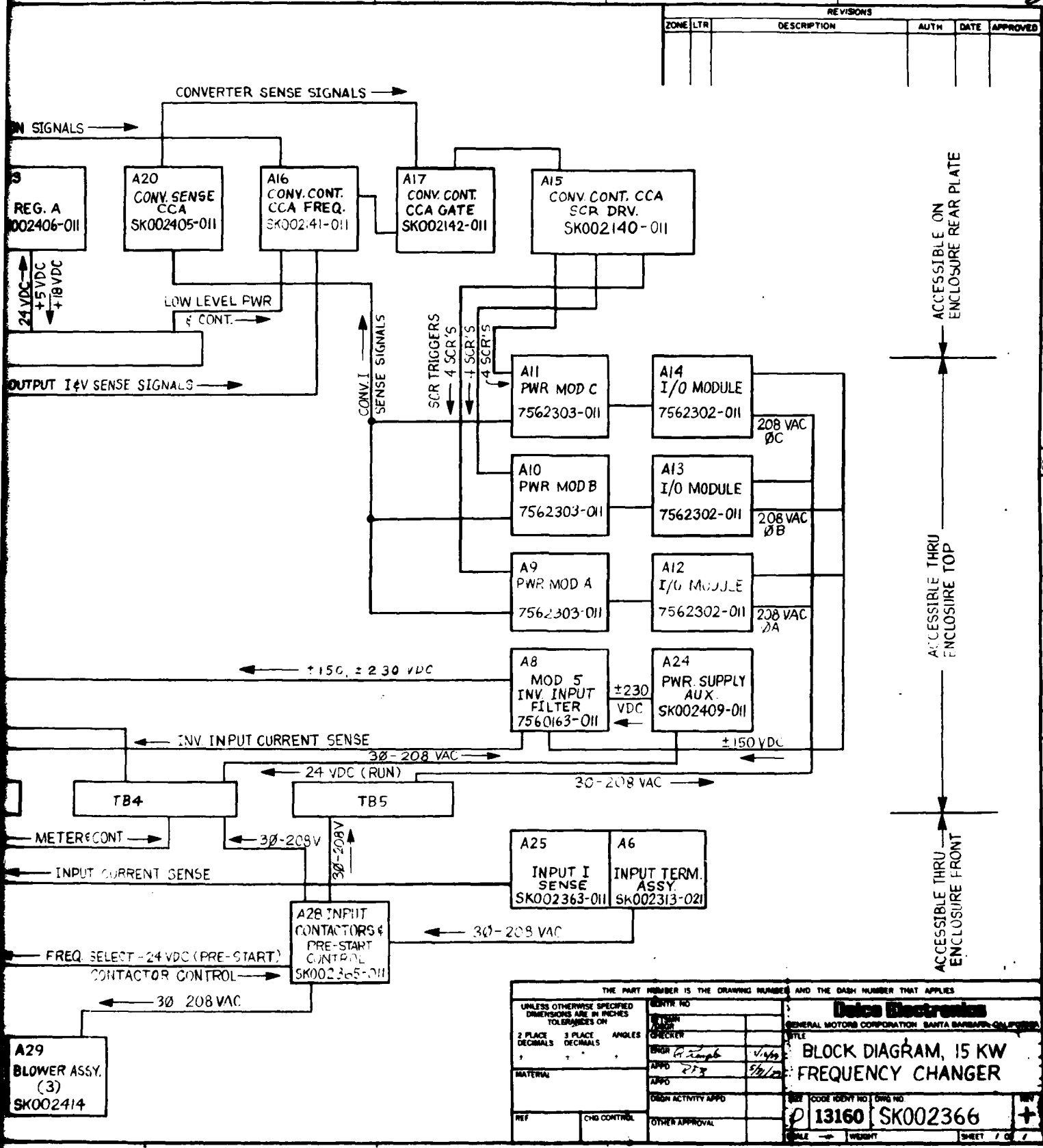

Figure 1. Family Tree, 15 kW Power Conditioner





REVISIONS					
ZONE	LTR	DESCRIPTION	AUTH	DATE	APPROVED

ACCESSIBLE ON ENCLOSURE REAR PLATE

ACCESSIBLE THRU ENCLOSURE TOP

ACCESSIBLE THRU ENCLOSURE FRONT

UNLESS OTHERWISE SPECIFIED DIMENSIONS ARE IN INCHES TOLERANCES ON		DRAWN BY		DATE		APPROVED	
2 PLACE DECIMALS	3 PLACE DECIMALS	ANGLES					
MATERIAL		ENGR. <i>G. Sample</i>		DATE <i>11/1/88</i>		APPR. <i>SK/2</i>	
REF	CHG CONTROL	OTHER APPROVAL		DASH ACTIVITY APPD			
THE PART NUMBER IS THE DRAWING NUMBER AND THE DASH NUMBER THAT APPLIES				Delco Electronics GENERAL MOTORS CORPORATION SANTA BARBARA, CALIFORNIA			
TITLE				BLOCK DIAGRAM, 15 KW FREQUENCY CHANGER			
SEE CODE IDENT NO		DRAW NO		REV			
13160		SK002366		+			
SCALE		WEIGHT		SHEET		1 OF 2	

Figure 2. Block Diagram, 15kW Frequency Changer 10

descriptions of all modules and CCA's. The content of that report remains valid. The only change made during the integration effort was to assign assembly numbers as reflected in the family tree of Figure 1. For clarification Figure 3 is provided which shows the newly assigned power assembly numbers and their interconnects.

3.3 CONVERTER GROUP

The assemblies of the Converter Group were covered in detail in final report R78-38 of contract DAAK70-77-C-0035, dated April 1978. The report provided schematics, parts lists, and descriptions of all modules and control circuit breadboards, all of which essentially remain unchanged. The control circuits have been converted from breadboards to printed wire board format and the power modules modified slightly to remove fuses. The resulting assemblies are presented in paragraphs 3.3.1 and 3.3.2 below.

3.3.1 CONTROL CIRCUIT CCA'S

The breadboard control circuits developed previously were converted to printed wire board format under the integration effort and designated as assemblies A15, A16, and A17. Figure 4 shows the location of the various CCA's in the completed power conditioner unit. The view is of the enclosure with the top cover and back plate removed.

Assembly A15 is the SCR Driver Control CCA. Descriptive and schematic information for the CCA was provided in paragraph 6.5 of R78-38. The finished CCA is 11.0 inches long by 6.7 inches wide and weighs 18 ounces.

Assembly A16 is the Converter Frequency Control CCA. Descriptive and schematic information for the CCA was provided in paragraph 6.3 of R78-38. The finished CCA is 11.0 inches long by 5.7 inches wide and weighs 12 ounces.

Assembly A17 is the Converter Gate Control CCA. Descriptive and schematic information for the CCA was provided in paragraph 6.4 of R78-38. The finished CCA is 11.0 inches long by 6.7 inches wide and weighs 12 ounces.

The remaining CCA assemblies of Figure 4 are discussed in paragraph 3.4 of this report, except for A18 and A19. CCA's A18 and A19 were previously presented in R78-117 and resulted from the CLIN 0002, Inverter Fabrication and Assembly, effort of the present contract.

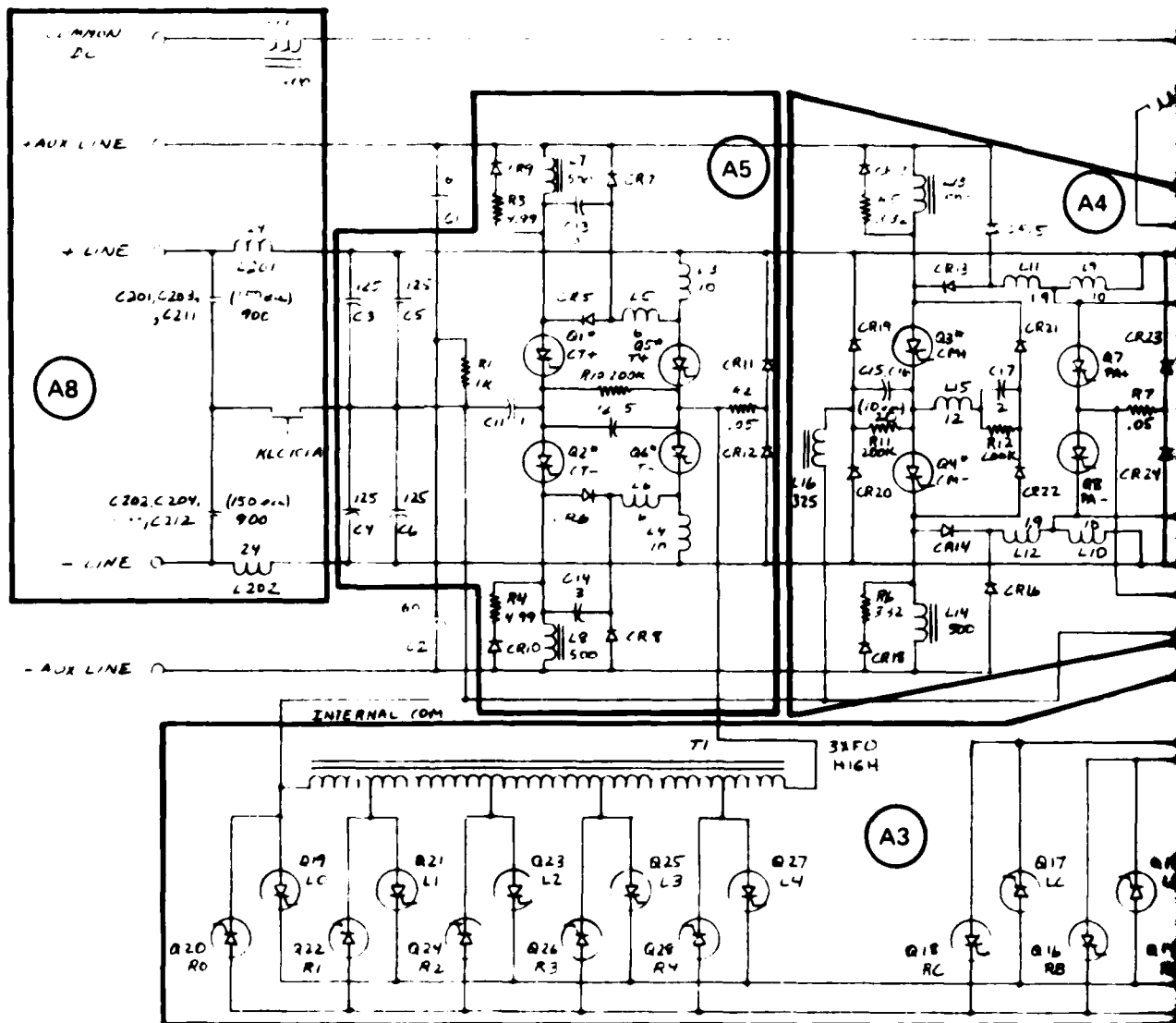

NOTE Ass'y. No. 4 also contains C₁ & C₂
 Ass'y. No. 3 includes T₂

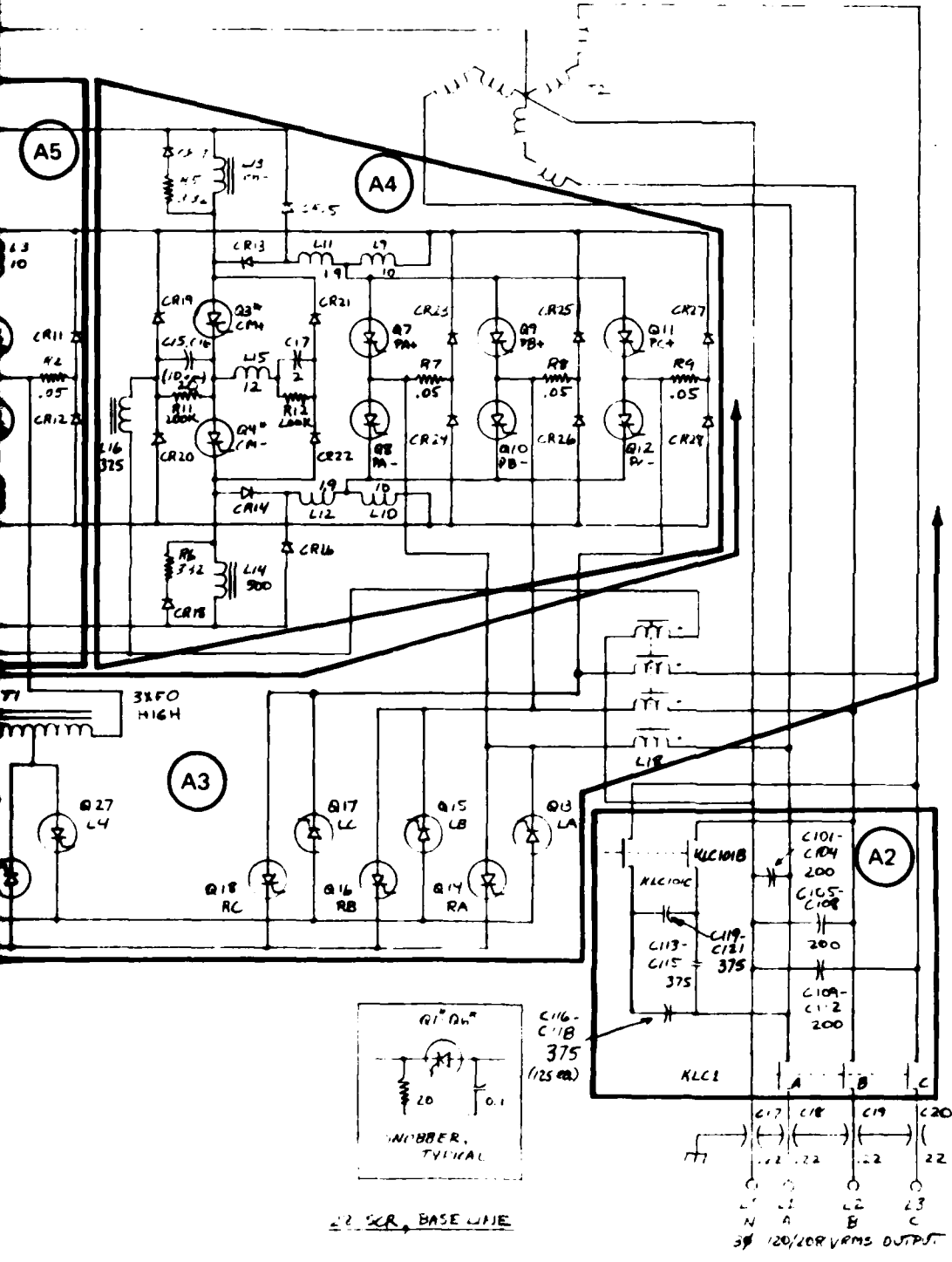

Figure 3. Inverter Power Supply

3

Figure 3. Inverter Power Assembly Divisions

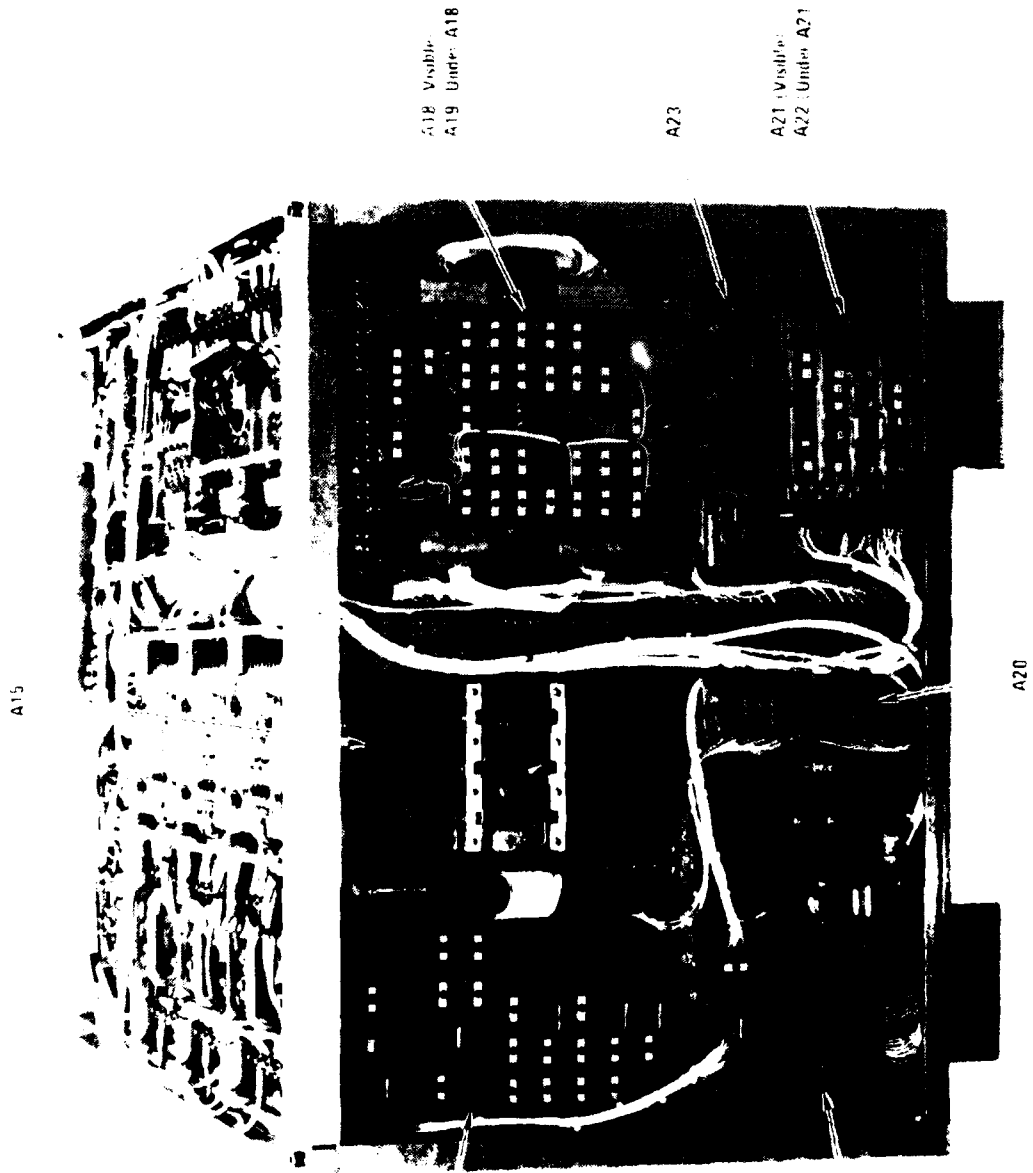

Figure 4. Power Conditioner CCA's

3.3.2 CONVERTER POWER MODULES

The converter power modules were presented in R78-38. Only minor deletions and completion alterations were made since that report. Figure 5 provides the power circuit schematic for the converter and also shows the portions of the circuit packaged in identical assemblies A9, 10, and 11, as well as identical assemblies A12, 13, and 14.

The A9, 10, and 11 assemblies are referred to as resonant converter modules. Each of these modules contains SCR's, diodes, snubber components, and passive resonant circuit components as well as the high frequency isolation transformers and output full wave bridge rectifiers. Figure 6 shows the final packaging of the resonant converter modules. The assembly is very similar to that previously reported in R78-38, except that the high frequency transformer has now been potted and mounted on a heatsink (bottom Figure 6) and handles have been added to the module to facilitate removal.

Figure 7 shows an input/output converter module (A12, 13, or 14) which contains the input LC filter components and rectifiers and the converter output filter capacitors. The module is similar to that reported in R78-38, except that a 100-ampere fuse has been deleted from the top shelf, lifting handles have been added, and the electrolytic capacitors were added on a lower shelf.

The overall outside dimensions of the two types of assemblies are the same: 5.5 inches wide, 7.5 inches deep, and 20.5 inches high. The A9, 10, or 11 assemblies weigh 25 pounds each.

3.4 SUPPORT FUNCTIONS

The primary effort during CLIN 0003, Inverter/Converter Integration, was directed to development of all of the support functions as shown by the separate assembly items under that category in Figure 1 of paragraph 3.1. Several of the newly developed assemblies relate to the system input/output (I. O.) circuits and power supplies. These functions are discussed in paragraph 3.4.1. Paragraph 3.4.2 covers the new control circuit card assemblies developed during the integration, and paragraph 3.4.3 discusses the enclosure development, including the control panel and blower assemblies. Weights for all assemblies were included in Figure 1 of paragraph 3.1.

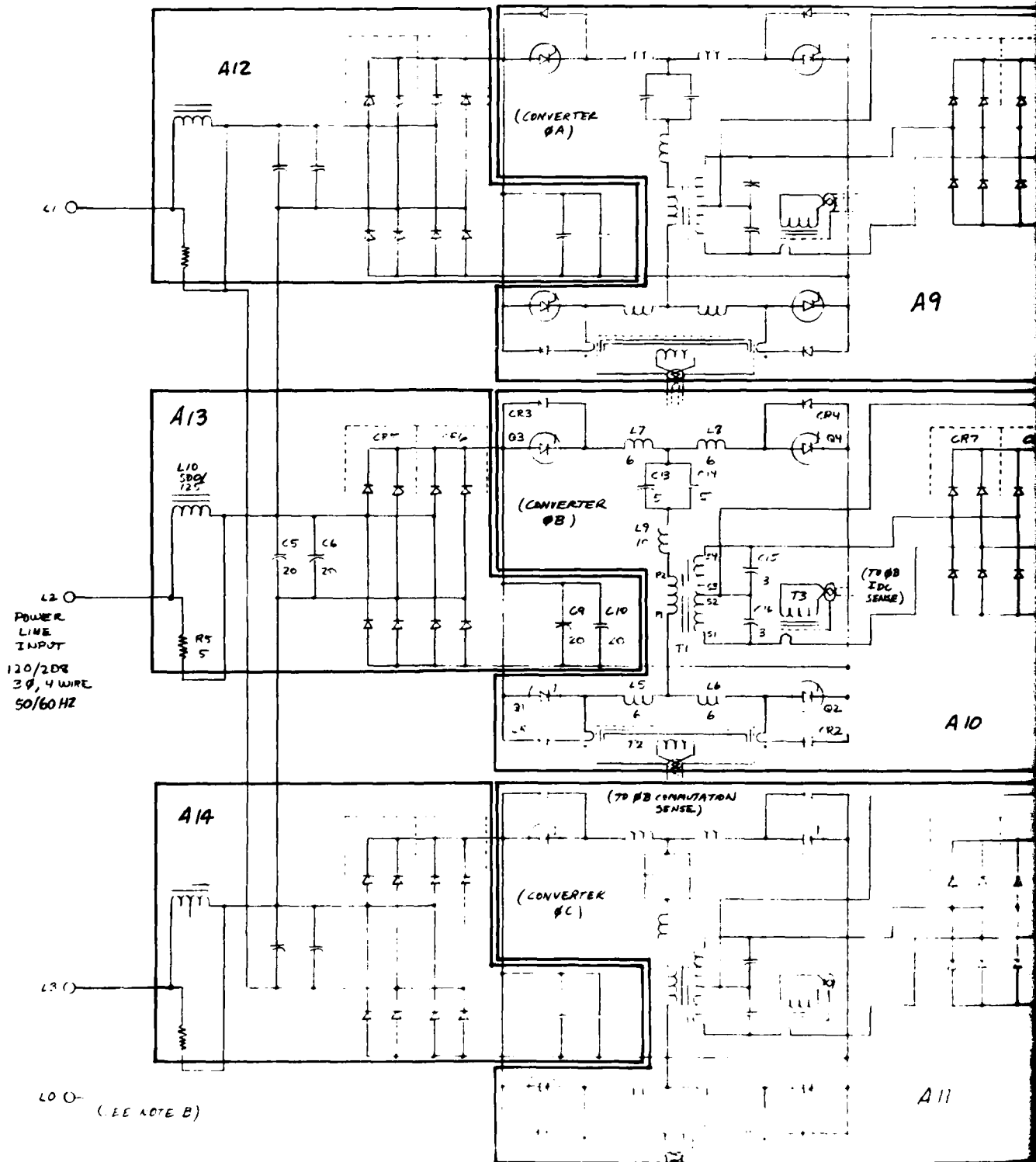

2 1

GENERAL MOTORS CORPORATION

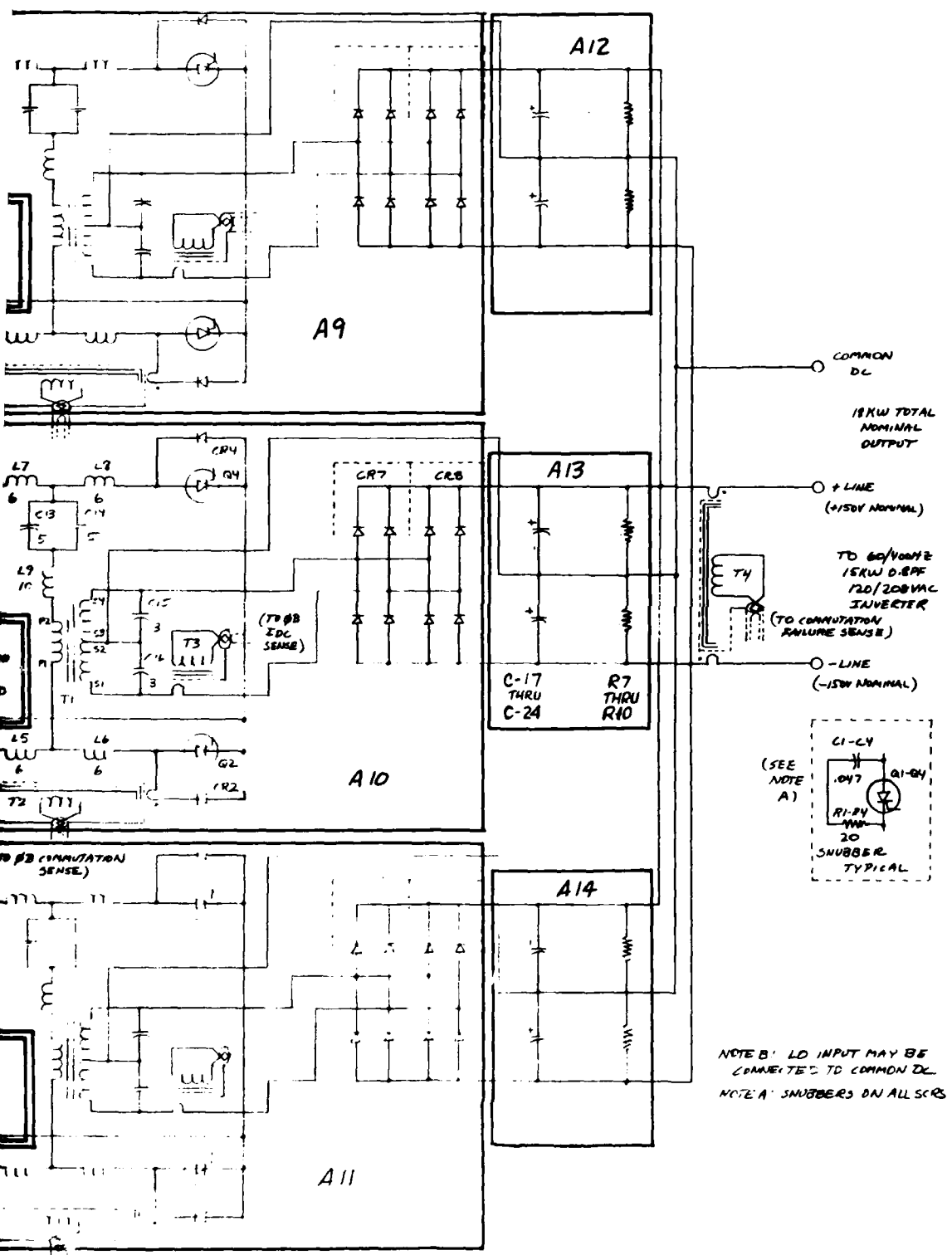

NOTE B: LD INPUT MAY BE CONNECTED TO COMMON DC
 NOTE A: SNUBBERS ON ALL SCRS

Figure 5. Three Phase Power

3

TOTAL
MILL
WATT

WATT)

WATT
0.8PF
0.001VAC
METER

WATT)

WATT)

WATT)

MAY BE
FROM DC
IN ALL SCRS

Figure 5. Three-Phase Converter
Power Assembly Division

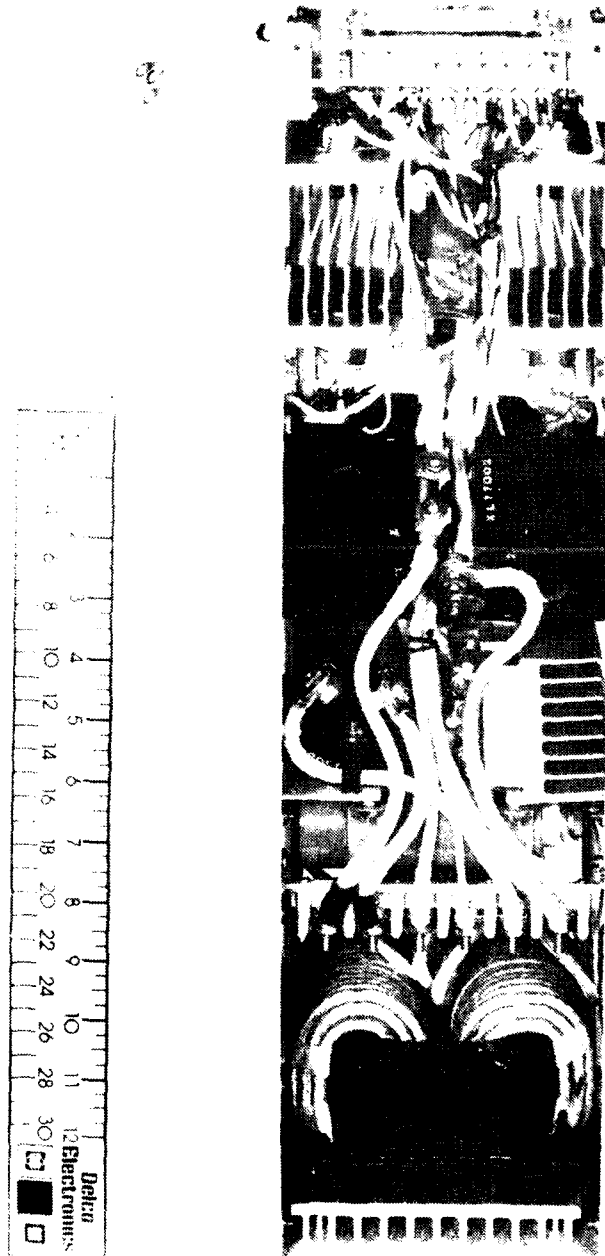

Figure 6. Resonant Converter Assembly

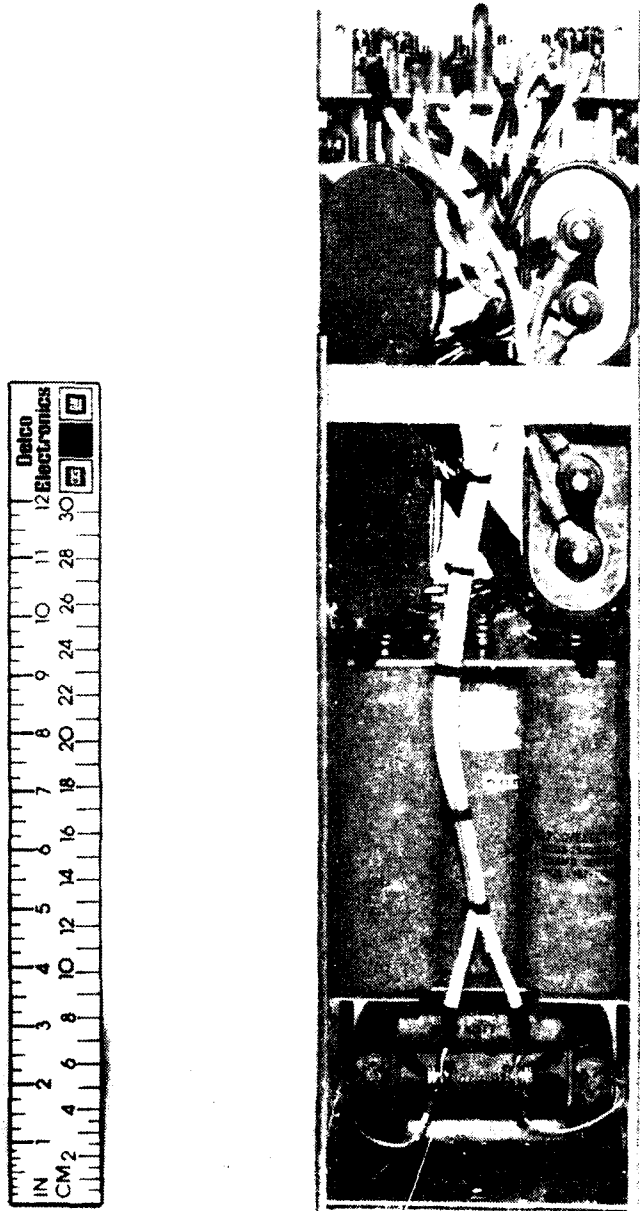

Figure 7. Input/Output Assembly

3.4.1 I. O. CIRCUITS AND POWER SUPPLIES

The relationship between the power conditioner input/output circuits, power supplies, and the inverter/converter assemblies is shown in Figure 8. The output and input terminal assemblies (A1 and A6, respectively) are identical. They contain the Army-specified split-lug connectors and the 100-ampere coaxial capacitors (C1 through C4) which reduce conducted emission currents in the output leads. The terminals are accessible via spring-return, hinged doors at the lower right and left front of the enclosure. (See paragraph 3.4.3.) A parts list for the Terminal Assemblies is included in the appendix to this report.

Just inside the terminal assemblies and physically mounted on top of them are found the input (A25) and output (A26) current sense assemblies. The assemblies contain one-turn-primary current transformers mounted on each of the voltage lines L1, L2, & L3. The many-turn secondary windings of each current transformer feed diode rectifier circuits mounted on the same board as the current transformers. The dc signals thus generated are fed to control or metering circuits as required. A wiring diagram and parts list for the current sense assemblies is included in the appendix to this report.

The output voltage sense assembly (A27) monitors the line-to-neutral voltages out of the inverter prior to the output contactor KLC1. The assembly uses small transformers in each inverter output phase, followed by diode rectifier circuits which are wired into the system control circuits. A wiring diagram and parts list for the assembly is included in the appendix.

Assembly A28, Input Contactor and Pre-Start Control, contains a 100-ampere circuit breaker (CB1) and the system's input contactor (KLC2) in the main power input lines to the converter/inverter. Low level circuit breakers (CB2, 3 and 4) provide protection for the control circuits in the system. The assembly also contains a 3-phase transformer rectifier power supply which provides 24 Vdc to all pre-start functions such as control panel illumination, malfunction, and status lamps. The 24 Vdc pre-start voltage supply is operational for all positions of the "master switch" including the "off" position. The A28 assembly also includes the system's three-position frequency select switch. The specification requires that the system provide only the 60 Hz and 400 Hz outputs. Delco has, however, included the third 50 Hz frequency for demonstration purposes and possible

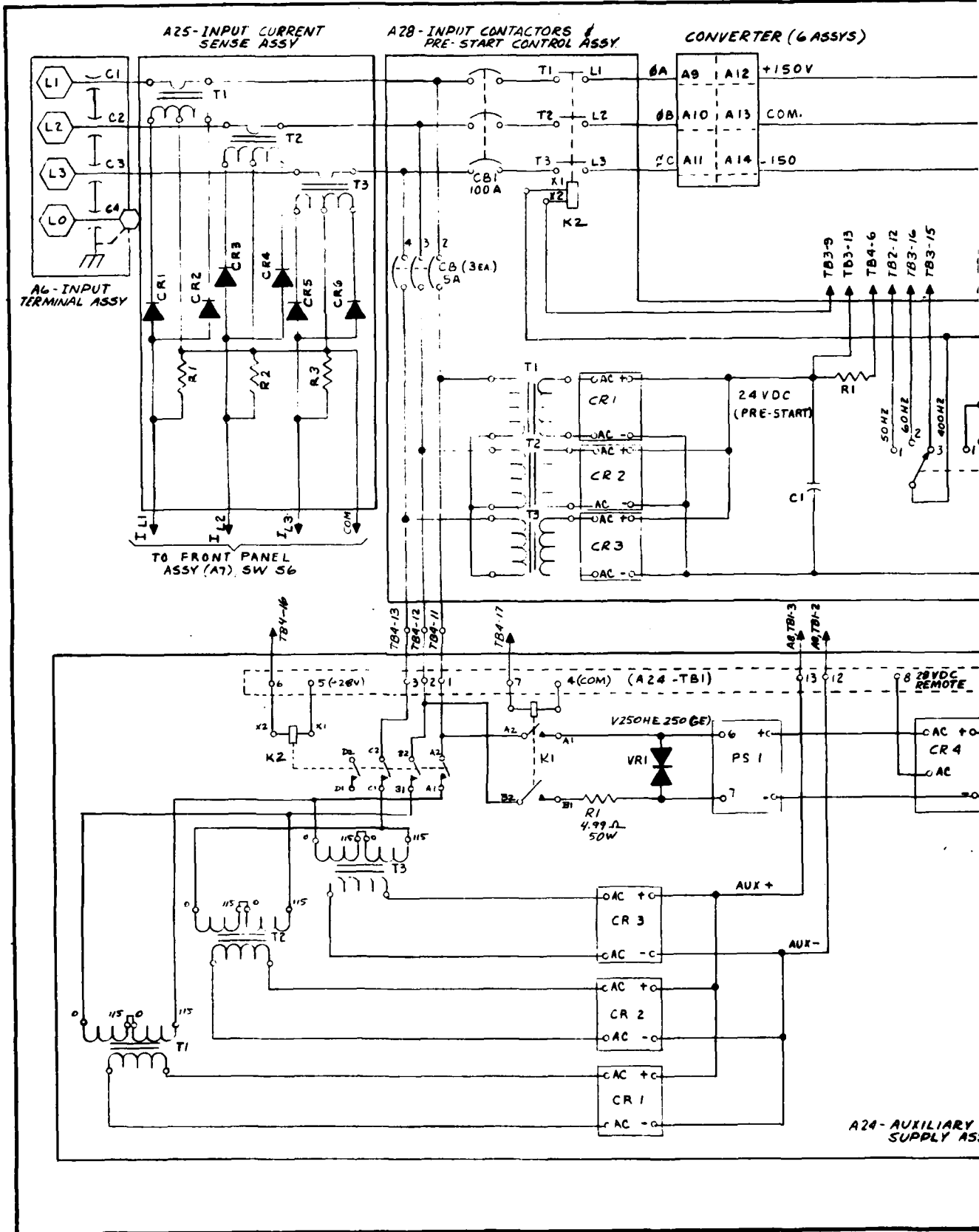

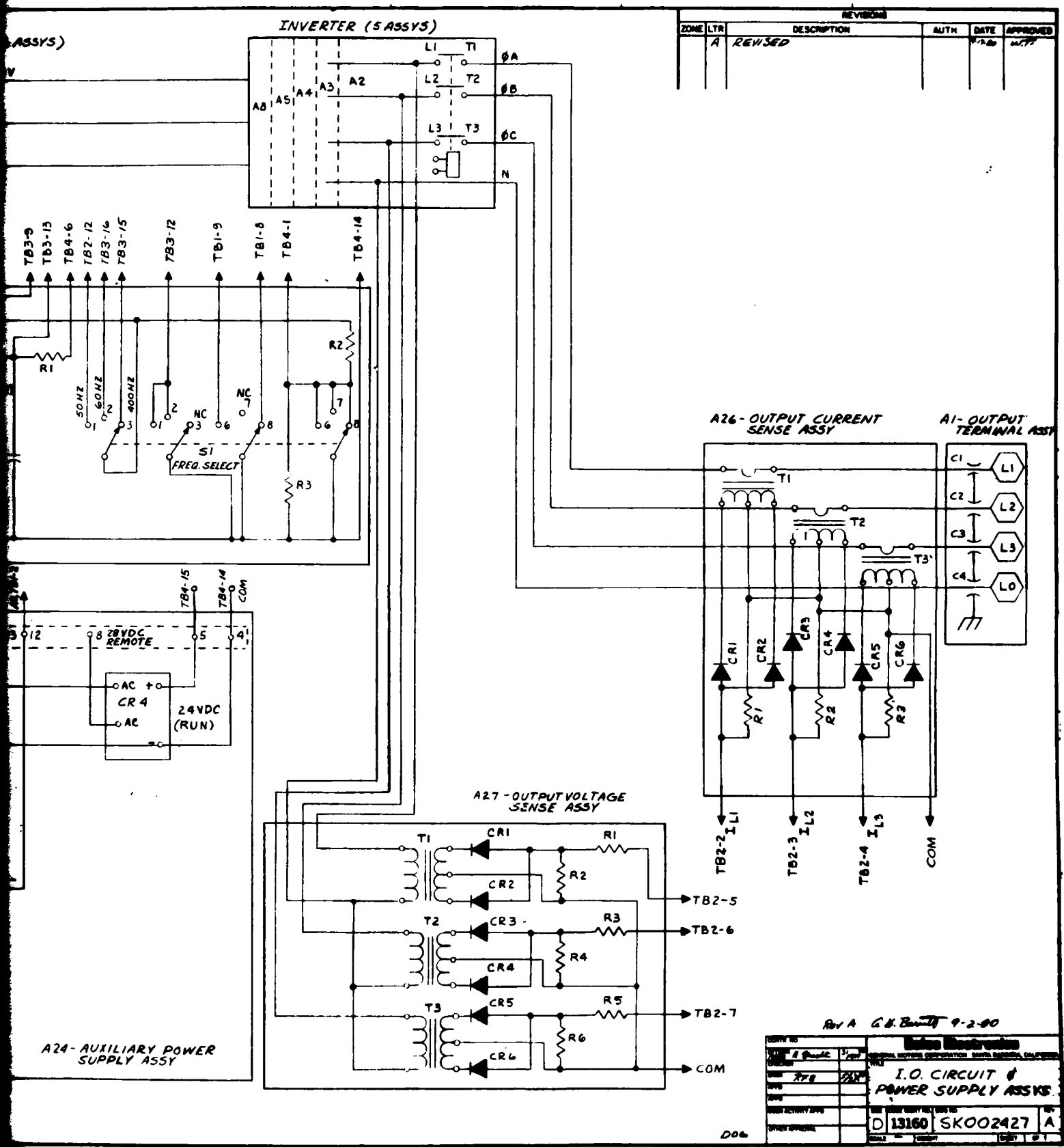

REVISIONS					
ZONE	LTR	DESCRIPTION	AUTH	DATE	APPROVED
	A	REVISED		9-2-80	MTP

Rev A G.B. Bennett 9-2-80

DATE		DRAWN		CHECKED	
DATE	BY	DATE	BY	DATE	BY
<p style="text-align: center;">Radio Electronics</p> <p style="text-align: center;">I.O. CIRCUIT & POWER SUPPLY ASSYS</p>					
PART NUMBER		REV		MFG	
D 13160		SK002427		A	

Figure 8. Input/Output Circuit and Power Supply Assemblies

consideration for future system inclusion. The ten-pound assembly has its components mounted on a 7.25 inch by 7.25 inch epoxy board. It is located at the front of the unit (see paragraph 3.4.3) below the control panel. A plexiglass cover with screw fasteners allows the operator to determine visually the status of the infrequently used circuit breakers and frequency select switch. A parts list for the assembly is provided in the appendix.

The schematic provided as Figure 8 includes a functional diagram of the A24 Auxiliary Power Supply Assembly. The auxiliary supplies become operational when the master switch is placed in the "Start" position. PS1 shown in Figure 8 is a commercially available 24 Vdc supply which operates from one phase of the input line and powers all of the low voltage control circuits in the system. In a final design phase for the power conditioner, this supply should be sized to better match the system, converted to a 3-phase input design, and possibly combined with the pre-start supply of the A28 assembly. A24 also includes a 3-phase input auxiliary supply which provides 350 Vdc for commutation of inverter SCR's when operating in a current-limiting mode. Figure 9 shows the packaged assembly with the front panel removed. Transformers T1, 2 and 3 and associated rectifiers are in the upper half of the assembly. The lower section contains the 24 Vdc commercial supply. The assembly is 4.25 inches wide, 10.4 inches high, 11.0 inches long, and weighs 32 pounds. In the unit it is physically mounted on top of A8, Inverter Input Filter, shown in Figure 14 of R78-117. A parts list is included in the appendix.

3.4.2 CONTROL CIRCUIT ASSEMBLIES

During the integration phase, four additional control circuit assemblies were developed. The physical location of the control circuits, A20, 21, 22, and 23, are shown in Figure 4, paragraph 3.3.4, and parts lists are provided in the appendix. The four CCA's have not been reduced to printed circuit board format due to the highly developmental nature of sensing and control for power conditioners.

Assembly A20, Figure 10, is the Converter Sense CCA which provides the control signals for proper operation of the converter. Transformers T2 and 3 of the schematic are located in the converter power modules A9, 10 and 11. (See Figure 5, paragraph 3.3.2.) Diode clamps are used to limit the output voltage of the commutation sense

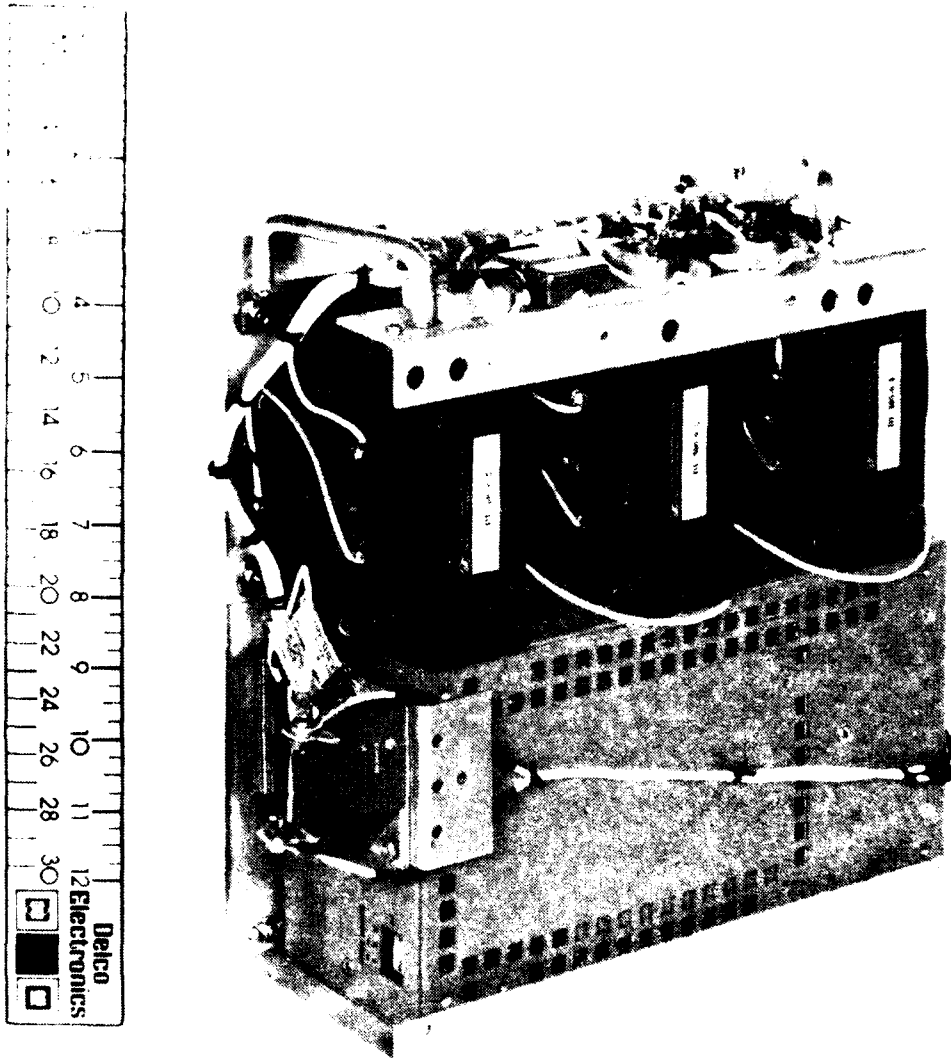
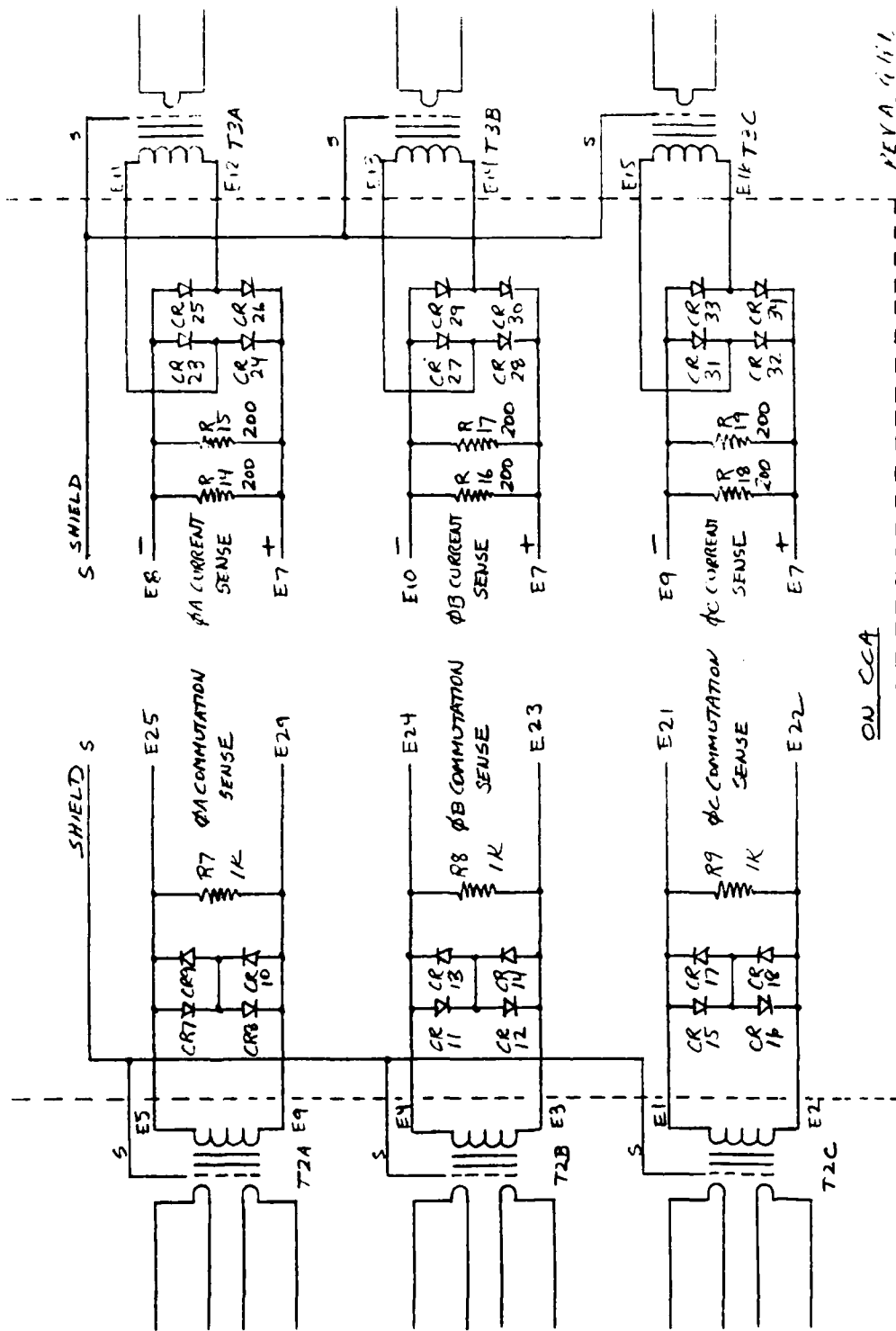

Figure 9. Auxiliary Power Supply Assembly A24



SIZE	CODE IDENT NO.	DWG NO.	REV
A	13160	SK 002405	A
SCALE		SHEET 3 of 7	

ON CCA
 Converter Sense CCA

Figure 10, A20, Converter Sense CCA

transformers T2 A, B, and C. Their outputs are fed to comparators located on the converter gate control assembly A17 which sense the conduction duration of converter power module diodes and thus, SCR reverse bias time. Transformer T3, A, B, and C outputs are rectified to provide dc signals proportional to transformer primary current to A17 and are thus used as converter dc current output control signals. The assembly is 6 inches long, 2.25 inches wide, and weighs 3 ounces.

Figures 11 and 12 provide schematic diagrams of the circuitry necessary to provide the startup and protection functions for the frequency changer. Parts lists for the CCA's are included in the appendix. The CCA's (A21 and A22) are a pair of small circuit cards whose combined functions are broadly described as startup and protection. Each CCA is 6.25 inches long, 4.5 inches wide, and weighs 6 ounces. They are both low level cards which contain CMOS digital logic, operational amplifiers (some used as comparators), and relay and lamp drivers.

Input voltage to the frequency changer is sensed from the output of the prestart power supply on A28. Undervoltage (UV) is detected by the comparator A21 U7-1, 2, 3. The threshold is set by A21 R6 (nominally 98 Vrms). Overvoltage (OV) is detected by the comparator A21 U7-5, 6, 7. The threshold is set by A21 R5 (nominally 134 Vrms). Inverted malfunction signals \overline{UV} and \overline{OV} leave A21 and are fed to CCA A22.

An output short circuit (SC) condition is detected by A21 U7-8, 9, 10 and U7-12, 13, 14. A short circuit is detected when high output current and low output voltage with thresholds set by A21 R4 and R3, respectively, exist concurrently. The malfunction signal SC leaves A21 and is taken to A22.

Three protective features are also incorporated on A21. The first of these is sustained overload protection for the auxiliary commutation power supply. This is accomplished by using A21 U12-1, 2, 3 to detect low output voltage of the frequency changer with a threshold set by R2. The negative slope integrator using A21 U8-5, 6 is implemented such that the protective relay for this supply, A24 K2, pulls in instantaneously when the set output goes high but drops out 6 seconds after it goes low. The relay is driven by A22.

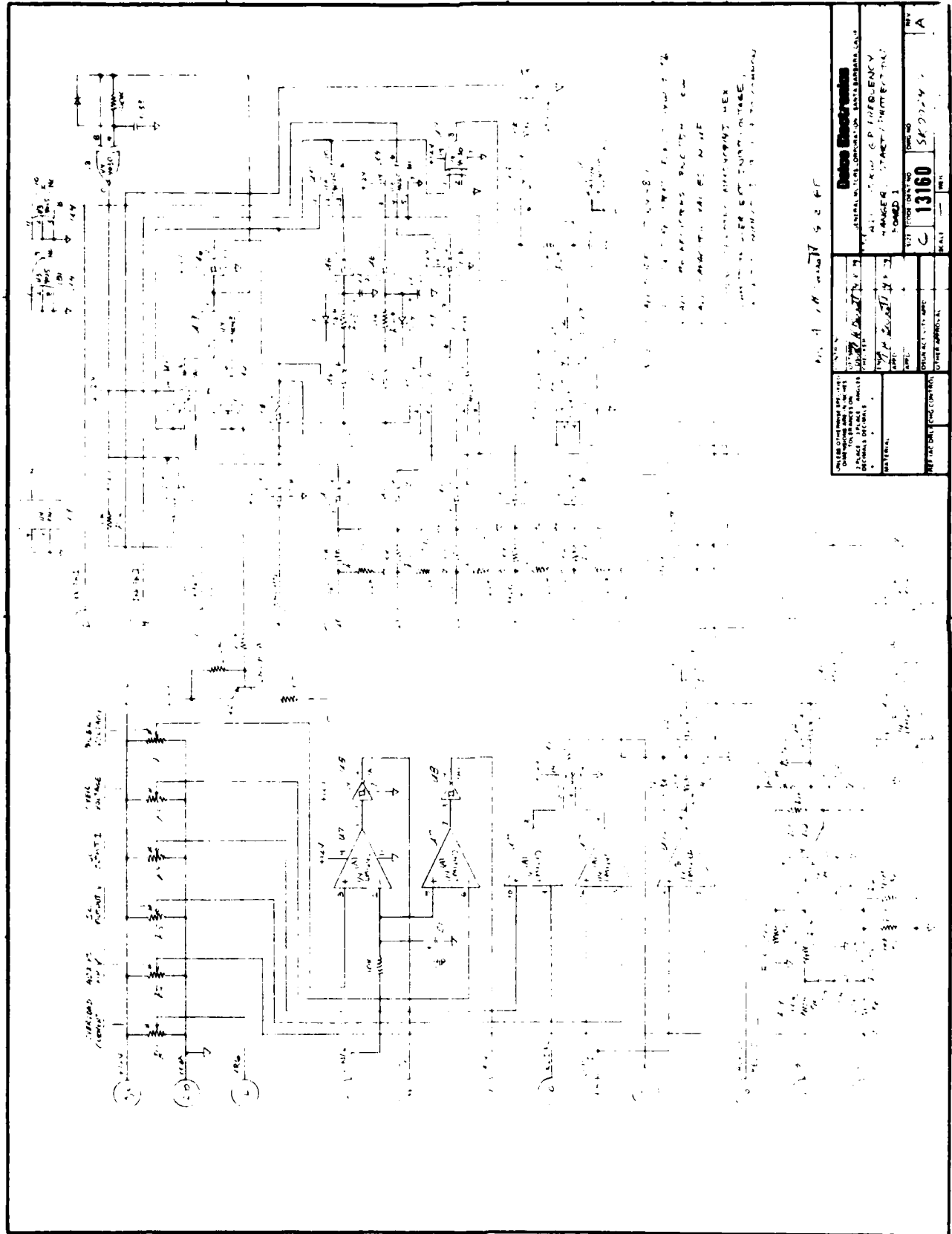

TITLE: START/PROTECT CCA NO. 1 DRAWN BY: [Signature] CHECKED BY: [Signature]		DATE: 11/17/52	
PROJECT: [Blank]		DRAWING NO.: 13160	
SHEET NO.: 1		TOTAL SHEETS: 1	
APPROVED BY: [Signature]		DESIGNED BY: [Signature]	
ORGANIZATION: [Blank]		PROJECT: [Blank]	
DRAWING NO.: 13160		SHEET NO.: 1	
TOTAL SHEETS: 1		PROJECT: [Blank]	

Figure 11. A-21, Start/Protect CCA No. 1

The second protective feature is overcurrent detection with set shutdown when the output current of the main 24 Vdc power supply is too high. This overcurrent is sensed by A21 U12-1, 2, 3.

The third protective feature is instantaneous shutdown should the operator attempt to change output frequency with the frequency changer operating. A21 U1-10, 11 is used to condition the frequency change signal from the frequency select switch A28 S1.

The remaining circuitry on A21 is used to accomplish an orderly startup and shutdown of the frequency changer. A21 U1-3, 4 and A21 U5-3, 4, 5, 6 are used to set the input contactor latch U9-10, 11, 12 when the MASTER switch is placed in START. The positive slope delay, A21 U6-5, 6 and U6-8, 9, causes about a 2-second delay in the closing of this contactor. The positive slope delay, A21 U6-10, 11 and U6-12, 13, makes it impossible to close the output contactor until at least 2 seconds after the input contactor has been closed. A21 U1-5, 6 and U5-1, 2, 8, 9 are used to set the output contactor latch U9-6, 7, 9 when the output CONTACTOR switch is placed in the "Closed" position.

The input and output contactor latches may be set in either sequence as orderly startup is accomplished with the two positive slope delays.

Seven relay/lamp drivers are located on CCA A22. U2 is a driver for the input contactor A28 KLC2. U3 is a driver for the output contactor A2 KLC1 and the output contactor lamp located on the front panel. U4 is the auxiliary commutation power supply protective relay, A24 K2, driver. U5, U6, U7, and U8 are drivers for the "Overvoltage", "Undervoltage", "Short Circuit", and "Overload Malfunction" lamps, respectively.

A22 U9 and U14 function as an inverse time overload trip circuit. A voltage proportioned to the output current of the set is brought in at R12. This voltage is compared by U9-8, 9, 10 with an overload reference voltage VR6 from A21. If any output phase has a current of greater than 57A rms, then this comparator, through a 0.5 second delay and U12-1, 2, start the inverse time timeout. If current is greater than 57 A rms, but less than 78 A rms, 30 seconds is timed out. For currents greater than 78 Arms, but less than 110 Arms, time out is an inverse relationship, decreasing to a minimum of 9 seconds for currents greater than 110A rms.

U11-1, 14, 15 is the overload lamp latch and is set by the inverse time circuit. The overload lamp is also driven for a 5-second interval by detection of a transient overload of the regulator on CCA A1, a commutation failure of the inverter, a sustained inverter lockup, or a short shutoff detection from the converter.

U11-10, 11, 12 is the short circuit lamp latch and is set by U10-8, 9 and U10-10, 11 0.5 seconds after a short circuit is detected.

Any of the four malfunction lamp latches causes an immediate shutdown of the frequency changer by action of the OR gate U16-1, 2, 3, 4, 5 driving the shutdown circuitry on A21.

Both A21 and A22 are powered by a single +12V power supply located on A22. A22 U1 is a +12V regulator for this supply.

The circuit card assemblies (CCA's) developed during the integration phase of the program incorporate "on-board" regulators which convert the 24 Vdc from the power supply assembly, A24, to the low voltages required by the control circuits. However, CCA's A18 and A19 associated with the inverter control were developed under previous programs and do not contain on-board regulators. Figure 13 provides the schematic diagram for the A23, Regulator A, assembly which serves this function. The circuit uses standard regulator components to provide the required +18 Vdc and +5 Vdc. The circuit provides for an overcurrent signal to the startup and protection CCA, A21. The regulator assembly is 9.5 inches long, 2 inches wide, and weighs 12 ounces. A parts list for the assembly is provided in the appendix.

3.4.3 ENCLOSURE DEVELOPMENT

During the integration phase of the program the conceptual enclosure design reported in R78-117 was fully developed. Detail drawings of all parts and pieces were generated, released for fabrication and assembled into the final enclosure shown in Figure 14. The aluminum enclosure is built up from a 0.190-inch bottom plate which sets on two 2-inch by 5-inch channels designed to accept standard for lifts. Side posts and cross members are made from 1-inch by 2-inch tubing with 1-inch square tubing used for bracing. The side plates are made of 0.060 aluminum with venting louvers appropriately spaced. The

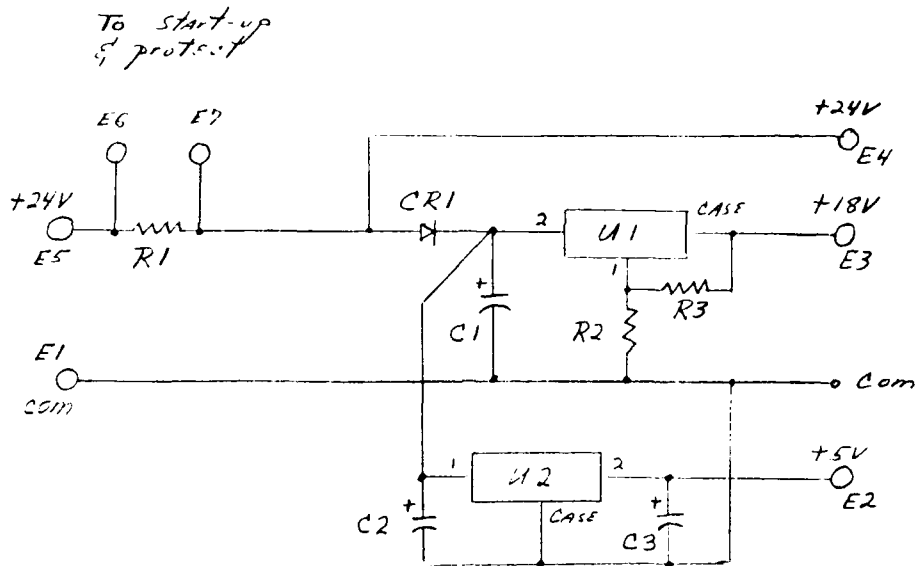

Voltage Regulator

Figure 13. A23, Regulator A

cover is made of 0.090-inch aluminum reinforced with 0.060-inch x 0.5-inch angle stock along all edges. The cover overlaps the sides of the enclosure and is held down by spring clips which compress a captive gasket mounted around the perimeter of the cover. Lifting eyebolts are provided at the four upper corners of the enclosure. It should be noted that spreaders must be used when attempting to lift the 516-pound unit with a sling attached to the eyebolts.

Access to the input and output split-lug terminals is provided at the lower front corners of the enclosure via spring return, fiberglass doors. Cooling air enters the unit through an EMI-shielded air filter which extends from the top to the bottom of the unit. The blower assembly, A29, (parts list in appendix) is behind the filter.

Details of the control panel, are shown in Figure 15 and a parts list is provided in the appendix. Per the Purchase Description the control panel is provided with indicator lights for 60 Hz and 400 Hz operating modes only. As mentioned previously the frequency select switch has a third, 50 Hz, position and the unit can be operated at 50 Hz with reduced voltage outputs.

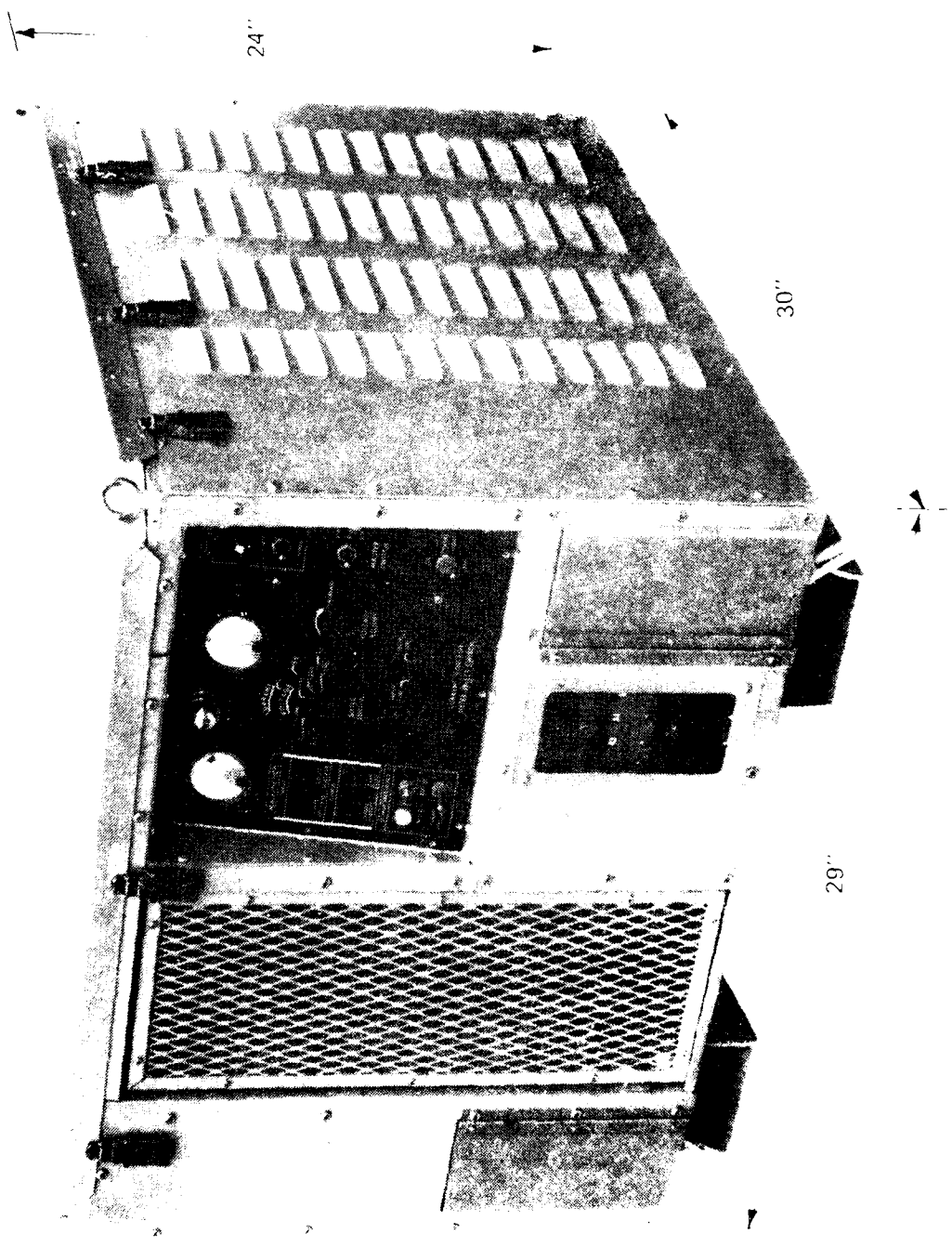

Figure 14. 15 kW Frequency Changer

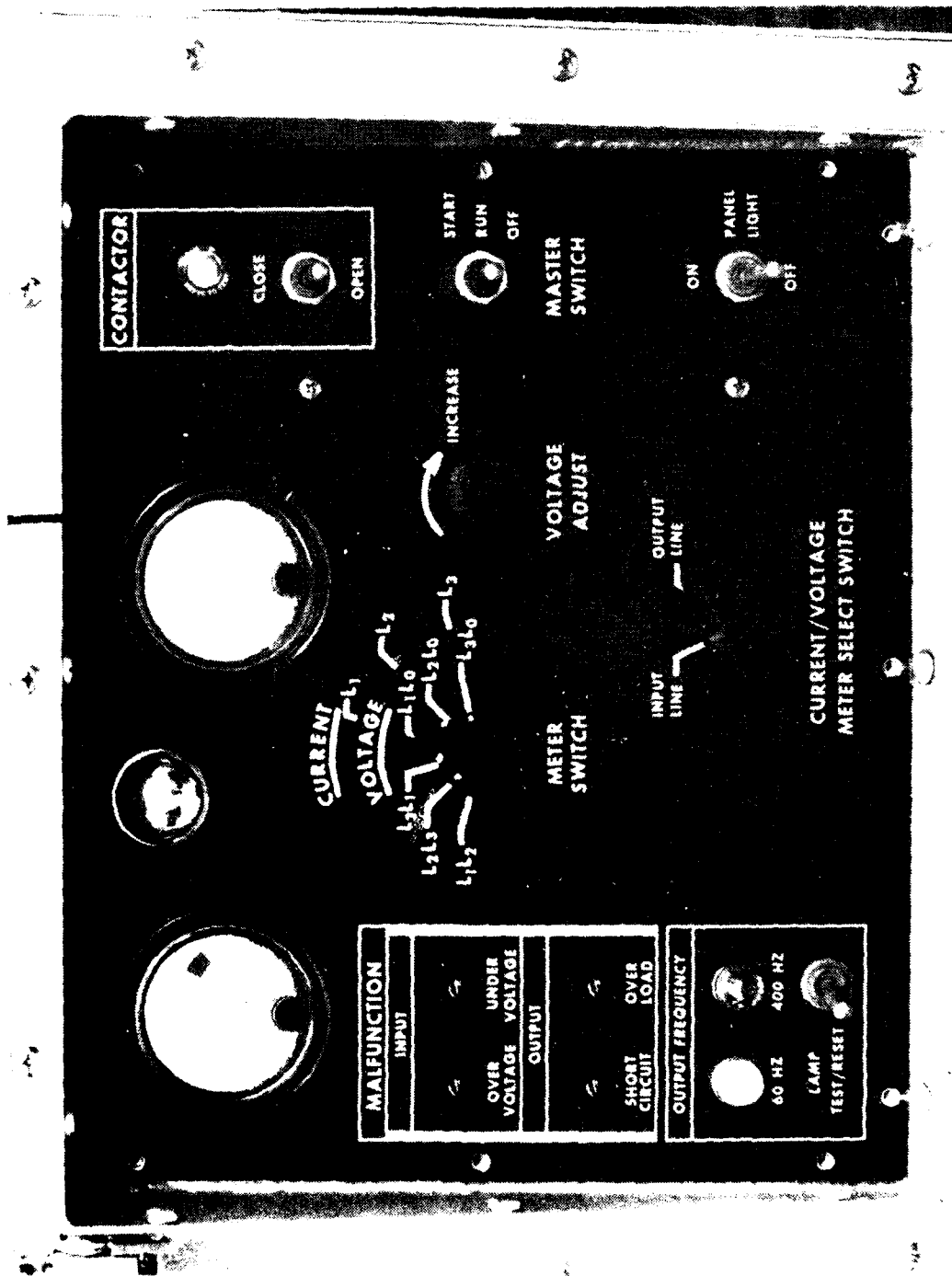

Figure 15. Control Panel

SECTION IV
SUMMARY OF TEST PERFORMANCE

4.1 SUMMARY

The results of the frequency changer electrical performance and endurance tests are summarized in Tables I and II. For some performance characteristics, specifications are not provided explicitly in the purchase descriptions referenced in Section I; and comparison with MIL-STD-1332 Precise or Utility Classes of power is suggested. For a few characteristics there are no specifications at all, and results are simply tabulated and called adequate.

Regulation, losses, efficiencies, and THD are plotted against frequency changer output load in Figures 16 through 25. The recent test data is identical to that previously reported in Delco Electronics Test Report R78-28, and the same summary data applies.

The 1,200-hour endurance test was free of reportable failures. Table II summarizes the test load profile used.

INPUT CHARACTERISTIC PARAMETER	MIL-STD-1332 PREUSE (CLASS 1)	MIL-STD-1332 UTILITY (CLASS 2)	PURCHASE DESCRIPTION	MEASURED PERFORMANCE	COMMENTS OTHER
1) Frequency Change: Input Voltage	N/A	N/A	120/208V +10%, -15%	120/208V +10%, -15%	Complies
2) Frequency Change: Input Frequency	N/A	N/A	50, 60, 400 Hz	60 Hz was tested	Not limited by design
	N/A	N/A	5% over normal load range	5.8% at RL only	Unlimited (See Note A)
	N/A	N/A	2% over normal load range	4.2%, 7th harmonic, RL only	Unlimited (See Note A)
3) Frequency Changer Input Current (60 Hz input frequency)	N/A	N/A	5% over normal load range	Not tested	See Note A
	N/A	N/A	Deviation Factor		
	N/A	N/A	Worst Single Harmonic		
4) Frequency Changer Input Power Factor (60 Hz input frequency)	N/A	N/A	Peak inrush on application of rated load from no load	105% of rated load input current < 125ms rec. time	Adequate, but PD does not specify
5) Converter Output Format (same as inverter input)	N/A	N/A	Not specified	Unity (<5° leading)	Adequate, but PD does not specify
6) Voltage Regulation	N/A	N/A	±150 Vdc, 60A (nom. at RL)	+150 Vdc, 60A (nom. at RL)	Complies
	1%	3%	1.5%	-0.5%	Complies
	1%	N/A	1.5%	-0.5%	Complies
	1%	2%	1%	-0.5%	Complies
	1%	N/A	1%	-0.5%	Complies
	2%	1%	1%	-0.5%	Complies
	2%	N/A	1%	-0.5%	Complies
7) Steady State Stability	N/A	N/A	±150 Vdc, 60A (nom. at RL)	+150 Vdc, 60A (nom. at RL)	Complies
	15%/0.5 sec	20%/3 sec	20%/2 sec	13.7%/250 ms	Complies
	12%/0.5 sec	N/A	20%/2 sec	12.3%/250 ms	Complies
8) Transient Performance	15%/0.5 sec	20%/3 sec	20%/2 sec	14.3%/250 ms	Complies
	12%/0.5 sec	N/A	20%/2 sec	15.0%/250 ms	Complies
	30%/0.7 sec	40%/5 sec	40%/5 sec	1.3%/100 ms	Complies
	25%/0.7 sec	N/A	40%/5 sec	78A/-5 PF	Complies
	5%	5%	5%	2.41%	Complies
	5%	N/A	5%	2.64%	Complies
9) Waveform	2%	2%	2%	1.35%/5th	Complies
	2%	N/A	2%	2.09%/5th	Complies
	5%	5%	5%	5%	Complies
	3%	N/A	5%	<5%	Complies
	-	N/A	3V pk-pk (L-N)	None	Complies
	-	N/A	3V pk-pk (L-N)	None	Complies
10) Voltage Imbalance with Unbalanced Load	5%	5%	5%	<1.5%	Complies
	5%	N/A	5%	<3.0%	Complies
11) Phase-Balance Voltage	1%	1%	Not specified	<1%	Complies with 1332 Practice
	1%	N/A	Not specified	<1%	Complies with 1332 Practice

	60 Hz 400 Hz	5%	5%	5%	5%	5%	5%	5%	5%	5%	5%	5%	5%	5%	5%	5%	5%	5%	5%
9) Waveform:	Max Individual Harmonic Deviation Factor Voltage Modulation (or ripple)	60 Hz 400 Hz	2% 2%	2% 2%	N/A	2% N/A	2% N/A	2% N/A	2% N/A	2% N/A	2% N/A	2% N/A	2% N/A	2% N/A	2% N/A	2% N/A	2% N/A	2% N/A	2% N/A
10) Voltage Unbalance: with Unbalanced Load		60 Hz 400 Hz	5% 5%	5% 5%	N/A	5% N/A	5% N/A	5% N/A	5% N/A	5% N/A	5% N/A	5% N/A	5% N/A	5% N/A	5% N/A	5% N/A	5% N/A	5% N/A	5% N/A
11) Phase Balance Voltage		60 Hz 400 Hz	1% 1%	1% 1%	N/A	1% N/A	1% N/A	1% N/A	1% N/A	1% N/A	1% N/A	1% N/A	1% N/A	1% N/A	1% N/A	1% N/A	1% N/A	1% N/A	1% N/A
12) Voltage Adjustment Range		60 Hz 400 Hz	-5, +15% -5, +10%	-5, +15% -5, +10%	N/A	-5, +15% N/A	-5, +15% N/A	-5, +15% N/A	-5, +15% N/A	-5, +15% N/A	-5, +15% N/A	-5, +15% N/A	-5, +15% N/A	-5, +15% N/A	-5, +15% N/A	-5, +15% N/A	-5, +15% N/A	-5, +15% N/A	-5, +15% N/A
13) Short Circuit Current		60 Hz 400 Hz	- -	- -	N/A	- N/A	- N/A	- N/A	- N/A	- N/A	- N/A	- N/A	- N/A	- N/A	- N/A	- N/A	- N/A	- N/A	- N/A
14) All Output Frequency Parameters		60 Hz 400 Hz	- -	- -	N/A	- N/A	- N/A	- N/A	- N/A	- N/A	- N/A	- N/A	- N/A	- N/A	- N/A	- N/A	- N/A	- N/A	- N/A
15) Phase Angle Balance		60 Hz 400 Hz	- -	- -	N/A	- N/A	- N/A	- N/A	- N/A	- N/A	- N/A	- N/A	- N/A	- N/A	- N/A	- N/A	- N/A	- N/A	- N/A
16) Frequency Changer No Load Losses		60 Hz 400 Hz	N/A N/A	N/A N/A	N/A	N/A N/A	N/A N/A	N/A N/A	N/A N/A	N/A N/A	N/A N/A	N/A N/A	N/A N/A	N/A N/A	N/A N/A	N/A N/A	N/A N/A	N/A N/A	N/A N/A
17) Frequency Changer Efficiency at Full Load (1.0 PF)		60 Hz 400 Hz	N/A N/A	N/A N/A	N/A	N/A N/A	N/A N/A	N/A N/A	N/A N/A	N/A N/A	N/A N/A	N/A N/A	N/A N/A	N/A N/A	N/A N/A	N/A N/A	N/A N/A	N/A N/A	N/A N/A
18) Frequency Changer Efficiency at Rated Load (0.9 PF)		60 Hz 400 Hz	N/A N/A	N/A N/A	N/A	N/A N/A	N/A N/A	N/A N/A	N/A N/A	N/A N/A	N/A N/A	N/A N/A	N/A N/A	N/A N/A	N/A N/A	N/A N/A	N/A N/A	N/A N/A	N/A N/A

NOTES:
A: THD with the frequency changer delivering rated load at 60 Hz or 400 Hz is < 5.5%. If total harmonic content is referenced to the corresponding (i.e., rated) input current THD is nearly the same at lower loads - approximately 6% at no load. The worst single harmonic increases likewise - to approximately 6% at no load.
B: Regulator instability, which can be corrected, was noted.

Table I. Comparison of Electrical Performance With Electrical Specifications

EQUIP FREQUENCY CHANGER

MFR DELCO

MODEL NO. _____

SERIAL NO. _____

REF: MIL-STD-705B 608.1a BY A. H. BARRETT



SANTA BARBARA, CALIFORNIA

TEST REC OUTPUT VOLTAGE

REGULATION NL → RL

φ NL → FL

60HZ

TEST NO. _____

DATE FEB. 3, 1978

BY A. H. BARRETT

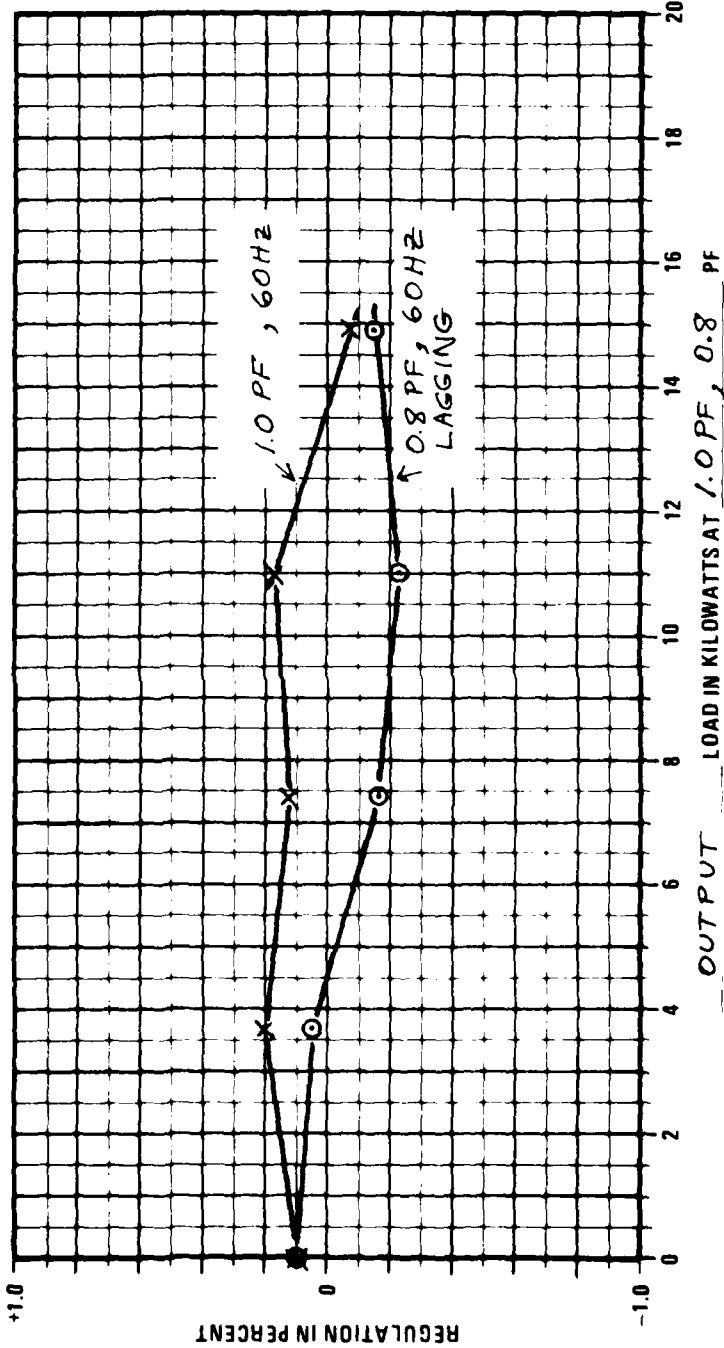

Figure 16. Output Voltage Regulation, 60 Hz

EQUIP FREQUENCY CHANGER

MFGR DELCO

MODEL NO. _____

SERIAL NO. _____

REF: MIL-STD-705B 608.1a



SANTA BARBARA, CALIFORNIA

TEST NO. _____

DATE FEB. 3, 1978

BY A.H. BARRETT

TEST REC OUTPUT VOLTAGE

REGULATION NL → RL

4 NL → FL

400 HZ

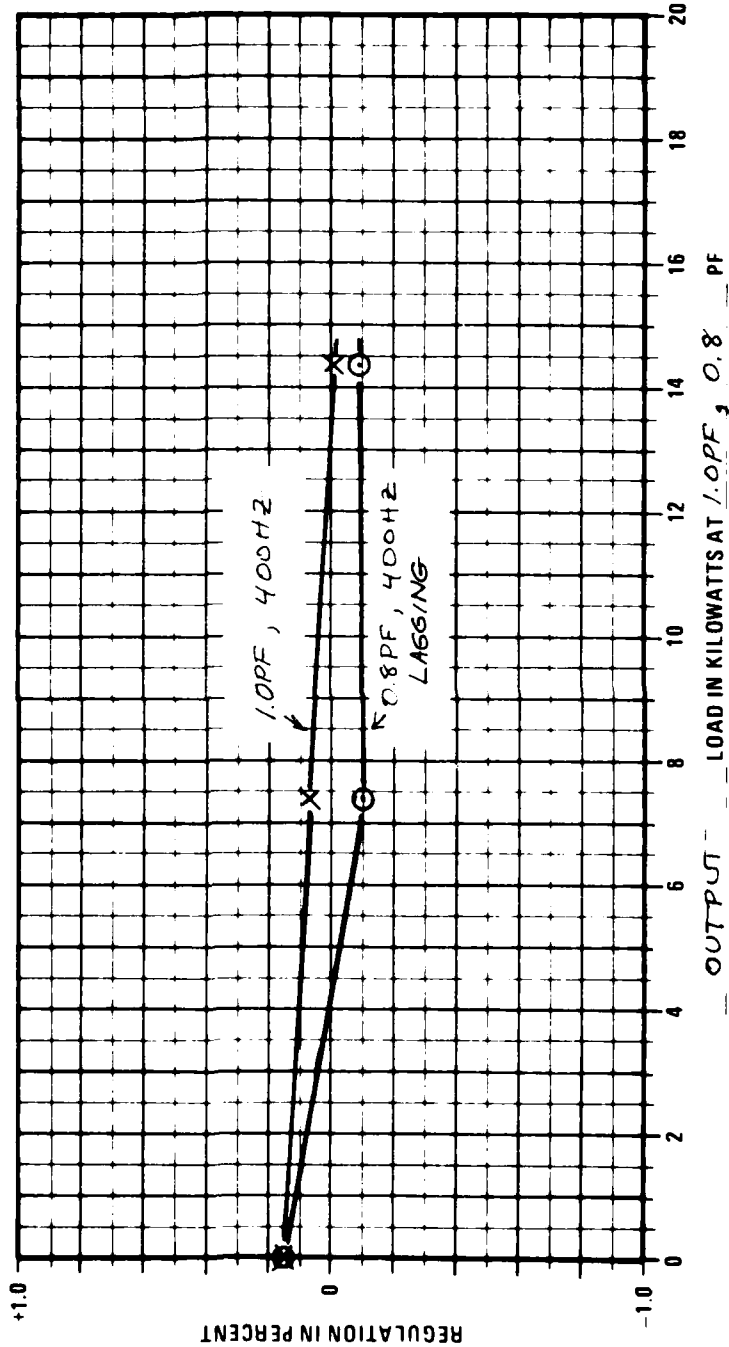
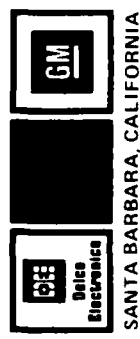

Figure 17. Output Voltage Regulation, 400 Hz.

EQUIP FREQUENCY CHANGER
 MFR DELCO
 MODEL NO. _____
 SERIAL NO. _____
 REF. MIL-STD-705B



SANTA BARBARA, CALIFORNIA
 TEST REC. FREQUENCY CHANGER LOSSES
 (EXCLUDING LOW LEVEL)
 VS LOAD
 60HZ OUTPUT

TEST NO. _____
 DATE FEB. 3, 1978
 BY A. H. BARRETT

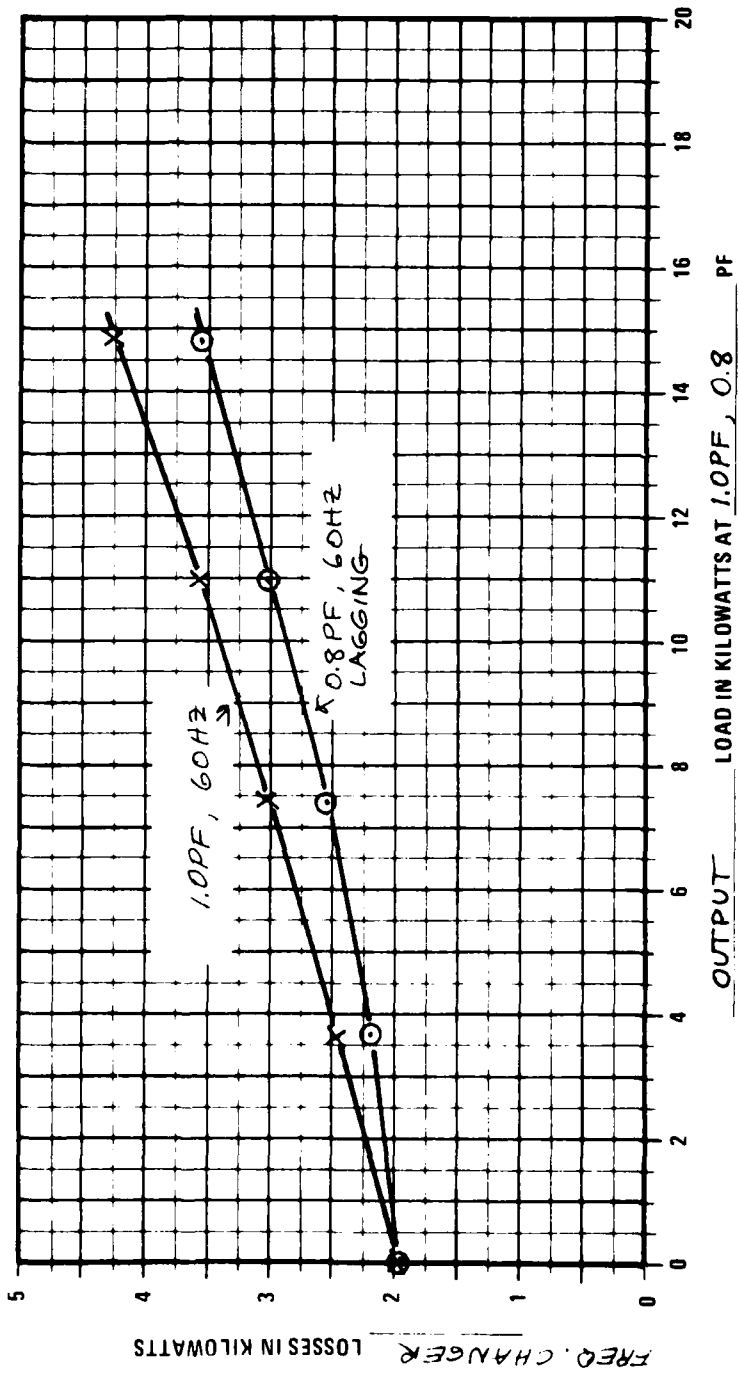
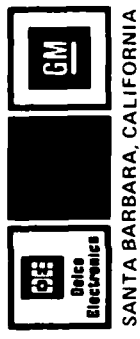

Figure 18. Frequency Changer Losses, 60 Hz Output

EQUIP FREQUENCY CHANGER
 MFR DELCO
 MODEL NO. _____
 SERIAL NO. _____
 REF: MIL-STD-705B
 TEST REC FREQUENCY
 CHANGER LOSSES
 (EXCLUDING LOW LEVEL)
 VS LOAD
 400 HZ OUTPUT



SANTA BARBARA, CALIFORNIA
 DATE FEB. 3, 1978
 BY A. H. BARRETT

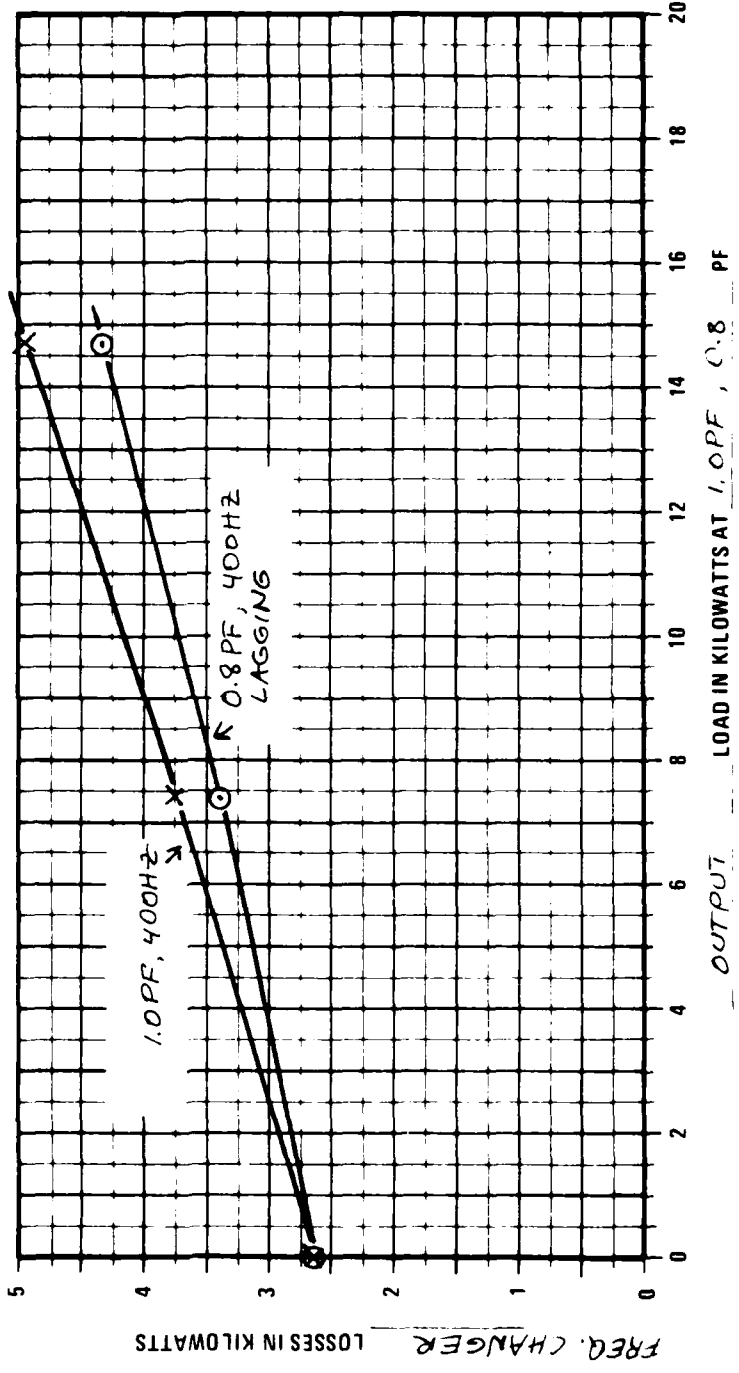

Figure 19. Frequency Changer Losses, 400 Hz Output

EQUIP FREQUENCY CHANGER

MFGR DELCO

MODEL NO. _____

SERIAL NO. _____

REF: MIL-STD-705B



SANTA BARBARA, CALIFORNIA

TEST NO. _____

DATE FEB. 3, 1978

BY A.H. BARRETT

TEST REC CONVERTER

LOSSES, INVERTER

LOSSES VS FREQUENCY

CHANGER LOAD

60HZ OUTPUT

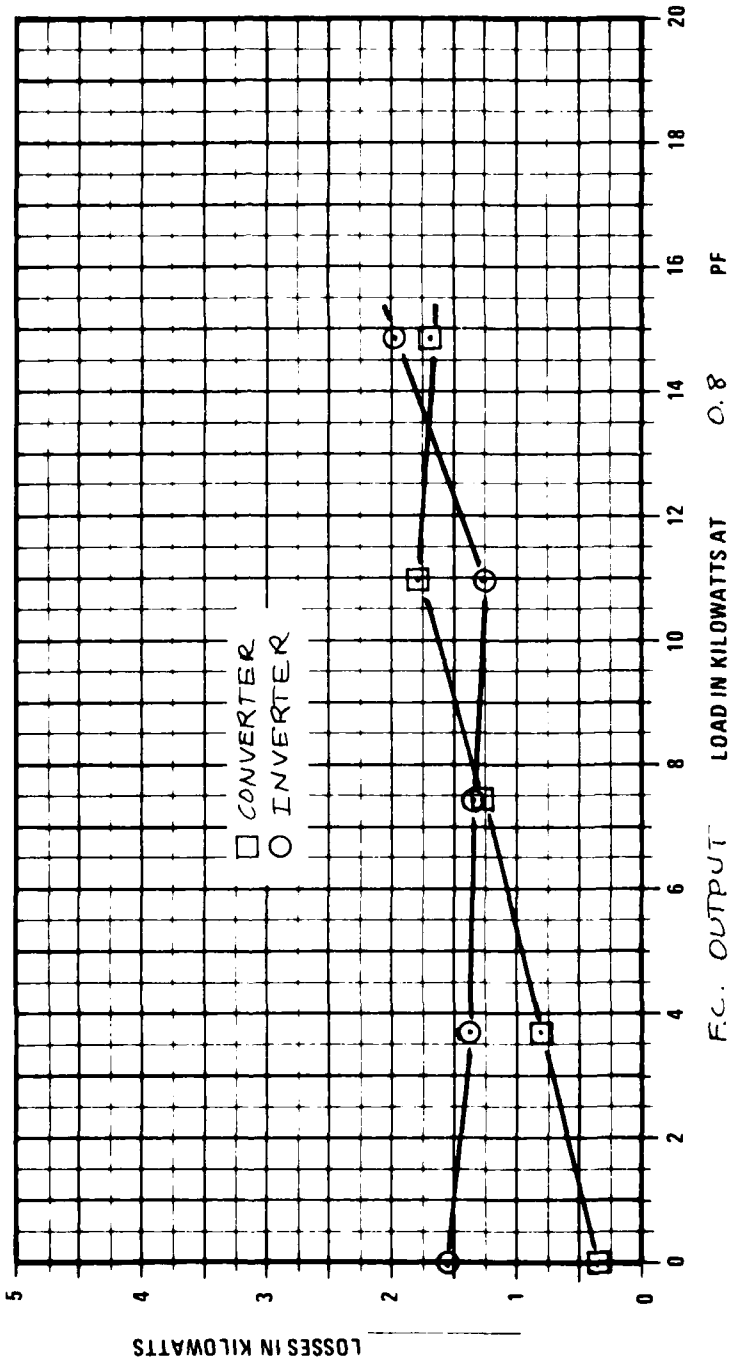

Figure 20. Converter/Inverter Losses vs Load, 60 Hz (output

EQUIP FREQUENCY CHANGER

MFGR DELCO

MODEL NO. _____

SERIAL NO. _____

REF: MIL-STD-705B



SANTA BARBARA, CALIFORNIA

TEST NO. _____

DATE FEB. 3, 1978

BY A. H. BARRETT

TEST REC CONVERTER

LOSSES, INVERTER

LOSSES VS FREQUENCY

CHANGER LOAD

400 HZ OUTPUT

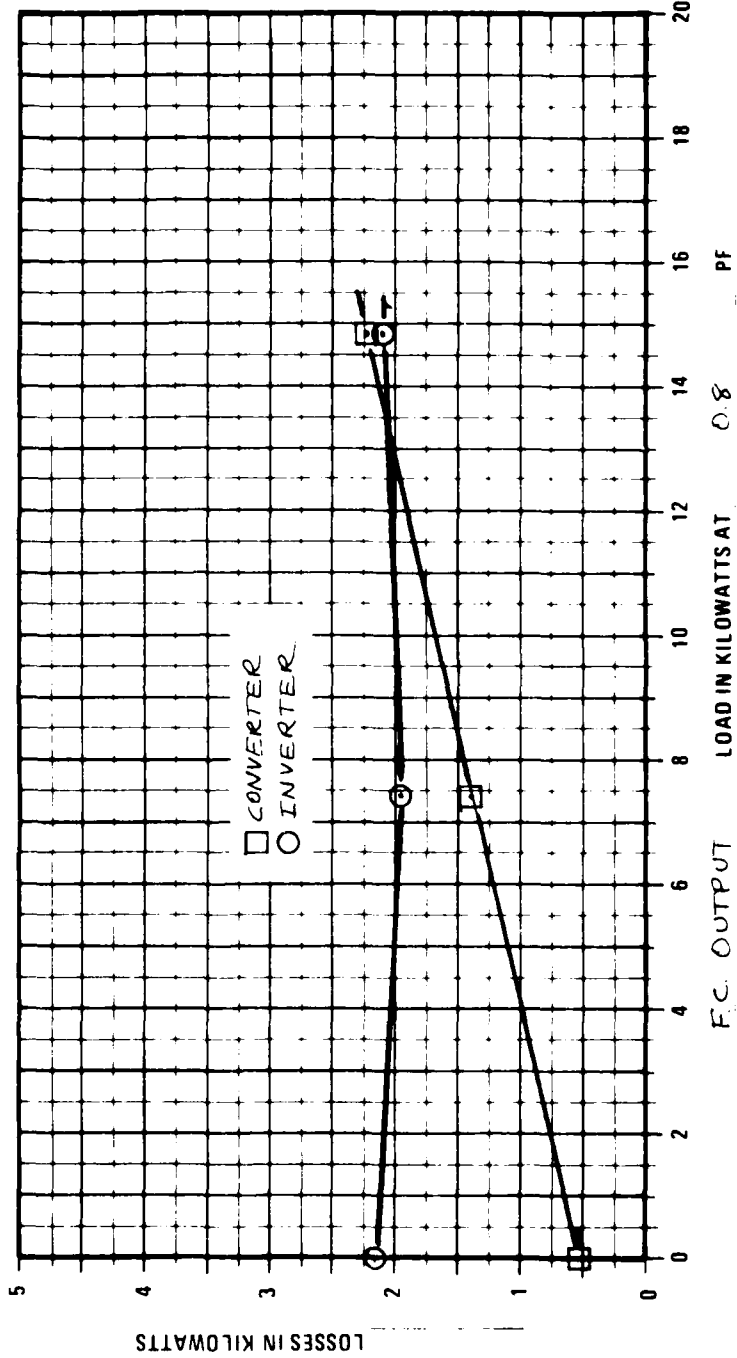

Figure 21. Converter Inverter Losses vs Load, 400 Hz output

EQUIP FREQUENCY CHANGER

MFRG DELCO

MODEL NO. _____

SERIAL NO. _____

REF: MIL-STD-705B

BY A. H. BARRETT

60 HZ OUTPUT



SANTA BARBARA, CALIFORNIA

TEST REC CONVERTER,
INVERTER & FREQ.
CHANGER EFFICIENCY

TEST NO. _____

DATE FEB. 3, 1978

VS P.C. LOAD

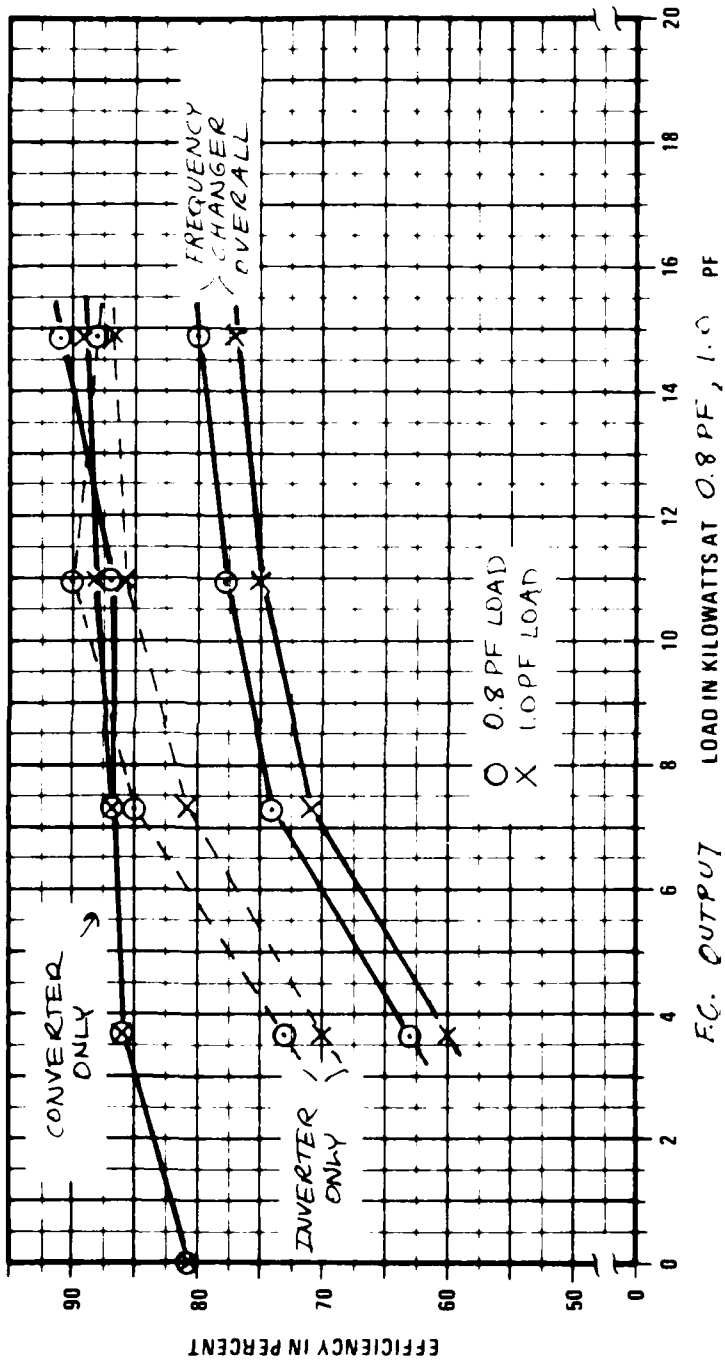

Figure 22. Converter Inverter and Frequency Changer Efficiency, 60 Hz Output

EQUIP FREQUENCY CHANGER
 MFR DELCO
 MODEL NO. _____
 SERIAL NO. _____
 REF MIL-STD-705B



SANTA BARBARA, CALIFORNIA

TEST REC CONVERTER,
INVERTER & FREQ.
CHANGER EFFICIENCY
 VS F.C. LOAD
 400HZ OUTPUT

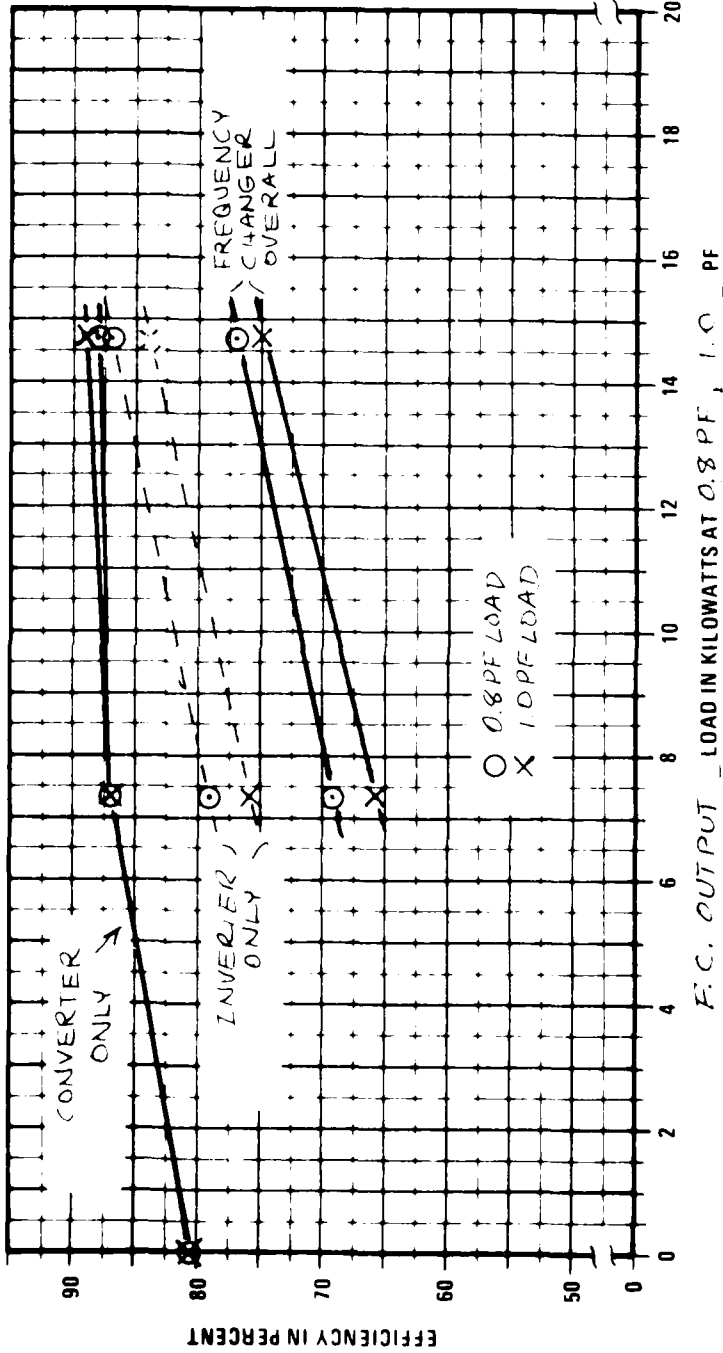

F.C. OUTPUT LOAD IN KILOWATTS AT 0.8 PF, 1.0 PF

Figure 23. Converter Inverter and Frequency Changer Efficiency, 400 Hz output

TEST REC. TOTAL
HARMONIC DISTORTION
 VS FREQUENCY
CHANGER LOAD
60 HZ OUTPUT

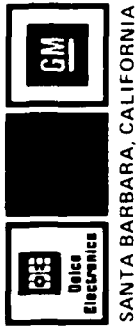

SANTA BARBARA, CALIFORNIA

EQUIP. FREQUENCY CHANGER
 MFG. DELCO
 MODEL NO. _____
 SERIAL NO. _____
 REF. MIL-STD-705B 601.4a BY A.H. BARRETT
 TEST NO. _____
 DATE FEB. 3, 1978

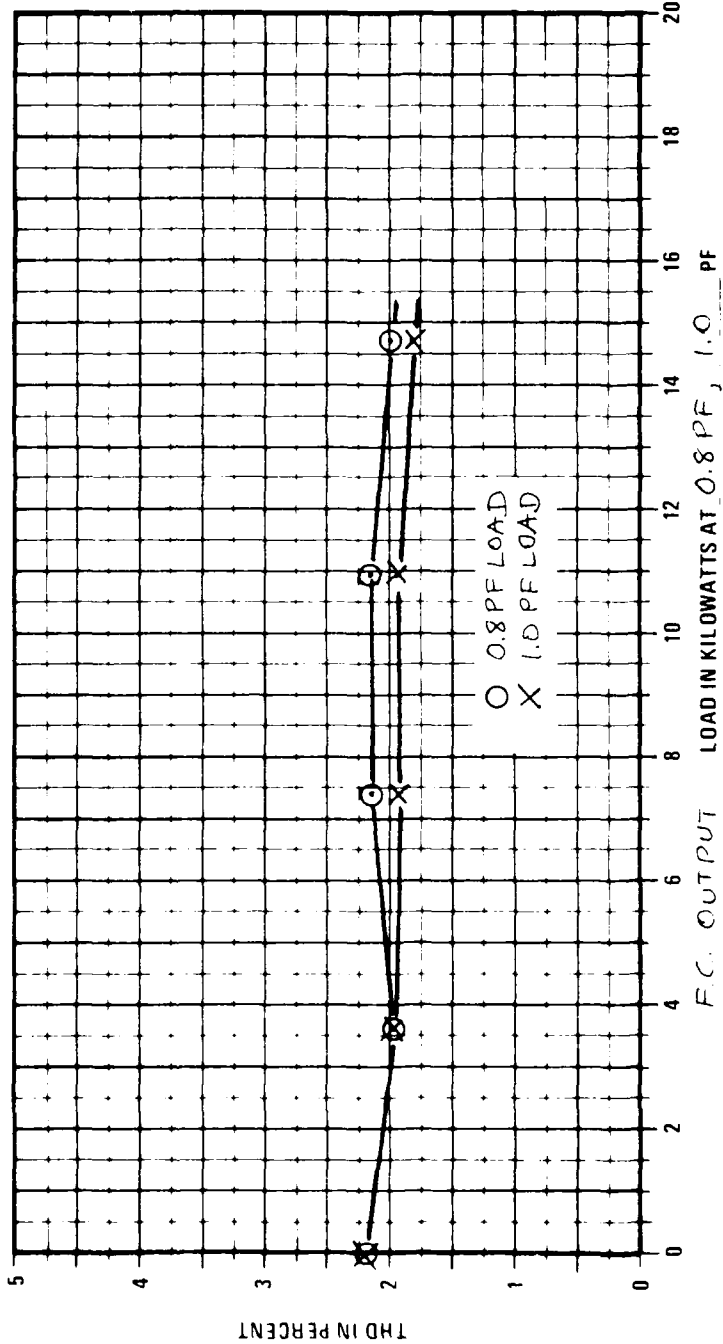

Figure 24. Total Harmonic Distortion versus Load, 60 Hz Output

TEST REC TOTAL
 HARMONIC DISTORTION
 VS FREQUENCY
 CHANGER LOAD
 400HZ OUTPUT



SANTA BARBARA, CALIFORNIA

EQUIP FREQUENCY CHANGER

MFR DELCO

MODEL NO.

SERIAL NO.

REF. MIL-STD-705B 601.4a

TEST NO.

DATE FEB. 3, 1978

BY A. H. BARRETT

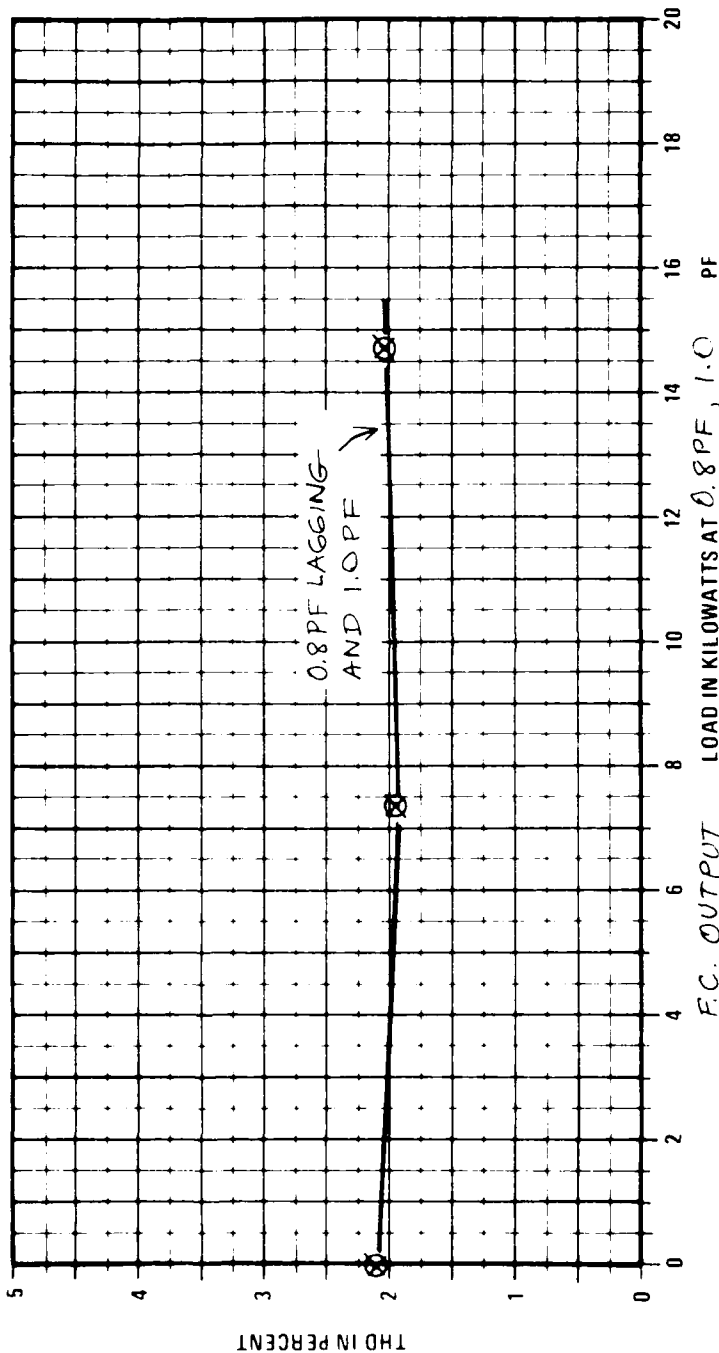

Figure 25. Total Harmonic Distortion versus Load, 400 Hz Output

<u>LOAD</u>	<u>OUTPUT FREQUENCY</u>	
	<u>60 Hz</u>	<u>400 Hz</u>
NL to \leq 0.25 PU	68 h	1 h
>0.25 PU to \leq 0.5 PU	300.5 h	143 h
>0.5 PU to \leq 0.75 PU	185 h	224 h
>0.75 PU to \leq 1.0 PU	169.5 h	111 h
Total Time	1,202 hours (no failures)	

NOTE: PU indicates per unit rated load. Testing was done at 0.8 power factor lagging and unity power factor loading.

Table II. Endurance Test Loads

SECTION V
CONCLUSIONS AND RECOMMENDATIONS

Most test results are better than, or at least compliant with, PD or other requirements. There are deviations, measured or suspected, which are discussed herein.

5.1 PARAMETER 2 — FREQUENCY CHANGER INPUT FREQUENCY AND
PARAMETER 3 — INPUT CURRENT

The set was tested only with 60 Hz input power because adequate 50 Hz and 400 Hz power sources are not available at Delco. There is no design limitation which precludes operation at 50 Hz and 400 Hz. It is quite possible that the present converter input filter would not function as is at 400 Hz, but incorporation of a new relay-controlled center tap on the input inductor of Figure 3 would probably prove effective.

Deviation from the ideal sinusoidal input current is above that specified in the PD. Distortion components are considerably above those measured on a breadboard frequency changer and reported in Delco Electronics Test Report R78-28. For example, at rated load, input current THD was reported as 3.5 percent. It is now reported as 5.8 percent.

The reasons for the degradation in performance should be evaluated. It is believed that the staggered firing pattern of the A, B, and C phase converter SCR's, as opposed to the simultaneous firing pattern formerly used, is the main contributor to the degradation. Addition of a logic power supply in the system may also be a contributing factor.

An amendment to the PD specification should be made if necessary after simultaneous firing has again been tried and analyzed.

5.2 PARAMETER 13 — SHORT CIRCUIT CURRENT

Testing of single, two, and three-phase short circuits (from RL) was done only at 60 Hz output frequency. Earlier testing indicated similar results at 400 Hz output frequency. The inverter portion always seems to function well, but a problem exists in the converter control.

As previously reported, there is still an instability in the low level control circuit for the converter. This results in bursts of output approximately 0.5-second long spaced by "no output" periods of approximately 0.25 second. However, a balanced three-phase short circuit does not cause control instability, and approximately 110A rms per phase was recorded. It has been concluded that accurate and instantaneous monitoring of inverter input current is required for proper short circuit control. This circuit augmentation should be made to the set.

5.3 PARAMETER 16 - NO LOAD LOSSES, PARAMETER 17 - EFFICIENCY AT FULL LOAD, PARAMETER 18 - EFFICIENCY AT RATED LOAD

The purchase description (Ref Section I) states that the no load loss shall not exceed 500 watts and that efficiency with the set operating above 25 percent of rated power shall be 80 percent minimum. No-load losses are well in excess of those specified and, in the fully packaged frequency changes, they are 2.8 kW. The rated load efficiency is 80 percent at 60 Hz output and 76 percent at 400 Hz output.

5.4 RECOMMENDATIONS

Harmonic distortion of the input currents to the frequency changer is very low, although it is greater in some cases than that specified. The input filter for the converter certainly can be improved upon. More should be learned about the effects of source impedance on input current harmonics. It is recommended that Delco refine the input filter while studying source impedance effects. MERADCOM should consider changing the current harmonic specifications. It is recommended that Navy specifications for frequency changers, from the NAVSEC offices, be reviewed.

Delco should further refine the low level control circuits so as to eliminate instabilities that have been shown to occur with heavy unbalanced loads and short circuits.

It was observed during severe overload testing that in addition to output current limiting problems, there were power limiting problems. The frequency changer has no control input to provide constant power into an overload. It is strongly recommended that a constant power limit mode of operation be added.

At 821 hours into the endurance test, a brownout occurred on the 60 Hz input to the frequency changer. The brownout was properly sensed as undervoltage (7 cycles at 80 V), and the set was shut down. A brownout at 1,172 hours caused a second shutdown. The question of what action the set should take in the event of a brownout needs to be answered.

Rather high no-load and light-load losses are related to the specific inverter approach used. The two major contributions are from the following:

- Load-independent, high level, forced commutation circuits
- A very large, fixed, leading power factor, output filter.

It is not recommended that any changes be made in the commutation circuitry, which accounts for at most, a few hundred watts of loss at 400 Hz. It is recommended that consideration be given both by MERADCOM and Delco to implementation of an incrementally variable output filter. The present filter draws 1.1 PU rated output current at 0 PF, leading. This is responsible for as much as 2 kW loss at no load. At no-load and light-loads, smaller filters would greatly reduce inverter losses and, consequently, converter losses and improve loaded efficiency. At rated load, Delco should evaluate the use of a 0.9 to 1.0 PU output filter to slightly improve rated load efficiency.

Temperature checks made on the fully enclosed frequency changer showed several areas of excessive temperature rise. Although some improvement was made by providing more air flow to these areas, they are still too hot for safe operation at 125°F ambient air. It is strongly recommended that thorough temperature tests be made and that redesign efforts be directed to reduction of temperature rise in areas where problems are found to exist.

APPENDIX

Parts Lists and Diagrams

<u>Assy</u>	<u>Title</u>	<u>Page</u>
A1/6	Termination and Filter Assy	A-1
A25/26	Input/Output Current Sense	A-4
A27	Output Voltage Sense	A-7
A28	Input Contactors and Pre-Start Control	A-10
A24	Power Supply Auxiliary	A-13
A20	Converter Sense CCA	A-16
A21	Start-up and Protection Number 1	A-19
A22	Start-up and Protection Number 2	A-22
A23	Regulator	A-26
A29	Blower Assembly	A-29
A7	Control Panel	A-31

DWG NO. SK002313		REVISIONS																																	
		LTR	DESCRIPTION	AUTH.	DATE	APPD																													
REVISION	+	+	+	+																															
SHEET	1	2	3	4	5	6	7	8	9	10	11	12	13	14	15	16	17	18	19	20	21	22	23	24	25	26	27	28							
THE PART NUMBER IS THE DRAWING NUMBER AND THE DASH NUMBER THAT APPLIES																																			
UNLESS OTHERWISE SPECIFIED DIMS. ARE IN INCHES	DETSMN / DSGR		<i>ESTUSAK</i>		<i>24 OCT 78</i>		Delco Electronics										GENERAL MOTORS CORPORATION										SANTA BARBARA, CALIF								
	CHK																																		
REF <i>006</i>	ENGR.		<i>[Signature]</i>		<i>78 Oct 78</i>		TERMINATION & FILTER ASSY																												
	APPD		<i>[Signature]</i>																																
CHG CONTROL	APPD																																		
CONTR NO.	DSGN ACTIVITY						SIZE	CODE	IDENT NO	DWG NO.		SK002313										REV													
	OTHER APPD						A		13160																			+							
							SCALE —					WEIGHT					SHEET / OF 4																		

drl-382 (rev 4-71)

CLASS _____

PARTS LIST		CONTRACT NO.		CODE IDENT NO.	REVISION NOTICE NO.	REV DATE	REV LTR			
LIST TITLE		AUTHENTICATION		13/60	SK002313		REV			
TERMINATION & FILTER ASSY							DATE			
ITEM NO.	QTY REQD	QTY REQD	QTY REQD	QTY REQD	UNIT	CODE IDENT NO.	PART OR IDENTIFYING NUMBER	DRAWING OR SPECIFICATION NUMBER	NOMENCLATURE OR DESCRIPTION	PL NOTES
1	-	-021	-011	1		98376	SK002313-006		HOUSING MAKE FROM ET66-108A	
2	1	-	-	-		98376	SK002313-007		HOUSING MAKE FROM ET66-108A	
3	-	-	-	1			SK002313-001		BOARD, MOUNTING	
4	1	-	-	-			-002		BOARD, MOUNTING	
5	1	-	-	1			-003		BRACKET MTG, LEFT	
6	1	-	-	1			-004		BRACKET MTG, RIGHT	
7	4	-	-	4			-005		BAR, BUSH	
8	6	-	-	6			MS21076L06		NUT PLATE	6-50
9	12	-	-	12			MS20470AD3-6		RIVET, 100°	300 DAX
10	6	-	-	6			MS20470AD3-3		RIVET, 100°	300 DAX
11	4	-	-	4		82168	DGM6-2		TERMINAL	
12	4	-	-	4		56289	JN17-5115A		FILTER, 100A	
13	6	-	-	6			6-32 X 1/2 LG		SCREEN, PAN HD	

PARTS LIST									
LIST TITLE									
TERMINATION & FILTER ASSY									
ITEM NO.	QTY REQD	QTY REQD	QTY REQD	UNIT OF MEAS	CODE IDENT NO.	PART OR IDENTIFYING NUMBER	DRAWING OR SPECIFICATION NUMBER	NOMENCLATURE OR DESCRIPTION	PL NOTES
	-027	-011							
14	8	8				10-32 X 5/8 LG		SCREEN, FLAT HD 100°	
15	8	8				10-32		NUT, HEX	

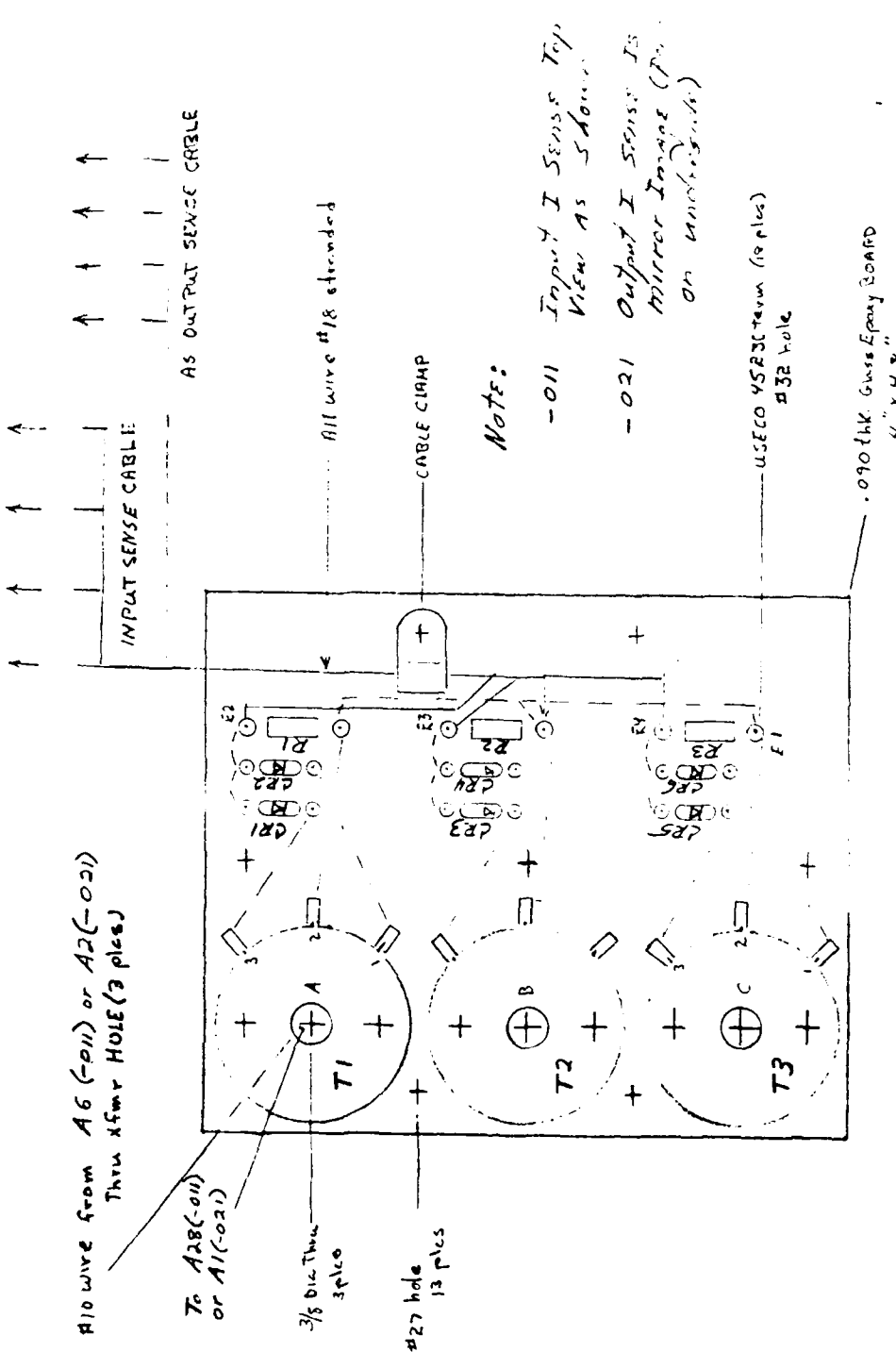

SIZE	CODE IDENT NO.	DWG NO.	REV
	13160	SK002363	A
SCALE	SHEET 2 of		

Input/Output Current Sense

PARTS LIST										
LIST TITLE		CONTRACT NO.		CODE IDENT NO.		REVISION NOTICE NO.		REV. DATE		
Input/Output Current Sense		A25, A26		131600		SK-2002-06				
ITEM NO.	QTY REQ	QTY REQ	QTY REQ	QTY REQ	UNIT OF MEAS	CODE IDENT NO.	PART OR IDENTIFYING NUMBER	DRAWING OR SPECIFICATION NUMBER	NOMENCLATURE OR DESCRIPTION	P. NOTES
1	6						JAN 1N4448		Silicon Rectifier CRV-0106	
2	3						RNC70H24R9FM		Resistor, 249Ω, 1% 0.5W, R1, 2513	
3	3						BOA300		Transformer (Delco) T1, 2513	
4	1						MPS 25281		Clamp	
5	18						45230		Turnst Terminal (Delco)	
6	1								Spore Board 4" x 4.8" x .070"	
7	1						SK002427		Reference Schematic (Delco)	

SIZE A	CODE IDENT NO. 13160	DWG NO. SK002364	REV A
SCALE		SHEET 2 of	

Output Voltage Sense

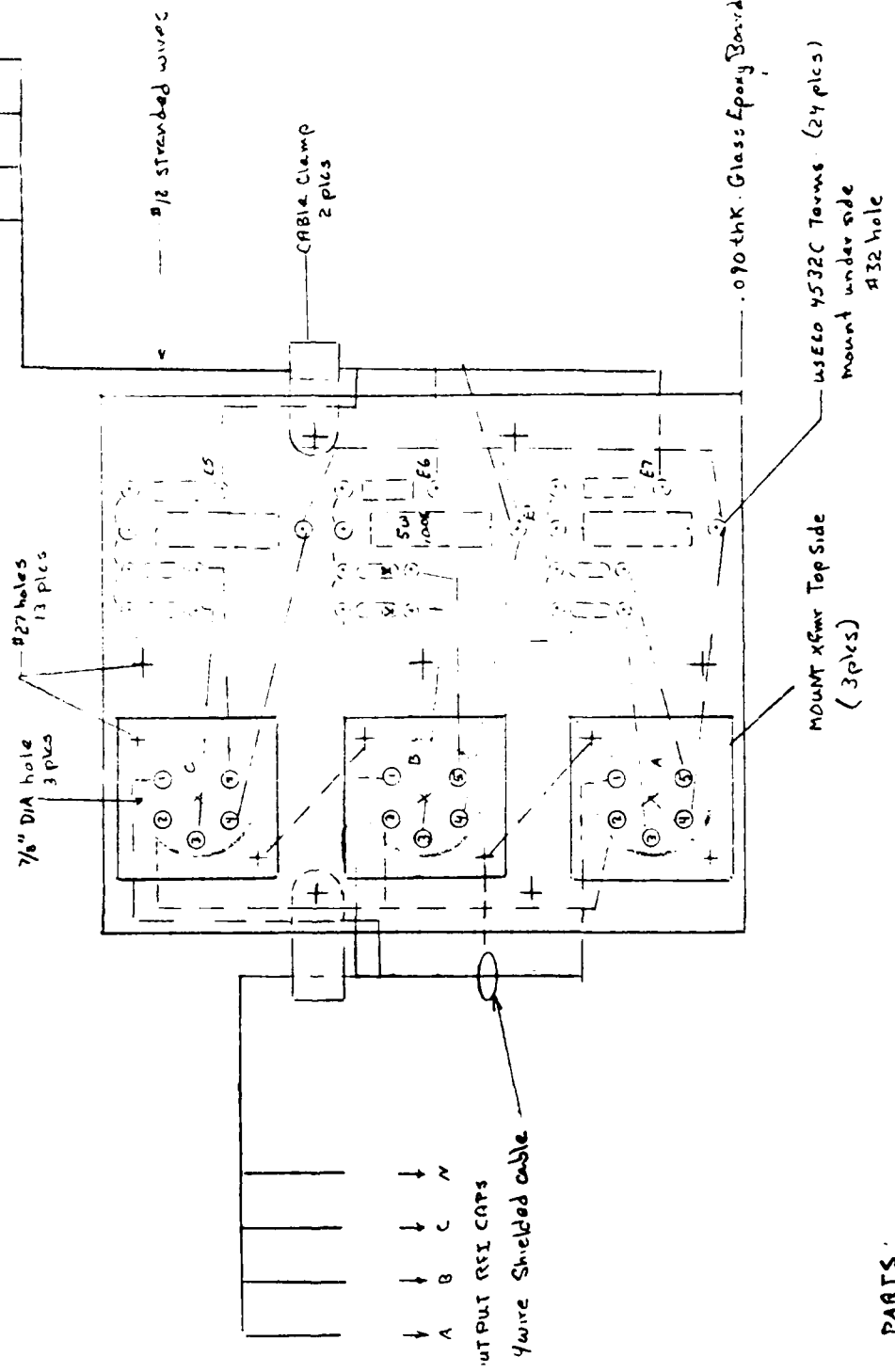

PARTS

PARTS LIST										
LIST TITLE		CONTRACT NO.		CODE IDENT NO.		REVISION NOTICE NO.		REV DATE		
Output Voltage Sense		420		13/60		5107-2384				
ITEM NO.	QTY RECD	QTY RECD	QTY RECD	QTY RECD	UNIT OF MEAS	CODE IDENT NO.	PART OR IDENTIFYING NUMBER	DRAWING OR SPECIFICATION NUMBER	NOMENCLATURE OR DESCRIPTION	P. NOTES
1	6						JAN 115619		Silicon Rectifier CRV-526	
2	3						RWR 451002FAD		Resistor, R 2, 4.7K 10.0K Ω , 5W	
3	3						RNC60H 100ZFM		Resistor, R 1, 3.0K Ω 20.0K, 0.25W, 1070	
4	2						MS 25281		Clamp	
5	3						TF42X01AH M8094		Transformer (Phenolic) T 1, 2.5.3	
6	24						4532C		Turnst Terminal (4532C)	
7	1								Spay Board 4'x4.8'x.020"	
8	1						SK002427		Reference Schematic (Delco)	

CODE IDENT NO. 13160	DWG NO. SK002365	REV
SHEET 2 OF		

NOT OVER 145-133-COM, 3pk's

1/8" hole 18°
from 0° on
3/8" R

Epoxy Board
7.25" x 7.25" x .090"

Trapped (Confidential)
E. P. - State 7 (8) 76

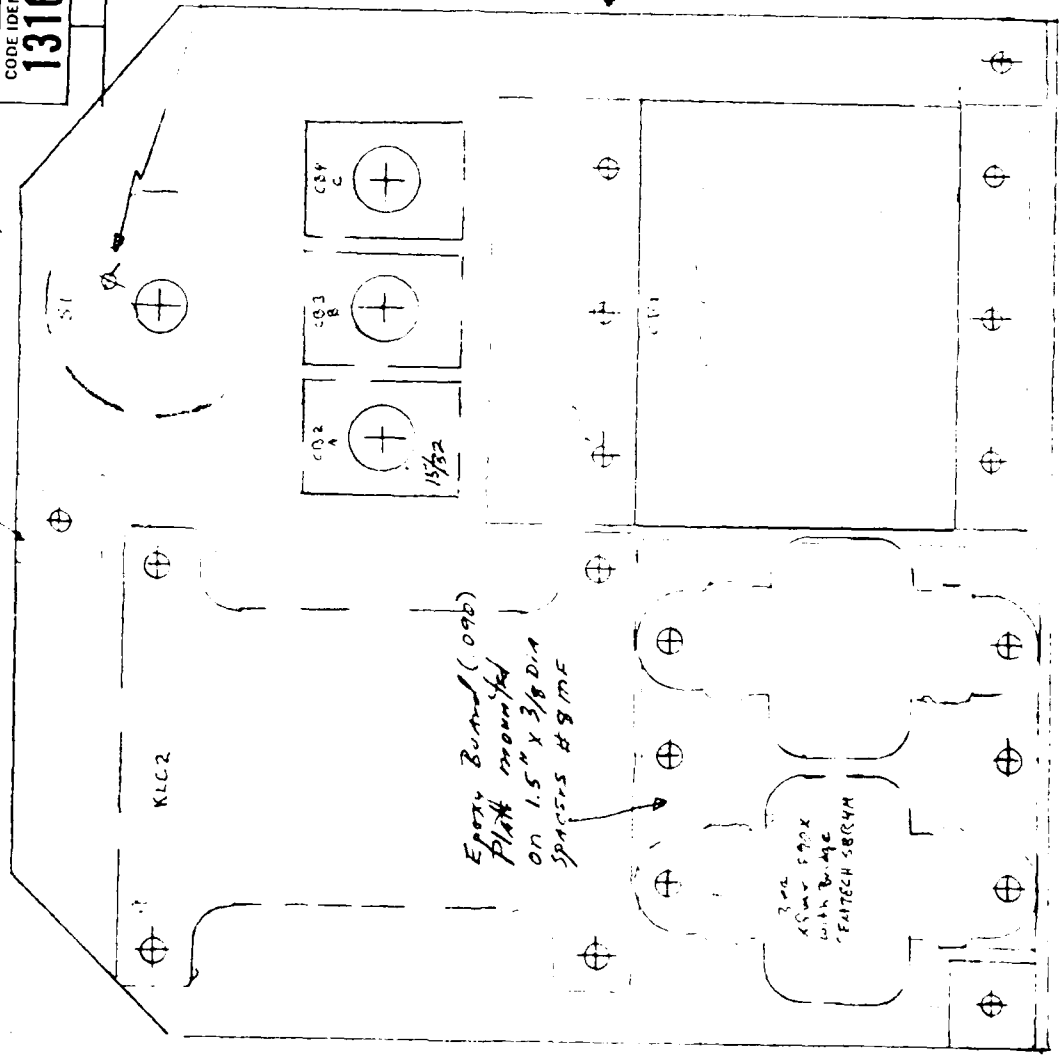

PARTS LIST											
LIST TITLE: INPUT CONTACTORS & Pre-Start Control											
CONTRACT NO.		CODE IDENT NO.		REVISION NOTICE NO.		REV DATE		REV LTR			
AUTHENTICATION		13100		SK002365				SHEET 3 OF 3			
ITEM NO	QTY RECD	QTY RECD	QTY RECD	QTY RECD	QTY RECD	UNIT OF MEAS	CODE IDENT NO	PART OR IDENTIFYING NUMBER	DRAWING OR SPECIFICATION NUMBER	NOMENCLATURE OR DESCRIPTION	PL NOTES
1	1							P3XAM1516		Circuit Breaker 100A, (Heinamans)	CBI
2	3							MS25244-5		Circuit Breaker, 5A, CB 2, 3 & 4	
3								M39014/C1-1225		Capacitor, 0.022µF, 200V, 10%	C1
4	3							SBR4M		Rectifier (Semitech)	R1, 2 & 3
5	1							RCR42G471.75		Resistor, 470Ω 2W	R1
5	2							K-220G333JS		Resistor, 3.3KΩ 0.5W	R2, 3
7	1							9555H13A		Power Relay (with stud)	RK2
8	3							F70X		Transformer (Triad)	T1, 2 & 3
9	3							NAS1033-106M		Nutplate	
10	1							42D36-2X2-17A		Relay Switch (Graphite)	S1
11	1							SK002427		Reference Schematic (Delco)	

REVISIONS																												
		DESCRIPTION																ACTD.	DATE	APPD.								
REVISION	+	+	+																									
SHEET	1	2	3	4	5	6	7	8	9	10	11	12	13	14	15	16	17	18	19	20	21	22	23	24	25	26	27	28
THE PART NUMBER IS THE DRAWING NUMBER AND THE DASH NUMBER THAT APPLIES																												
UNLESS OTHERWISE SPECIFIED DIMS. ARE IN INCHES	DFTSMN / DSGR				Delco Electronics																GENERAL MOTORS CORPORATION SANTA BARBARA, CALIF							
	CHK			POWER SUPPLY, AUXILIARY - 24																								
REF	D06		ENGR:																	RFB	5/31/79							
CHG CONTROL			APPD																									
CONTR NO.			DSGN ACTIVITY			SIZE	CODE IDENT NO	DWG NO.	REV																			
			OTHER APPD			A	13160	SK002409	+																			
						SCALE	WEIGHT	SHEET 1 OF 3																				

DWG NO. SA 002409

drl-382 (rev 4-7-7)

CLASS

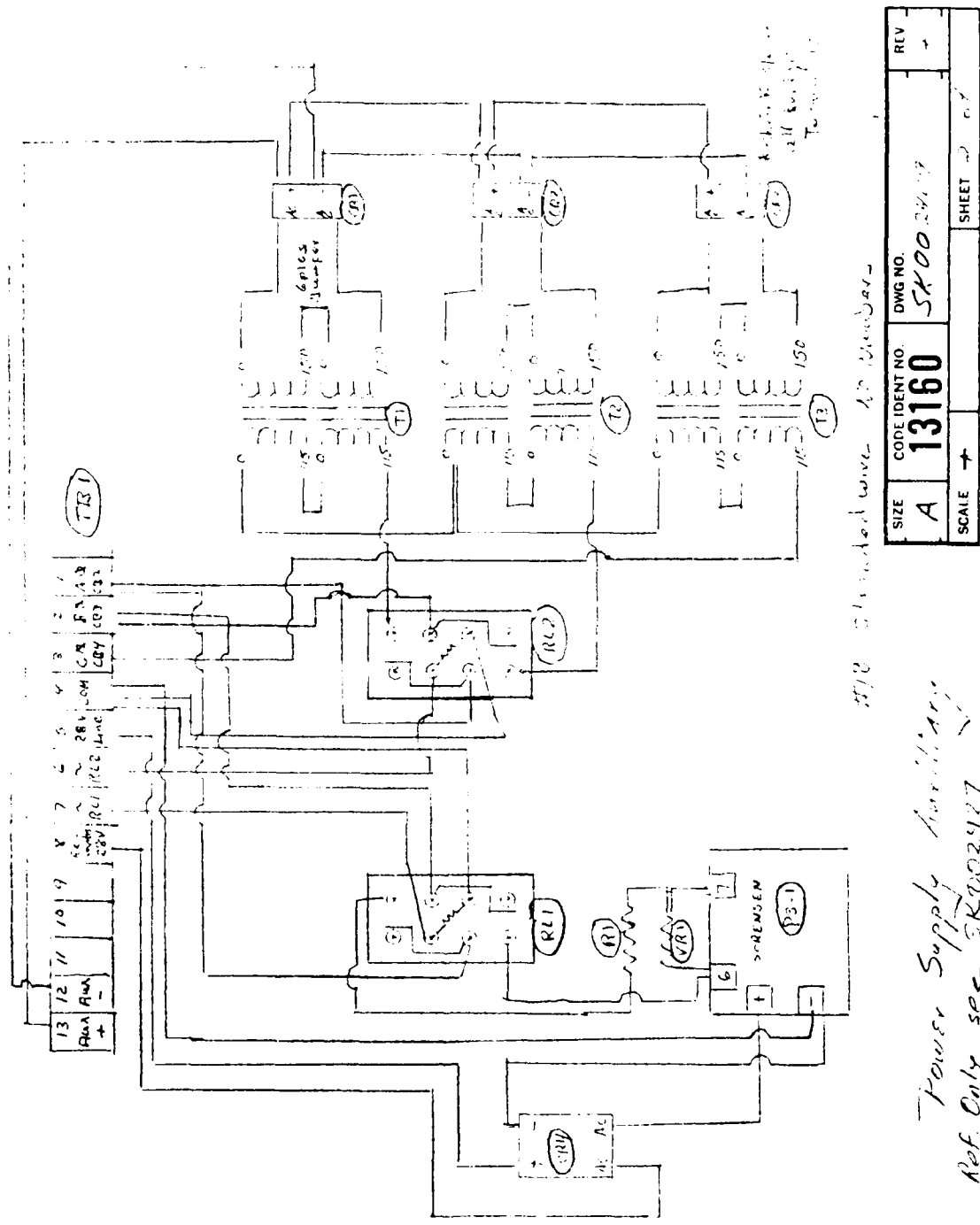

278 checked wire to Barbara

Power Supply Auxiliary
Ref. Only see SK002427

PARTS LIST										
LIST TITLE: <i>Power Supply Auxiliary A24</i>										
ITEM NO.	QTY REQD	QTY REQD	QTY REQD	QTY REQD	UNIT OF MEAS	CODE OF IDENT NO	PART OR IDENTIFYING NUMBER	DRAWING OR SPECIFICATION NUMBER	NOMENCLATURE OR DESCRIPTION	P. NOTE
1	4						SCBAGF		Rectifier Bridge (Sens. Tech) API-1140	
2	1						SSD24-8.5		Power Supply (Sens. Tech) 1140	
3	2						CA 800-8, BR17X-30002-20V		Relay (Ind. Serv.) R11112	
4	1						NH-50, 4.9952, 30W		Resistor (Qual.) R1	
5	1						V250 HE 250		MOV (GE), VK1	
6	3						DL-300-0.5T		Transformer (Sens.) T1	
7	1						MSD1212-2-15		Terminal Block 13 No. 10 Studs	
8	1						SK002315		Bracket (Delco)	
9	2						SK002316		Side Plate (Delco)	
10	1						SK002427		Reference Section (Delco)	

REVISIONS																											
LTR	DESCRIPTION																	AUTH.	DATE	APPD							
A	REVISED SCHEMATIC & RELEASE																		9.17.60	UJT							

REVISION	A	A	A	A																								
SHEET	1	2	3	4	5	6	7	8	9	10	11	12	13	14	15	16	17	18	19	20	21	22	23	24	25	26	27	28

THE PART NUMBER IS THE DRAWING NUMBER AND THE DASH NUMBER THAT APPLIES

UNLESS OTHERWISE SPECIFIED DIMS. ARE IN INCHES	<input checked="" type="checkbox"/> DFTSMN		Delco Electronics GENERAL MOTORS CORPORATION SANTA BARBARA, CALIF
	<input checked="" type="checkbox"/> DSGR		
REF	ENGR	APPD	CONVERTER SENSE CCA A 20
D06	RFB		
CHG CONTROL	ENGR	APPD	
	DSGN ACTIVITY		
CONTR NO.	OTHER APPD		
		SIZE	CODE IDENT NO
		A	13160
		SCALE	WEIGHT
		OWG NO.	REV
		SK 002405	A
		SHEET 1 OF 4	

DWG NO. SK002405

drl-382 (rev 4-71)

CLASS

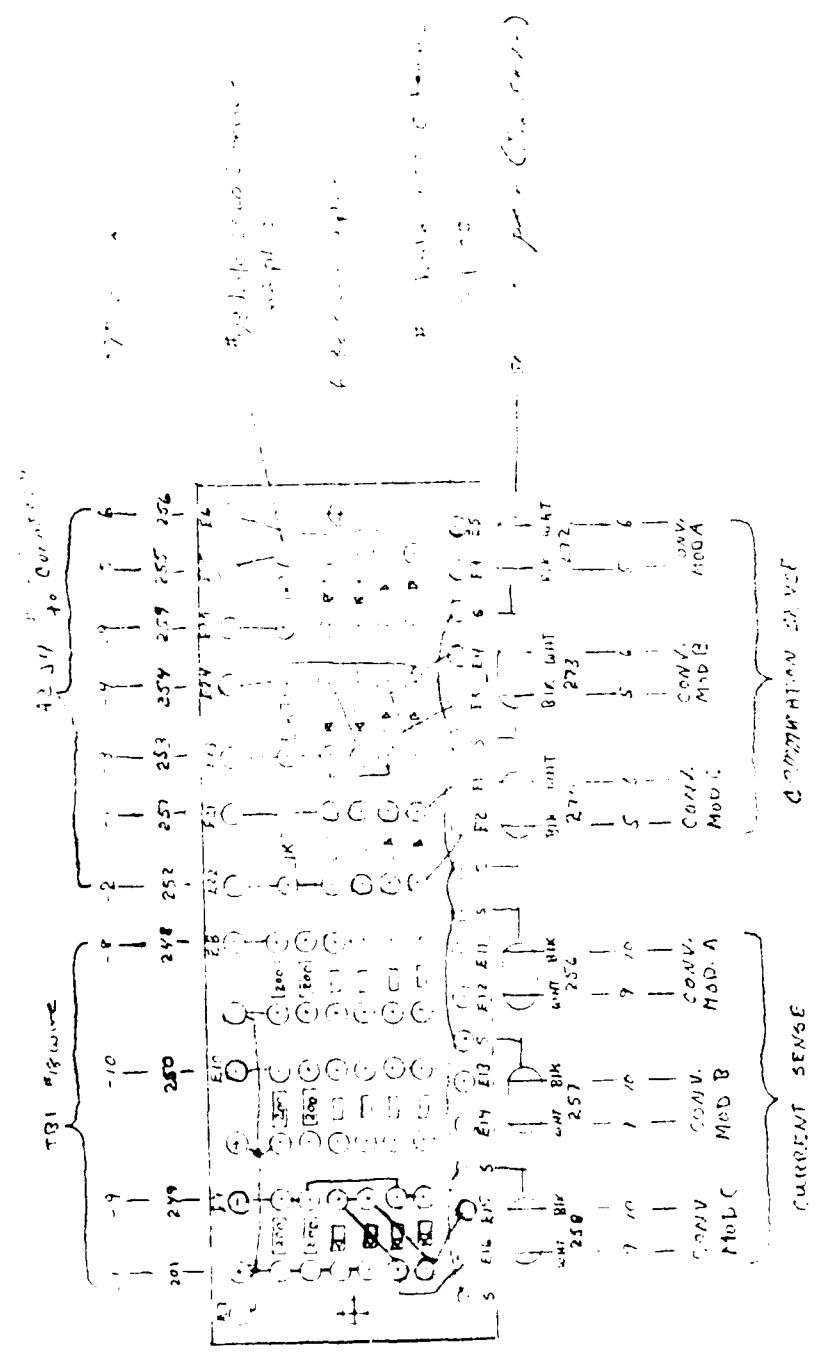

Converter Sensor Ckt

SIZE	CODE IDENT NO	DWG NO	REV
A	13160	SK 602400	1
SCALE	SHEET 3		

PARTS LIST		LIST FILE		CCA		Converter Series		DRAWING OR SPECIFICATION NUMBER		MANUFACTURING INFORMATION	
ITEM NO	QTY REQD	QTY REQD	QTY REQD	QTY REQD	QTY REQD	UNIT OF MEAS	CODE IDENT NO	PART OR IDENTIFYING NUMBER	DRAWING OR SPECIFICATION NUMBER	MANUFACTURING INFORMATION	MANUFACTURING INFORMATION
1	24							JAN IN/148-1		See drawing CA 14-15	
2	3							RCR20102TS		14 15% 0.5W 500K RPP-20	
3	6							RMC 60/2000FM		200.1 1/2, 0.25W, 700K	
4	66							2520-C		Tolerance 0.1% 100K	
5	33							4530-C		tolerance 0.1% 100K	
6	1									200.1 1/2, 0.25W, 700K	

PARTS LIST												
LIST TITLE: <i>Start-Up & Protection No. 1 A 31</i>												
CONTRACT NO.			AUTHENTICATION			CODE IDENT. NO.			REV. DATE			
						13100			5-22-61			
ITEM NO.	QTY REQD - 0/1	QTY REQD	QTY REQD	UNIT OF MEAS.	CODE IDENT. NO.	PART OR IDENTIFYING NUMBER	DRAWING OR SPECIFICATION NUMBER	NAME, RELATURE OR DESCRIPTION	PL. NO. 1	PL. NO. 2	PL. NO. 3	
1	1					M390 2/41-2355		Capacitor, 1.2µF, 50V				
2	1					M390 2/41-2275		Capacitor, 4µF, 50V				
3	9					M370 1/41-1434	CK05	Capacitor, 0.1µF				
4	2					M370 2/41-2306		Capacitor, 0.1µF				
5	6					M390 1/51-2274/11		Resistor, 1/2W, 100Ω				
6	7					REK01-10375		Resistor, 1/2W, 100Ω				
7	2					REK005-12475		Resistor, 1/2W, 100Ω				
8	7					PRR0554/6-3FP		Resistor, 1/2W, 100Ω				
9	1					PRR0554-2675		Resistor, 1/2W, 100Ω				
10	1					PRR05-10575		Resistor, 1/2W, 100Ω				
11	1					PRR05-10575		Resistor, 1/2W, 100Ω				
12	1					PRR05-10575		Resistor, 1/2W, 100Ω				
13	4					PRR05-10575-1		Resistor, 1/2W, 100Ω				

PARTS LIST										
ITEM NO	QTY REJC	QTY RECD	QTY RECD	QTY RECD	UNIT OF MEAS	CODE IDENT NO	PART NUMBER	PART NUMBER	NAME, MANUFACTURE OR DESCRIPTION	REMARKS
1	-011						1110 111		I.C.	1110 111
							1110 112		I.C.	112
							1110 113		I.C.	113
							1110 114		I.C.	114
							1110 115		I.C.	115
							1110 116		I.C.	116
							1110 117		I.C.	117
							1110 118		I.C.	118
							1110 119		I.C.	119
							1110 120		I.C.	120
							1110 121		Transmission	121



REV		REVISIONS																																	
		LTR	DESCRIPTION	AUTH.	DATE	APPD																													
		A	REVISED SCHEMATIC & RELEASE																									9-17-80	U.S.T.						
DWG NO. SK 002405																																			
REVISION	A	A	A	A	A																														
SHEET	1	2	3	4	5	6	7	8	9	10	11	12	13	14	15	16	17	18	19	20	21	22	23	24	25	26	27	28							
THE PART NUMBER IS THE DRAWING NUMBER AND THE DASH NUMBER THAT APPLIES																																			
UNLESS OTHERWISE SPECIFIED DIMS. ARE IN INCHES	DESIGN																																		
	CHK																																		
REF	ENGR																																		
	APPD	START-UP & PROTECTION No 2																																	
CHG CONTROL	APPD	A-22																																	
	DSGN ACTIVITY																																		
CONTR NO.	OTHER APPD																																		
	SIZE	A	CODE IDENT NO	13160	DWG NO.	SK002405	REV	A																											
SCALE		WEIGHT		SHEET / OF 5																															

drl-382 (rev 4-71)



CLASS _____

PARTS LIST												
LIST TITLE		CONTRACT NO.		CODE IDENT NO.		REGISTRATION NO.		AUTHORIZATION		REV. DATE		REV. NO.
ITEM NO.	QTY REQD	QTY REQD	QTY REQD	QTY REQD	UNIT OF MEAS	CODE IDENT NO.	PART OR IDENTIFYING NUMBER	DRAWING OR SPECIFICATION NUMBER	NOMENCLATURE OR DESCRIPTION	P. NOTES		
1	1						1066A 252K		1066A 252K			
2	1						1066A 252K		1066A 252K			
3	2						M390 1/4-20-3/8		M390 1/4-20-3/8			
4	1						M48 1/4-20-3/8		M48 1/4-20-3/8			
5	1						M390 1/4-20-3/8		M390 1/4-20-3/8			
6	5						PERODG 510175		PERODG 510175			
7	2						PERODG 510175		PERODG 510175			
8	2						PERODG 510175		PERODG 510175			
9	1						PN150 1/4-20-3/8		PN150 1/4-20-3/8			
10	1						PN150 1/4-20-3/8		PN150 1/4-20-3/8			
11	1						PN150 1/4-20-3/8		PN150 1/4-20-3/8			
12	1						PN150 1/4-20-3/8		PN150 1/4-20-3/8			
13	2						PN150 1/4-20-3/8		PN150 1/4-20-3/8			

PARTS LIST										
LIST TITLE		QUANTITY		CODE IDENT N		REVISION NOTATION		REV DATE		
5747-66 F Protection M2		A22		13160						
ITEM NO.	QTY REQD	QTY REQD	QTY REQD	QTY REQD	UNIT OF MEAS	CODE OF IDENT NO	PART OR IDENTIFYING NUMBER	DRAWING OR SPECIFICATION NUMBER	NOMENCLATURE OR DESCRIPTION	QUANTITY
14	1						RESISTOR 500 OHM 1/2 W		Resistor 500 Ohm 1/2 W	1
15	2						RESISTOR 100 OHM 1/2 W		Resistor, 100 Ohm 1/2 W	2
16	1						RESISTOR 25.5K 1/2 W		Resistor, 25.5K, 1/2 W, 1/2 W	1
17	2						RESISTOR 100 OHM 1/2 W		Resistor, 100 Ohm, 1/2 W	2
18	1						RESISTOR 100 OHM 1/2 W		Resistor, 100 Ohm, 1/2 W	1
19	1						RESISTOR 100 OHM 1/2 W		Resistor, 100 Ohm, 1/2 W	1
20	1						RESISTOR 500 OHM 1/2 W		Resistor, 500 Ohm, 1/2 W	1
21	3						RESISTOR 100 OHM 1/2 W		Resistor, 100 Ohm, 1/2 W	3
22	1						RESISTOR 500 OHM 1/2 W		Resistor, 500 Ohm, 1/2 W	1
23	1						RESISTOR 100 OHM 1/2 W		Resistor, 100 Ohm, 1/2 W	1
24	1						RESISTOR 25.5K 1/2 W		Resistor 25.5K (100)	1
25	5						DIODE 1N4148		Diode 1N4148	5
26	2						DIODE 1N4148		Diode 1N4148	2

PARTS LIST										
LIST TITLE		CONTRACT NO.		CODE IDENT NO.		REV. DATE		REV. LTR		
Start-Up of Production No. A-22		AUTHENTICATION		REVISION NOTICE NO.		REV. DATE		SHEET		
ITEM NO.	QTY REQD	QTY REQD	QTY REQD	QTY REQD	UNIT OF MEAS	CODE IDENT NO.	PART OR IDENTIFYING NUMBER	DRAWING OR SPECIFICATION NUMBER	NOMENCLATURE OR DESCRIPTION	PL NOTES
27	13						JAN 24 1951		Z.C.	
28	1						LMD140K		Z.C.	
29	7						LMD155K		Z.C.	
30	1						LMD124D		Z.C.	
31	1						LMD150H		Z.C.	
32	2						MMS4194T		Z.C.	
33	1						CD 4243		Z.C.	
34	1						CD 4258		Z.C.	
35	1						LF 11 H		Z.C.	
36	1						CD 4251		Z.C.	
37	1						CD 4252		Z.C.	
38	1						CD 4252		Z.C.	

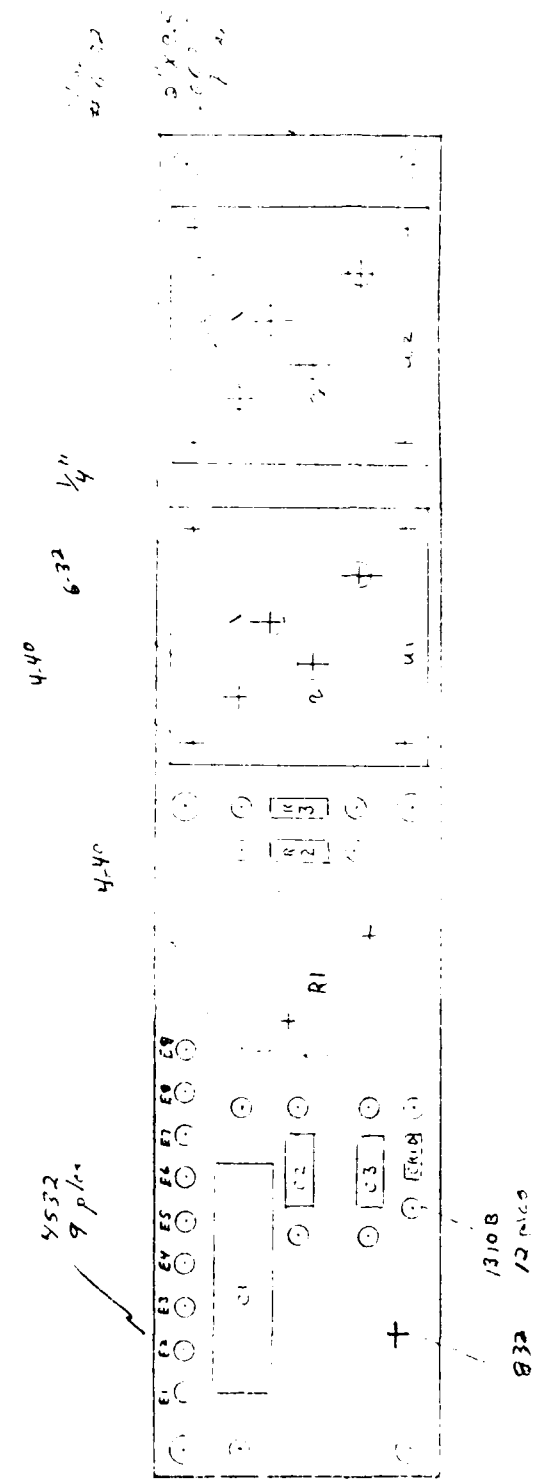

SIZE A	CODE IDENT NO. 13160	DWG NO. SK 003408	REV +
SCALE →	SHEET 3 of 4		

PARTS LIST		REGULATOR		A23		AUTHENTICATION		CONTRACT NO.		CODE IDENT. NO.		REVISION NOTICE NO.		REV. DATE		REVISION DATE	
ITEM NO.	QTY REQD	QTY REQD	QTY REQD	QTY REQD	QTY REQD	UNIT OF MEAS	CODE IDENT NO.	PART OR IDENTIFYING NUMBER	DRAWING OR SPECIFICATION NUMBER	NOMENCLATURE OR DESCRIPTION	REVISION DATE	REVISION DATE	REVISION DATE	REVISION DATE	REVISION DATE	REVISION DATE	REVISION DATE
1	1							JAN IN5552		Silicon Rectifier, CRV							
2	1									Capacitor, 100µF, 50V A1 Electro. C1							
3	2									Capacitor, 1.2µF, 50V Solid Tantal, C2, C3							
4	1							RCR01G3161FM		Resistor, 3.16KΩ, 25W R2							
5	1							RCR01G2370FM		Resistor 237Ω, 25W R3							
6	1								NH-10	Resistor, 0.1Ω, 2%, 10W R1							
7	1							LM109K		IC, U2							
8	1							LM150K		IC, U1							
9	2							680-1.0A		Heatshnk, Washcoat							
10	1									Heatshnk, Washcoat							
11	9							4552		Tungst Term. Wires							
12	12							1310 B		Reference Term. Wires							

PARTS LIST										
LIST TITLE		CONTRACT NO.		AUTHENTICATION		CODE IDENT NO.		REVISION NOTICE NO.		REV. DATE
BLOWER ASSY		A 29				13760		SK 7002410		
ITEM NO.	QTY REQD	QTY REQD	QTY REQD	QTY REQD	UNIT OF MEAS.	CODE IDENT NO.	PART OR IDENTIFYING NUMBER	DRAWING OR SPECIFICATION NUMBER	NOMENCLATURE OR DESCRIPTION	PL. NO.
1	3					02660	760120VZ282		Blower, 120V, 50/60 Hz	
2	1						SK002309-028		Plate (Ckt.)	

DWG NO. SK002291	REV	REVISIONS																										
	+	LTR	DESCRIPTION	AUTH.	DATE	APPD																						
REVISION	+	+	+	+	+	+	+	+	+	+	+	+	+	+	+	+	+	+	+	+	+	+	+	+	+	+	+	+
SHEET	1	2	3	4	5	6	7	8	9	10	11	12	13	14	15	16	17	18	19	20	21	22	23	24	25	26	27	28
THE PART NUMBER IS THE DRAWING NUMBER AND THE DASH NUMBER THAT APPLIES																												
UNLESS OTHERWISE SPECIFIED DIMS. ARE IN INCHES	DFTSMN	KOSTUSAK	25 SEP	Delco Electronics GENERAL MOTORS CORPORATION SANTA BARBARA, CALIF PANEL, CONTROL ELECTRICAL COMPONENTS																								
	DSGR		78																									
REF	ENGR		NOV 1978																									
006	APPD																											
CHG CONTROL	APPD																											
	DSGN ACTIVITY																											
CONTR NO.	OTHER APPD			SIZE	CODE IDENT NO.	DWG NO.	REV																					
				A	13160	SK002291	+																					
				SCALE	—										WEIGHT	SHEET 1 OF 5												

drl-382 (rev 4-71)

CLASS _____

PARTS LIST		CONTRACT NO.		JOB IDENT. NO.		REV. DATE		PL. NO. 50	
LIST TITLE		AUTHORIZATION		REVISION NOTICE NO.		REV. DATE		PL. NO. 50	
CONTROL ELECTRICAL COMPONENTS									
1				SK002291-001				PANEL, FRONT	
2				TBA				AMMETER (MI)	
3			77221	627-14717				VOLTMETER (MC)	
4				M527407-5				SWITCH, TOGGLE (S1)	(MASTER)
5				M524523-22				SWITCH, TOGGLE (S2)	(PAR. LAMP)
6				M524523-27				SWITCH, TOGGLE (S3)	(CONT.)
7				TBA				SWITCH, ROTARY (S4)	(METER SEC.)
8				M524524-26				SWITCH, TOGGLE (S5)	(LAMP)
9			29604	736567				SWITCH, ROTARY (S6)	(METER)
10				RA205ASD102A				POT (R1)	
11				LH89/1				LAMP BASE (DS1 + DS6)	
12				LC35EN2				LENS (RED) (DS1 + DS4)	
13				LC35GN2				LENS (GRN) (DS5, DS6)	

PARTS LIST		CONTRACT NO.		CODE IDENT NO.	REV. DATE	REV. NO.	PL. NOTES		
LIST TITLE		AUTHENTICATION		REVISION NO. OR NO.	REV. DATE	REV. NO.	PL. NOTES		
PANEL CONTROL ELECTRICAL COMPONENTS									
ITEM NO.	QTY RECD	QTY RECD	QTY RECD	QTY RECD	UNIT OF MEAS.	CODE IDENT NO.	PART OR IDENTIFYING NUMBER	DRAWING OR SPECIFICATION NUMBER	NOMENCLATURE OR DESCRIPTION
14					- 011	72619	47-3202-2900-301		LAMP ASSY (D57)
15							M525041-4		LAMP ASSY (AMERL.) (D58)
16							M525237-387		LAMP
17						03508	6S6D-24V		LAMP
18							M591528-2N28		KNOB (R1)
19							M591528-2P28		KNOB (S4, S6)
20						65092	9808-150754		GASKET, METER
21							M59021-012		0" RING (.559 I.D.)
22							M59021-013		0" RING (.421 I.D.)
23							M59021-016		0" RING (.619 I.D.)

**DAT
ILM**