

AD-A104 668

ARMY ENGINEER DISTRICT ST LOUIS MO

F/G 13/13

NATIONAL DAM SAFETY PROGRAM. HICKORY HILLS GOLF CLUB DAM (NO NA--ETC(U)
SEP 78

UNCLASSIFIED

NI

1 of 1
AD A
10 04 89

AD A
10 04 89

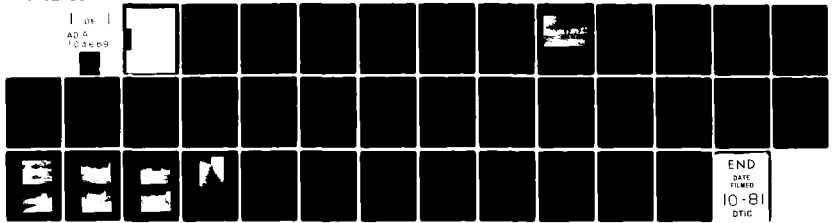

END
DATE
FILMED
10-81
DTIC

AD A104668

UNCLASSIFIED

SECURITY CLASSIFICATION OF THIS PAGE (When Data Entered)

REPORT DOCUMENTATION PAGE		READ INSTRUCTIONS BEFORE COMPLETING FORM	
1. REPORT NUMBER	2. GOVT ACCESSION NO. <i>AD-A104 668</i>	3. RECIPIENT'S CATALOG NUMBER	
4. TITLE (and Subtitle) Phase I Dam Inspection Report National Dam Safety Program Hickory Hills Golf Club Dam (MO 30403) Jefferson County, Missouri		5. TYPE OF REPORT & PERIOD COVERED Final Report.	
7. AUTHOR(s) Corps of Engineers, St. Louis District		6. PERFORMING ORG. REPORT NUMBER	
9. PERFORMING ORGANIZATION NAME AND ADDRESS U.S. Army Engineer District, St. Louis Dam Inventory and Inspection Section, LMSED-PD 210 Tucker Blvd., North, St. Louis, Mo. 63101		8. CONTRACT OR GRANT NUMBER(s) N/A	
11. CONTROLLING OFFICE NAME AND ADDRESS U.S. Army Engineer District, St. Louis Dam Inventory and Inspection Section, LMSED-PD 210 Tucker Blvd., North, St. Louis, Mo. 63101		10. PROGRAM ELEMENT PROJECT, TASK AREA & WORK UNIT NUMBERS <i>1131</i>	
14. MONITORING AGENCY NAME & ADDRESS (if different from Controlling Office) <i>(G)</i> National Dam Safety Program. Hickory Hills Golf Club Dam (No Name 235), Mississippi-Kaskaskia-St. Louis Basin, Jefferson County, Missouri. Phase I Inspection Report.		12. REPORT DATE <i>11</i> September 1978	
16. DISTRIBUTION STATEMENT Approved for release; distribution unlimited.		13. NUMBER OF PAGES Approximately 30	
17. DISTRIBUTION STATEMENT (of the abstract entered in Block 20, if different from Report)		15. SECURITY CLASS. (of this report) UNCLASSIFIED	
18. SUPPLEMENTARY NOTES		15a. DECLASSIFICATION/DOWNGRADING SCHEDULE	
19. KEY WORDS (Continue on reverse side if necessary and identify by block number) Dam Safety, Lake, Dam Inspection, Private Dams			
20. ABSTRACT (Continue on reverse side if necessary and identify by block number) This report was prepared under the National Program of Inspection of Non-Federal Dams. This report assesses the general condition of the dam with respect to safety, based on available data and on visual inspection, to determine if the dam poses hazards to human life or property.			

DD FORM 1 JAN 73 1473

EDITION OF 1 NOV 65 IS OBSOLETE

11-1538

UNCLASSIFIED

SECURITY CLASSIFICATION OF THIS PAGE (When Data Entered)

SECURITY CLASSIFICATION OF THIS PAGE(When Data Entered)



SECURITY CLASSIFICATION OF THIS PAGE(When Data Entered)

INSTRUCTIONS FOR PREPARATION OF REPORT DOCUMENTATION PAGE

RESPONSIBILITY. The controlling DoD office will be responsible for completion of the Report Documentation Page, DD Form 1473, in all technical reports prepared by or for DoD organizations.

CLASSIFICATION. Since this Report Documentation Page, DD Form 1473, is used in preparing announcements, bibliographies, and data banks, it should be unclassified if possible. If a classification is required, identify the classified items on the page by the appropriate symbol.

C LATION GUIDE

General. Make Blocks 1, 4, 5, 6, 7, 11, 13, 15, and 16 agree with the corresponding information on the report cover. Leave Blocks 2 and 3 blank.

Block 1. Report Number. Enter the unique alphanumeric report number shown on the cover.

Block 2. Government Accession No. Leave Blank. This space is for use by the Defense Documentation Center.

Block 3. Recipient's Catalog Number. Leave blank. This space is for the use of the report recipient to assist in future retrieval of the document.

Block 4. Title and Subtitle. Enter the title in all capital letters exactly as it appears on the publication. Titles should be unclassified whenever possible. Write out the English equivalent for Greek letters and mathematical symbols in the title (see "Abstracting Scientific and Technical Reports of Defense-sponsored RDT/E," AD-667 000). If the report has a subtitle, this subtitle should follow the main title, be separated by a comma or semicolon if appropriate, and be initially capitalized. If a publication has a title in a foreign language, translate the title into English and follow the English translation with the title in the original language. Make every effort to simplify the title before publication.

Block 5. Type of Report and Period Covered. Indicate here whether report is interim, final, etc., and, if applicable, inclusive dates of period covered, such as the life of a contract covered in a final contractor report.

Block 6. Performing Organization Report Number. Only numbers other than the official report number shown in Block 1, such as series numbers for in-house reports or a contractor/grantee number assigned by him, will be placed in this space. If no such numbers are used, leave this space blank.

Block 7. Author(s). Include corresponding information from the report cover. Give the name(s) of the author(s) in conventional order (for example, John R. Doe or, if author prefers, J. Robert Doe). In addition, list the affiliation of an author if it differs from that of the performing organization.

Block 8. Contract or Grant Number(s). For a contractor or grantee report, enter the complete contract or grant number(s) under which the work reported was accomplished. Leave blank in in-house reports.

Block 9. Performing Organization Name and Address. For in-house reports enter the name and address, including office symbol, of the performing activity. For contractor or grantee reports enter the name and address of the contractor or grantee who prepared the report and identify the appropriate corporate division, school, laboratory, etc., of the author. List city, state, and ZIP Code.

Block 10. Program Element, Project, Task Area, and Work Unit Numbers. Enter here the number code from the applicable Department of Defense form, such as the DD Form 1498, "Research and Technology Work Unit Summary" or the DD Form 1634, "Research and Development Planning Summary," which identifies the program element, project, task area, and work unit or equivalent under which the work was authorized.

Block 11. Controlling Office Name and Address. Enter the full, official name and address, including office symbol, of the controlling office. (Equates to funding/sponsoring agency. For definition see DoD Directive 5200.20, "Distribution Statements on Technical Documents.")

Block 12. Report Date. Enter here the day, month, and year or month and year as shown on the cover.

Block 13. Number of Pages. Enter the total number of pages.

Block 14. Monitoring Agency Name and Address (if different from Controlling Office). For use when the controlling or funding office does not directly administer a project, contract, or grant, but delegates the administrative responsibility to another organization.

Blocks 15 & 15a. Security Classification of the Report: Declassification/Downgrading Schedule of the Report. Enter in 15 the highest classification of the report. If appropriate, enter in 15a the declassification/downgrading schedule of the report, using the abbreviations for declassification/downgrading schedules listed in paragraph 4-207 of DoD 5200.1-R.

Block 16. Distribution Statement of the Report. Insert here the applicable distribution statement of the report from DoD Directive 5200.20, "Distribution Statements on Technical Documents."

Block 17. Distribution Statement (of the abstract entered in Block 20, if different from the distribution statement of the report). Insert here the applicable distribution statement of the abstract from DoD Directive 5200.20, "Distribution Statements on Technical Documents."

Block 18. Supplementary Notes. Enter information not included elsewhere but useful, such as: Prepared in cooperation with . . . Translation of (or by) . . . Presented at conference of . . . To be published in . . .

Block 19. Key Words. Select terms or short phrases that identify the principal subjects covered in the report, and are sufficiently specific and precise to be used as index entries for cataloging, conforming to standard terminology. The DoD "Thesaurus of Engineering and Scientific Terms" (TEST), AD-672 000, can be helpful.

Block 20. Abstract. The abstract should be a brief (not to exceed 200 words) factual summary of the most significant information contained in the report. If possible, the abstract of a classified report should be unclassified and the abstract to an unclassified report should consist of publicly-releasable information. If the report contains a significant bibliography or literature survey, mention it here. For information on preparing abstracts see "Abstracting Scientific and Technical Reports of Defense-Sponsored RDT&E," AD-667 000.

JOACHIM CREEK BASIN

HICKORY HILLS GOLF CLUB LAKE DAM (NO NAME NO. 235)
JEFFERSON COUNTY, MISSOURI

MISSOURI INVENTORY NO. 30403

PHASE I INSPECTION REPORT
NATIONAL DAM SAFETY PROGRAM

Accession For	
NTIS GRA&I	<input checked="" type="checkbox"/>
DTIC TAB	<input type="checkbox"/>
Unannounced	<input type="checkbox"/>
Justification	
By _____	
Distribution/	
Availability Codes	
Avail and/or	
Dist	Special
A	

PREPARED BY: ST. LOUIS DISTRICT CORPS OF ENGINEERS
FOR: GOVERNOR OF MISSOURI

SEPTEMBER 1978

PHASE I REPORT

NATIONAL DAM SAFETY PROGRAM

Name of Dam	No Name No. 235, Hickory Hills Golf Club Dam
State Located	Missouri
County Located	Jefferson
Stream	Unnamed Tributary to Joachim Creek
Date of Inspection	6 September 1978

No Name No. 235, Hickory Hills Golf Club Dam No. Mo. 30403 was inspected using the "Recommended Guidelines for Safety Inspection of Dams." These guidelines were developed by the Chief of Engineers, U. S. Army, Washington, D. C., with the help of Federal and state agencies, professional engineering organizations, and private engineers. The resulting guidelines are considered to represent a consensus of the engineering profession.

Based on the criteria in the guidelines, the dam is in the high hazard potential classification, which means that loss of life and appreciable property loss could occur in the event of failure of the dam. Six houses, two improved roads, a shopping center and a railroad bridge (Missouri Pacific Railroad) would be subjected to flooding with possible damage and/or destruction and possible loss of life. No Name No. 235 Dam is in the small size classification since it is greater than 25 feet high but less than 40 feet high.

The inspection and evaluation indicate that the spillway of Lake No Name 235 does not meet the criteria set forth in the guidelines for a dam having the above size and hazard potential. Lake No Name 235 is a small size dam with a high hazard potential required by the guidelines to pass from one-half PMF to the PMF. Considering the high hazard potential to loss of life and property downstream of the dam, the outlet facilities of No Name 235 should be able to pass the PMF without overtopping the dam. However, it was determined that the spillway will only pass 10 percent of the PMF without overtopping the dam.

Since the outlet facilities for Lake No Name 235 are not capable of passing a minimum of one-half (50 percent) of the PMF without overtopping the dam and causing failure, the spillway is considered seriously inadequate and the dam is accordingly classified as an unsafe, non-emergency structure.

The evaluation of No Name 235 also indicated that the spillway will not pass the 100-year flood; that is, a flood having a 1 percent chance of being equalled or exceeded during any given year.

Other deficiencies visually observed by the inspection team were steep slopes; the need for removal of brush and trees on the dam; seepage and marshy condition on the downstream slope, lack of erosion protection on the dam (except for large trees growing on the upstream slope); and lack of erosion protection on the spillway. The size and extent of vegetation, combined with the steep slopes, are such that remedial measures should be attempted only under the direction of an experienced engineer to avoid creating an unsafe condition. The lack of stability and seepage analyses on record is a deficiency that should be corrected.

It is recommended that the owner take action to correct or control the deficiencies described.

Thomas F. Wolff
THOMAS F. WOLFF
Soils Engineer
St. Louis District
Corps of Engineers

James T. Louelaro
for DENNIS A WOODRUFF
Hydraulic Engineer
St. Louis District
Corps of Engineers

Chien H. Hsieh
CHIEN H. HSIEH
Hydraulic Engineer
St. Louis District
Corps of Engineers

SUBMITTED BY: Paul R. Umani 26 Sept 78
Chief, Engineering Division Date

APPROVED BY: Sam E. Kelly 26 Sep 1978
Colonel, CE, District Engineer Date



HICKORY HILLS COUNTRY CLUB DAM -
LAKE OVERVIEW

PHASE I INSPECTION REPORT
NATIONAL DAM SAFETY PROGRAM
NO NAME NO. 235 DAM - ID NO. 30403

TABLE OF CONTENTS

<u>Paragraph No.</u>	<u>Title</u>	<u>Page No.</u>
SECTION 1 - PROJECT INFORMATION		
1.1	General	1
1.2	Description of Project	1
1.3	Pertinent Data	2
SECTION 2 - ENGINEERING DATA		
2.1	Design	5
2.2	Construction	5
2.3	Operation	5
2.4	Evaluation	5
SECTION 3 - VISUAL INSPECTION		
3.1	Findings	6
3.2	Evaluation	7
SECTION 4 - OPERATIONAL PROCEDURES		
4.1	Procedures	8
4.2	Maintenance of Dam	8
4.3	Maintenance of Operating Facilities	8
4.4	Description of Any Warning System in Effect	8
4.5	Evaluation	8
SECTION 5 - HYDRAULIC/HYDROLOGIC		
5.1	Evaluation of Features	9
SECTION 6 - STRUCTURAL STABILITY		
6.1	Evaluation of Structural Stability	10
SECTION 7 - ASSESSMENT/REMEDIAL MEASURES		
7.1	Dam Assessment	11
7.2	Remedial Measures	11
APPENDIX		
A	Hydrologic and Hydraulic Analysis Methodology	

LIST OF PLATES

Plate No.

- 1 Location Map
- 2 Vicinity Topography
- 3 Plan
- 4 Profile and Cross Section

LIST OF PHOTOGRAPHS

Photograph No.

Title

- 1 Hickory Hills Golf Club Dam - Marsh Area and Sewage Lagoon
(Dam at left)
- 2 Hickory Hills Golf Club Dam - Dam from left abutment
- 3 Hickory Hills Golf Club Dam - Downstream Lagoon, Dam in
rear
- 4 Hickory Hills Golf Club Dam - Downstream toe; dam in
background
- 5 Hickory Hills Golf Club Dam - Spillway
- 6 Hickory Hills Golf Club Dam - Spillway and Dam
- 7 Hickory Hills Golf Club Dam - Dam Crown

PHASE I INSPECTION REPORT
NATIONAL DAM SAFETY PROGRAM
NO NAME NO. 235 DAM - ID NO. 30403

SECTION 1 - PROJECT INFORMATION

1.1 GENERAL

a. Authority. The National Dam Inspection Act, Public Law 92-367, authorized the Secretary of the Army, through the Corps of Engineers, to initiate a program of safety inspection of dams throughout the United States. Pursuant to the above, the St. Louis District, Corps of Engineers, District Engineer directed that a safety inspection of the No Name No. 235 Dam be made.

b. Purpose of Inspection. The purpose of the inspection was to make an assessment of the general condition of the dam with respect to safety, based upon available data and visual inspection, in order to determine if the dam poses hazards to human life or property.

c. Evaluation Criteria. Criteria used to evaluate the dam were furnished by the Department of the Army, Office of the Chief of Engineers, in "Recommended Guidelines for Safety Inspection of Dams." These guidelines were developed with the help of several Federal agencies and many state agencies, professional engineering organizations, and private engineers.

1.2 DESCRIPTION OF PROJECT

a. Description of Dam and Appurtenances.

(1) The Hickory Hills Dam is an earth fill dam.

(2) The spillway, located on the left abutment, consists of a horizontal 12-inch diameter, cast iron, overflow pipe. The pipe is 6 feet long and is the primary means of discharge for low flows. An emergency spillway, located at the top of the pipe, consists essentially of low ground approximately 20 feet wide. No controls were found for regulating higher flows. No low level outlet was found. Three retention ponds (abandoned sewage lagoons) are immediately downstream.

b. Location: Section 33, Township 40 North, Range 4 East.

c. Size Classification: Small.

- d. Hazard Classification: High
- e. Ownership. Hickory Hills Golf Club, DeSoto, Missouri
- f. Purpose of Dam. Water hazard for golf course and water supply for watering greens.
- g. Design and Construction History. The dam was built in the mid-1960's. No preconstruction design information or detailed construction data are known to exist.
- h. Normal Operating Procedure. No operating records exist. Outflow passes over an uncontrolled spillway.

1.3 PERTINENT DATA

- a. Drainage Area - 30 acres
26 acres (Topographic Quadrangle, 1960)
- b. Discharge at Damsite.
 - (1) Horizontal overflow pipe - flowing full - 2.4 cfs.
 - (2) Emergency spillway - Estimated experienced maximum flood - approximately 1 foot above overflow pipe.
- c. Elevation (Feet Above M.S.L.).^{1/}
 - (1) Top of dam - 680.0 \pm (Existing)
 - (2) Invert of overflow pipe at spillway - 678.9
 - (3) Spillway crest - 678.9 \pm (Existing)
 - (4) Streambed at Centerline of Dam - 658.3 \pm
 - (5) Downstream Elevation of Water Surface in Abandoned Sewage Lagoons/Ponds -
 - a. Pond No. 1 - 659.49
 - b. Pond No. 2 - 658.30
 - c. Pond No. 3 - 659.24

^{1/} Elevations based on arbitrary reference datum of 680.0 feet msl at Station 0+00.

d. Reservoir. Length of maximum pool - 500 \pm feet (1960
Topo maps)

e. Storage.

(1) Normal - 19 acre-feet

(2) Maximum - 24 acre-feet

f. Reservoir Surface Area (Acres).

(1) Top of dam - 2.76

(2) Spillway crest - 2.75

(3) Invert of horizontal overflow pipe - 2.75

g. Dam.

Type - earth fill.

Length - 385 \pm feet.

Height - 25.0 \pm feet $\frac{1}{2}$

Top width - 10 \pm feet.

Side Slope -

(a) Downstream: 1V on 1H

(b) Upstream: Unknown

Zoning - unknown.

Impervious Core - unknown.

Cutoff - unknown.

h. Emergency Spillway.

(1) Type - Uncontrolled horizontal 12-inch diameter cast iron
pipe.

(2) Pipe length - 6 \pm feet

(3) Invert of pipe at lakeside: 678.9 ± feet msl.

(4) Crest Elevation: 678.9 ± feet msl.

1/ Height from top of dam to toe located beneath abandoned downstream sewage lagoon.

SECTION 2 - ENGINEERING DATA

2.1 DESIGN.

No design drawings or data are known to exist.

2.2 CONSTRUCTION. The dam was constructed in the mid-1960's. No detailed information was found to be available.

2.3 OPERATION.

No operating records exist.

2.4 EVALUATION.

- a. Availability. There are no engineering data available.
- b. Adequacy. The field surveys and visual inspections presented herein are considered adequate to support the conclusion of this report. Seepage and stability analyses comparable to the requirements of the guidelines are not on record. This is a deficiency which should be rectified.
- c. Validity. Not Applicable.

SECTION 3 - VISUAL INSPECTION

3.1 FINDINGS

a. General. The country club manager met briefly with the team during the inspection. The lake serves as a water hazard for the golf course in which it is located. Three abandoned sewage lagoons are present adjacent to the downstream toe of the dam.

b. Project Geology. The reservoir area is characterized by residual brown and red sandy plastic clays. No rock outcrops were observed. The underlying bedrock is mapped as sedimentary rocks of Ordovician Age, Jefferson City and/or Roubidoux formations.

c. Dam. The dam is extremely overgrown with vegetation. Large willows are present along the entire upstream face; the downstream face is covered with trees, thick brush, and vines. The crown is bare earth and is used as a golf cart path.

No detrimental settlement, depressions, cracking, sinkholes, erosion, animal burrows, or slope instability was observed in or near the embankment. However, such features could be present under the vegetation and not visible. The LV on LH slope measured on the downstream slope is excessively steep and long-term stability cannot be assured.

Seepage and marshy conditions were observed over extensive areas at and below the dam toe. Downstream of the right abutment and downstream of the dam near the left abutment were large (over 100 feet square) marshes covered with cattails. At one location which could be reached through the brush, the embankment was soft and wet a few feet above the toe of the dam, indicating through-seepage. No concentrations of seepage were noted but slow oozing of water was occurring over the general area. Inspection of the outlet ditch downstream of the sewage lagoons disclosed small but perceptible flow.

The dam has very little (less than 2 feet) of freeboard and no riprap or other wave erosion protection on the upstream face. The thick vegetation presently provide some erosion protection.

d. Appurtenant Structures. The spillway consists of a shallow swale in the left abutment with a 12-inch steel pipe underneath. No erosion protection is provided. A pump in the lake near the dam was found to provide water for adjacent golf greens. A small depression in the dam crown revealed a broken 2-inch plastic

pipe just below the surface which is apparently part of the green watering system. No other appurtenant structures are a part of this dam.

e. Reservoir Area. No pertinent problems were noted in the reservoir area except that, being a golf course, the watershed consists mainly of short, mowed grass, allowing very rapid storm runoff.

f. Downstream Channels. Flow from the spillway swale generally flows across a broad fairway. Except for a small (2 foot +) ravine, no exit channel exists.

3.2 EVALUATION. The extremely dense vegetative cover made a thorough inspection impractical. The vegetation is a potential seepage hazard and encourages animal burrows. Burrows and other deficiencies may be present and not visible. Although no slope instability was detected, the downstream slope is excessively steep and its long-term stability cannot be assured. Existing seepage and marshy condition, if left uncontrolled, may adversely affect the stability of the dam. Erosion resistance of the upstream face of the dam would be inadequate if vegetation were removed as recommended. The spillway has inadequate erosion resistance for sustained flows. All of the above are deficiencies which should be corrected; however, vegetative growth is of such size and extent that removal should be attempted only under the direction of and with observation by, an engineer experienced in the design and construction of dams. Indiscriminate clearing could create an unsafe condition.

SECTION 4 - OPERATIONAL PROCEDURES

4.1 PROCEDURES.

The spillway is uncontrolled; therefore, no regulating procedures exist for this structure.

4.2 MAINTENANCE OF DAM.

The dam embankment is poorly maintained if maintained at all.

4.3 MAINTENANCE OF OPERATING FACILITIES.

Not applicable.

4.4 DESCRIPTION OF ANY WARNING SYSTEM IN EFFECT.

The inspection team is not aware of any existing warning system for this dam.

4.5 EVALUATION.

The large trees on the dam, brush, seepage, and marshy conditions are serious deficiencies which should be corrected; however, these should only be accomplished under the direction of an experienced engineer to avoid creating an unsafe condition.

SECTION 5 - HYDRAULIC/HYDROLOGIC

5.1 EVALUATION OF FEATURES.

a. Design Data. There were no hydraulic and hydrological design data available as discussed in Section 2.

b. Experience Data. The drainage area was developed using USGS Quadrangle sheet. The lake surface area was determined by planimetry on Orthophotoquad sheet by the USGS (1975). Surface area-elevations curves were determined by planimetry various contour lines within the drainage area on the USGS Quadrangle sheets. The spillway and dam layout was made from surveys conducted by the inspecting team.

c. Visual Observations. The spillway in the left abutment consists of a horizontal overflow pipe overlaid with gravel to act as an access road to the top of the dam. The width of the spillway is approximately 20 feet.

d. Overtopping Potential.

The emergency spillway for No Name No. 235 has been found inadequate to pass the Probable Maximum Flood (PMF), one-half PMF or the 1 percent chance flood without overtopping. The probable maximum flood is defined as the flood discharge that may be expected from the most severe combination of critical meteorologic and hydrologic conditions that are reasonably possible in the region. The spillway will pass approximately 10 percent of the PMF without overtopping. For the PMF and one-half PMF, the dam would be overtopped 0.8 feet and 0.5 feet for 11.1 hours and 6.8 hours with a discharge of 600 cfs and 300 cfs, respectively.

The effect from rupture of the dam could extend approximately one mile downstream of the dam. There are several homes and the incorporated area of DeSoto, Missouri downstream of the dam which could be severely damaged, and lives lost, should failure occur.

SECTION 6 - STRUCTURAL STABILITY

6.1 EVALUATION OF STRUCTURAL STABILITY.

a. Visual Observations. Visual observations which adversely affect the structural stability of this dam are discussed in Section 3.

b. Design and Construction Data. No design or construction data relating to the structural stability of the dam were found.

c. Operating Records. No appurtenant structures requiring operation exist at this dam. Seepage and stability analyses comparable to the requirements of the guidelines are not on record. This is a deficiency which should be rectified.

d. Post Construction Changes. No post-construction changes are known or apparent.

e. Seismic Stability. The dam is in seismic zone 2, to which the guidelines assign a "moderate" damage potential. The low height and clayey materials of this dam minimize the likelihood of failure due to earthquake.

SECTION 7 - ASSESSMENT/REMEDIAL MEASURES

7.1 DAM ASSESSMENT.

a. Safety. Several items are deficient which should be corrected. These items are steep slopes (1V on 1H), vegetative cover, seepage, insufficient erosion protection for the dam and spillway, and inadequate spillway capacity.

b. Adequacy of Information. Lack of stability and seepage analysis as recommended by the guidelines is a deficiency which should be corrected.

c. Urgency. The deficiencies described herein are serious and corrective actions listed below should be initiated in the very near future.

d. Need for Phase II. No Phase II inspection is recommended. Action should be initiated on the remedial measures recommended.

7.2 REMEDIAL MEASURES.

The following remedial measures are recommended:

a. Remove trees, brush and vines on the embankment. However, growth is of such size and magnitude that this and all following actions should be done only under the direction of an engineer experienced in the design and construction of dams. Indiscriminate clearing could create an unsafe condition.

b. After clearing the dam, further inspection should be made.

c. Fill any animal burrows found during clearing and establish a turf cover.

d. Provide an erosion resistant upstream face and/or increase freeboard.

e. Spillway capacity and/or height of the dam should be increased to pass 50 percent of the Probable Maximum Flood.

f. Erosion protection for the spillway should be provided.

g. Seepage should be stopped or controlled to allow drainage and pressure relief in a safe manner. Seepage control works should be based on appropriate seepage analysis.

h. The dam should be periodically inspected by an experienced engineer and records kept of these inspections and maintenance.

i. Stability and seepage analyses should be performed by a professional engineer experienced in the design and construction of dams.

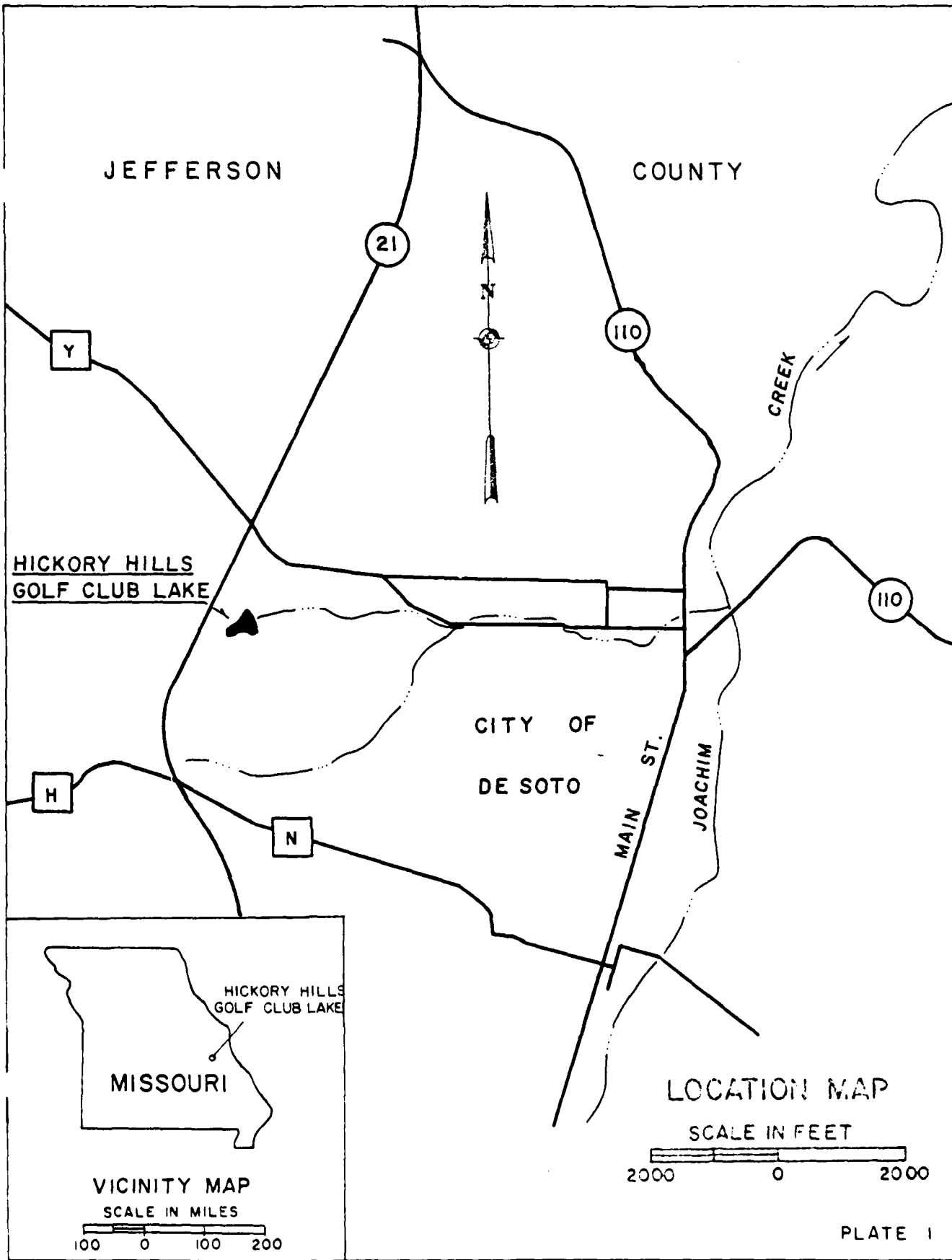

HICKORY HILLS
GOLF CLUB LAKE

JEFFERSON

COUNTY

CITY OF
DE SOTO

MAIN ST.
JOACHIM

CREEK

Y

21

110

110

H

N



HICKORY HILLS
GOLF CLUB LAKE

MISSOURI

VICINITY MAP
SCALE IN MILES

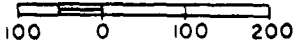

LOCATION MAP

SCALE IN FEET

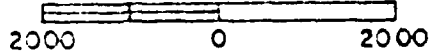
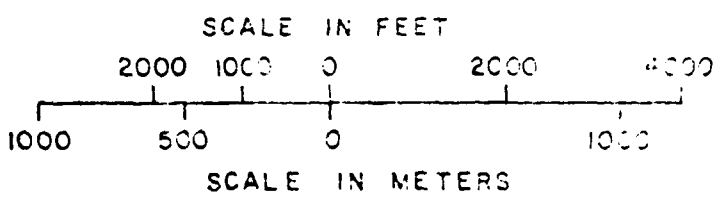
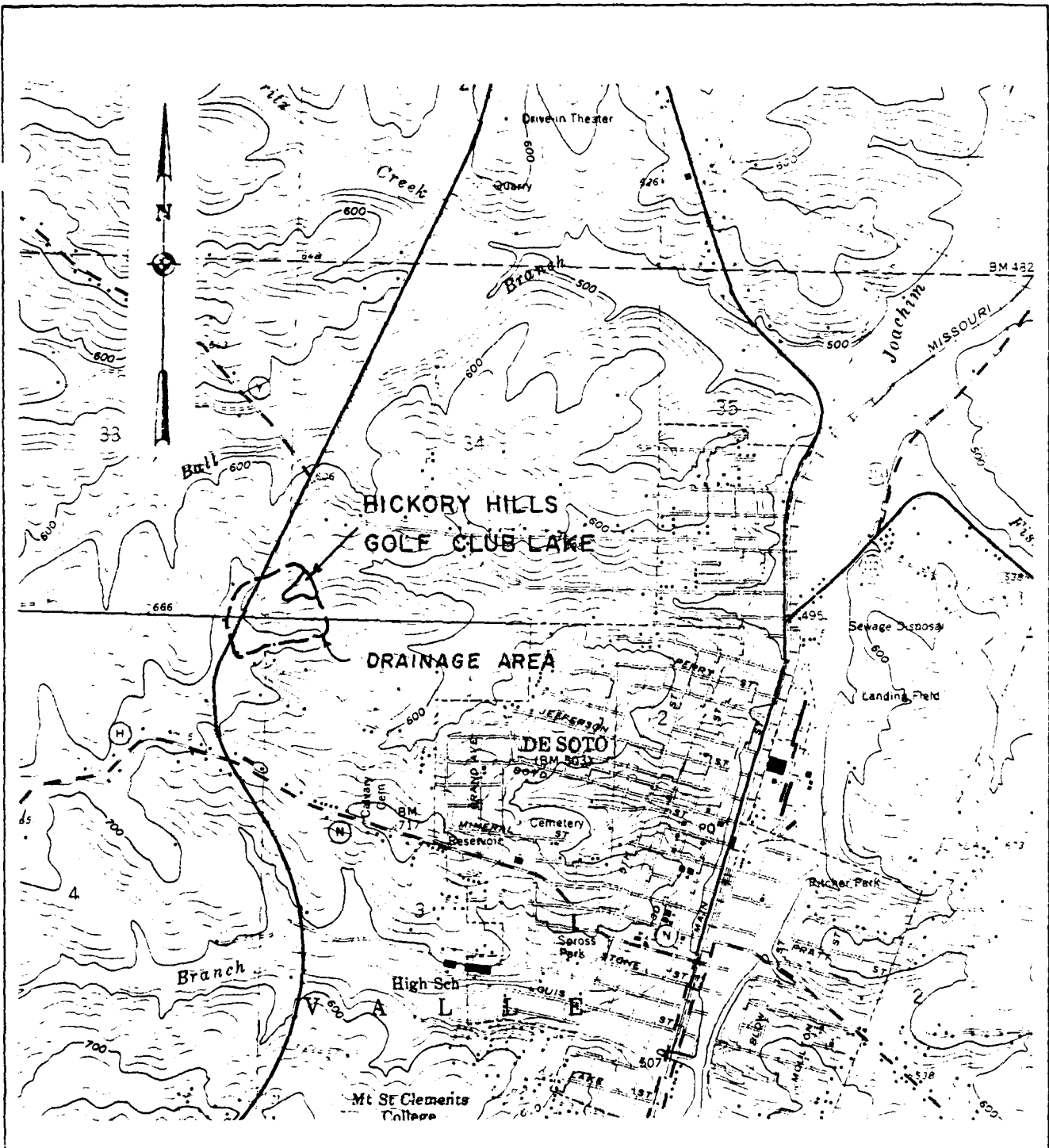
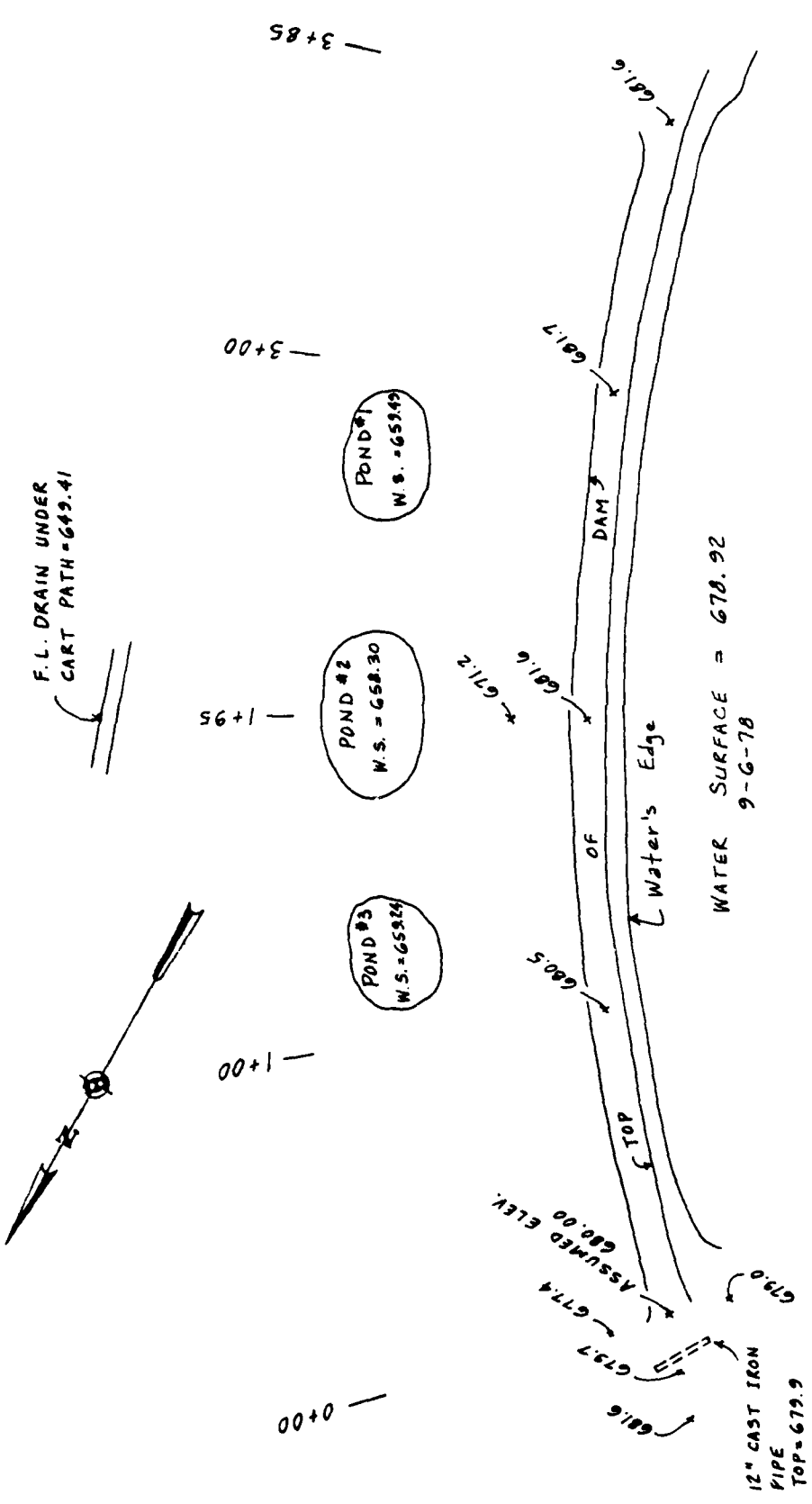

PLATE 1



HICKORY HILLS
 GOLF CLUB LAKE
 VICINITY TOPOGRAPHY
 PLATE 2



HICKORY HILLS
GOLF CLUB LAKE DAM

PLAN

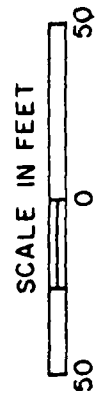

PLATE 3

LAKE

WATER SURFACE = 678.92
9-G-78

12" CAST IRON
PIPE
TOP = 679.9
F.L. = 678.9

ASSUMED ELEV.
680.00

F.L. DRAIN UNDER
CART PATH = 649.41

POND #1
W.S. = 653.95

POND #2
W.S. = 658.30

POND #3
W.S. = 653.24

Water's Edge

OF

TOP

DAM 3

0+00

1+00

1+95

3+00

3+85

671.2

681.6

680.5

681.7

681.6

681.6

679.7

677.4

679.0

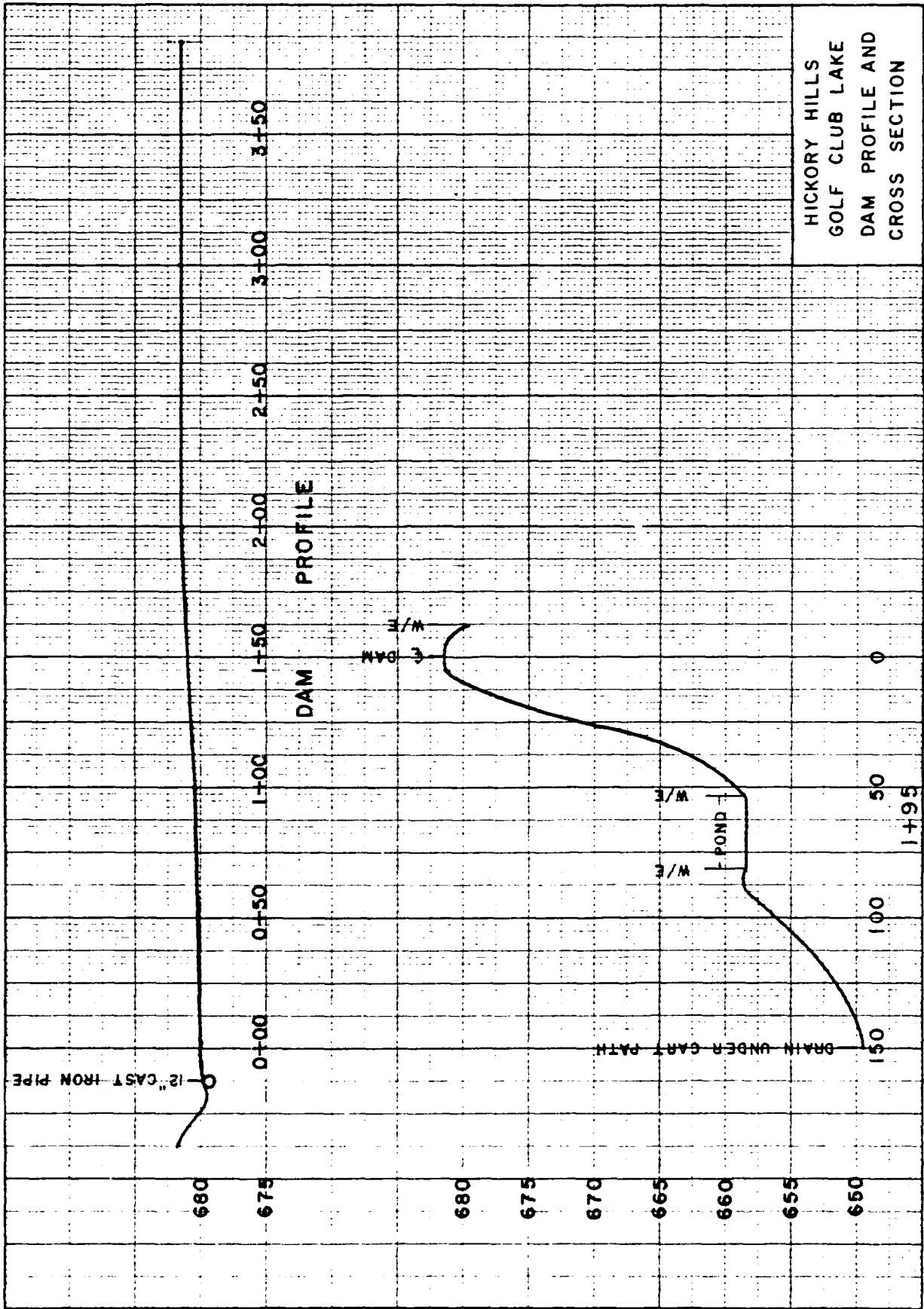

HICKORY HILLS
GOLF CLUB LAKE
DAM PROFILE AND
CROSS SECTION



PHOTO No. 1 Hickory Hills Country
Club Dam - Marsh area and
Sewage Lagoon (Dam at
left)



PHOTO No. 2 Hickory Hills Country
Club Dam - Dam from Left
Abutment



PHOTO No. 3 Hickory Hills Country
Club Dam - Downstream
Lagoon, Dam in Rear



PHOTO No. 4 Hickory Hills Country
Club Dam - Downstream toe;
Dam in Background



PHOTO No. 5 Hickory Hills Country
Club Dam - Spillway



PHOTO No. 6 Hickory Hills Country
Club Dam - Spillway and
Dam



PHOTO NO. 7 Hickory Hills Country
Club Dam - Dam Crown

APPENDIX A
HYDROLOGIC AND HYDRAULIC ANALYSIS METHODOLOGY

HYDROLOGIC AND HYDRAULIC ANALYSIS METHODOLOGY

1. The hydrologic analysis used in development of the overtopping potential is based on applying a hypothetical storm to a unit hydrograph to obtain the inflow hydrograph for a reservoir routing. The Probable Maximum Precipitation is derived and determined from regional charts prepared by the National Weather Service in "Hydrometeorological Report No. 33." Reduction factors have not been applied. A 24-hour storm duration is assumed with the total rainfall depth distributed over 6-hour periods in accordance with procedures outlined in EM 1110-2-1411 (SPF Determination). The maximum 6-hour rainfall period is then distributed to hourly increments by the same criteria. Within-the-hour distribution is based upon NOAA Technical Memorandum NWS HYDRO-35. The non-peak 6-hour rainfall periods are distributed uniformly. All distributed values are arranged in a critical sequence by the SPF criteria. The final inflow hydrograph is produced by deduction of infiltration losses appropriate to the soil, land use, and antecedent moisture conditions.
2. The reservoir routing is accomplished by using Modified Puls routing techniques wherein the flood hydrograph is routed through lake storage. Hydraulic capacities of the outlet works, spillway, and crest of dam are used as outlet controls in the routing. Storage in the pool area is defined by an elevation-storage capacity curve. The hydraulic capacity of the outlet works, spillway, and top of dam are defined by elevation-discharge curves.
3. Dam overtopping analysis has been conducted by hydrologic methods for this dam and lake. This computation determines the percentage of the PMF hydrograph that the reservoir can contain without the dam being overtopped. An output summary in the hydrologic appendix displays this information as well as other characteristics of the simulated dam overtopping.
4. The above methodology has been accomplished for this report using the systemized computer program HEC-1 (Dam Safety Version), July 1978, prepared by the Hydrologic Engineering Center, U.S. Army Corps of Engineers, Davis, California. The numeric parameters estimated for this site are listed in the attached computer printout. Definitions of these variables are contained in the "User's Manual" for the computer program.
5. The inflow hydrograph was routed through the reservoir using HEC-1's Modified Puls option. Releases were calculated for: 1) the horizontal overflow pipe assuming the pipe was flowing full; and 2) the spillway and dam not including flow through the 12-inch CIP. Finally, both releases were combined at each of their respective elevations.

Flow through the pipe was obtained using a hydraulic design chart selected from the U. S. Department of Transportation, FHA, "Hydraulic Charts for the Selection of Highway Culverts," prepared by Lester A. Herr. Assumed information was:

$D = 12$ inches

$HW/D = 1.0$

Scale (1)

Q determined was 2.4 cfs.

Flow over the spillway and dam was calculated using the weir flow equation:

$Q = CLH^{1.5}$

where: $C = 3.0$

$L =$ Length in feet (varies with water surface)

$H =$ Head of water in feet (varies with water surface)

$Q =$ Discharge in cfs

PAP INSPECTION PROGRAM - 7/20/78 - 500 - 10-11
 TO PART LATE 7235 - SCS HYDROGRAPHS - 5 MINUTE INTERVALS
 FUGLEAF FAVORITE FLOOD

288	3	0	-5
J1	9	1	1.0
J2	.20	.25	.40
K1	1	.30	.45
K2	1	.35	.50
L1	.04	.40	.55
L2	1.02	.45	.60
M1	120	.50	.65
M2	130	.55	.70
N1	.066	.60	.75
N2	3.0	.70	.80
O1	2	.75	.85
O2	3	.80	.90
P1	1	.85	.95
P2	1	.90	1.0
Q1	1	.95	1.0
Q2	1	1.0	1.0
R1	1	1.0	1.0
R2	1	1.0	1.0
S1	1	1.0	1.0
S2	1	1.0	1.0
T1	1	1.0	1.0
T2	1	1.0	1.0
U1	1	1.0	1.0
U2	1	1.0	1.0
V1	1	1.0	1.0
V2	1	1.0	1.0
W1	1	1.0	1.0
W2	1	1.0	1.0
X1	1	1.0	1.0
X2	1	1.0	1.0
Y1	1	1.0	1.0
Y2	1	1.0	1.0
Z1	1	1.0	1.0
Z2	1	1.0	1.0

RESERVOIR ROUTING BY MODIFIED PULS

Y4	678.0	679.9	680	680.5	681	681.5	681.6	-1
Y5	0	4.3	12.3	26.0	776.1	1618	1825.2	
SA	0	2.7	3.67	9.18	14.96	15.61		
SE	658.3	678.0	690	700	710	720		
S5	678.9							
SD	680							
E	99							
A								
A								
A								
A								
A								
A								
L01								
E2								

COMPUTER INPUT DATA

Summary of Dam Safety Analysis

Ratio	Condition	Maximum	Minimum	Duration	Time of	Time of
PF	Reservoir	Storage	Storage	Over Top	Failure	Failure
	Level	AC-FT	AC-FT	Hours	Hours	Hours
1.00	680.05	77.	77.	39.	15.75	0.00
.20	680.20	73.	73.	4.00	15.67	0.00
.25	680.26	73.	73.	4.92	15.67	0.00
.30	680.32	73.	73.	5.30	15.67	0.00
.35	680.37	73.	73.	5.92	15.67	0.00
.40	680.43	73.	73.	6.33	15.67	0.00
.45	680.49	73.	73.	6.20	15.67	0.00
.50	680.55	73.	73.	6.75	15.67	0.00
1.00	680.84	74.	74.	11.08	15.67	0.00

 FLOOD HYDROGRAPH PACKAGE (HEC-1)
 DAM SAFETY ANALYSIS JULY 1978
 ANALYSIS PERFORMED 29 AUG 78

P. 1
 P. 2
 P. 3

COMPUTER SUMMARY ANALYSIS

REGRESSION DATA

FILE INCREMENT 0.0000 (NO IS 01 LAG/7)

UNIT HYDROGRAPH 6 LAGS OF PERIOD ORDINATES, TC= 0.00 HOURS, LAG= 0.00 VOL= 1.00

NO	PERIOD	PERIOD	FAIR	TYCE	LOSS	REP-OF-PERIOD FLOW	CO-EFF	PERCE	PERIOD	FAIR	LOSS	CO-EFF
1.01	05	1	.01	0.00	.01	0.	1.01	12.05	145	.22	.00	49.
1.01	10	2	.01	0.00	.01	0.	1.01	12.10	140	.22	.00	61.
1.01	15	3	.01	0.00	.01	0.	1.01	12.15	147	.22	.00	52.
1.01	20	4	.01	0.00	.01	0.	1.01	12.20	148	.22	.00	67.
1.01	25	5	.01	0.00	.01	0.	1.01	12.25	149	.22	.00	67.
1.01	30	6	.01	0.00	.01	0.	1.01	12.30	150	.22	.00	67.
1.01	35	7	.01	0.00	.01	0.	1.01	12.35	151	.22	.00	67.
1.01	40	8	.01	0.00	.01	0.	1.01	12.40	152	.22	.00	67.
1.01	45	9	.01	0.00	.01	0.	1.01	12.45	153	.22	.00	67.
1.01	50	10	.01	0.00	.01	0.	1.01	12.50	154	.22	.00	67.
1.01	55	11	.01	0.00	.01	0.	1.01	12.55	155	.22	.00	68.
1.01	60	12	.01	0.00	.01	0.	1.01	13.00	156	.22	.00	68.
1.01	65	13	.01	0.00	.01	0.	1.01	13.05	157	.21	.00	75.
1.01	70	14	.01	0.00	.01	0.	1.01	13.10	158	.21	.00	79.
1.01	75	15	.01	0.00	.01	0.	1.01	13.15	159	.21	.00	81.
1.01	80	16	.01	0.00	.01	0.	1.01	13.20	160	.21	.00	81.
1.01	85	17	.01	0.00	.01	0.	1.01	13.25	161	.21	.00	81.
1.01	90	18	.01	0.00	.01	0.	1.01	13.30	162	.21	.00	81.
1.01	95	19	.01	0.00	.01	0.	1.01	13.35	163	.21	.00	81.
1.01	100	20	.01	0.00	.01	1.	1.01	13.40	164	.21	.00	81.
1.01	105	21	.01	0.00	.01	1.	1.01	13.45	165	.21	.00	81.
1.01	110	22	.01	0.00	.01	1.	1.01	13.50	166	.21	.00	81.
1.01	115	23	.01	0.00	.01	1.	1.01	13.55	167	.21	.00	82.
1.01	120	24	.01	0.00	.01	1.	1.01	14.00	168	.21	.00	82.
1.01	125	25	.01	0.00	.01	1.	1.01	14.05	169	.33	.00	92.
1.01	130	26	.01	0.00	.01	1.	1.01	14.10	170	.33	.00	99.
1.01	135	27	.01	0.00	.01	1.	1.01	14.15	171	.33	.00	101.
1.01	140	28	.01	0.00	.01	1.	1.01	14.20	172	.33	.00	102.
1.01	145	29	.01	0.00	.01	1.	1.01	14.25	173	.33	.00	102.
1.01	150	30	.01	0.00	.01	1.	1.01	14.30	174	.33	.00	102.
1.01	155	31	.01	0.00	.01	2.	1.01	14.35	175	.33	.00	102.
1.01	160	32	.01	0.00	.01	2.	1.01	14.40	176	.33	.00	102.
1.01	165	33	.01	0.00	.01	2.	1.01	14.45	177	.33	.00	102.
1.01	170	34	.01	0.00	.01	2.	1.01	14.50	178	.33	.00	102.
1.01	175	35	.01	0.00	.01	2.	1.01	14.55	179	.33	.00	102.
1.01	180	36	.01	0.00	.01	2.	1.01	15.00	180	.33	.00	102.
1.01	185	37	.01	0.00	.01	2.	1.01	15.05	181	.20	.00	67.
1.01	190	38	.01	0.00	.01	2.	1.01	15.10	182	.60	.00	99.
1.01	195	39	.01	0.00	.01	2.	1.01	15.15	183	.60	.00	118.
1.01	200	40	.01	0.00	.01	2.	1.01	15.20	184	.60	.00	156.
1.01	205	41	.01	0.00	.01	2.	1.01	15.25	185	.71	.00	196.
1.01	210	42	.01	0.00	.01	2.	1.01	15.30	186	.60	.00	371.
1.01	215	43	.01	0.00	.01	2.	1.01	15.35	187	2.17	.00	661.
1.01	220	44	.01	0.00	.01	2.	1.01	15.40	188	1.11	.00	533.
1.01	225	45	.01	0.00	.01	2.	1.01	15.45	189	.71	.00	738.
1.01	230	46	.01	0.00	.01	2.	1.01	15.50	190	.60	.00	234.
1.01	235	47	.01	0.00	.01	2.	1.01	15.55	191	.60	.00	167.

INPUT UNIT HYDROGRAPH

**LATE
LME**