

02524



**U.S. Army  
Environmental  
Center**

**NO FURTHER ACTION UNDER  
COMPREHENSIVE ENVIRONMENTAL  
RESPONSE, COMPENSATION,  
AND LIABILITY ACT  
STUDY AREA P19  
CLEARING, TRACKED ROAD**

**FINAL DOCUMENT**

**CONTRACT DAAA15-90-D-0019**

**U.S. ARMY ENVIRONMENTAL CENTER  
ABERDEEN PROVING GROUND, MARYLAND**

**19960401 129**

**APRIL 1995**

*PRINTED ON RECYCLED PAPER*

**DISTRIBUTION STATEMENT A**

**Approved for public release;  
Distribution Unlimited**

**DTIC QUALITY INSPECTED 1**

# DISCLAIMER NOTICE

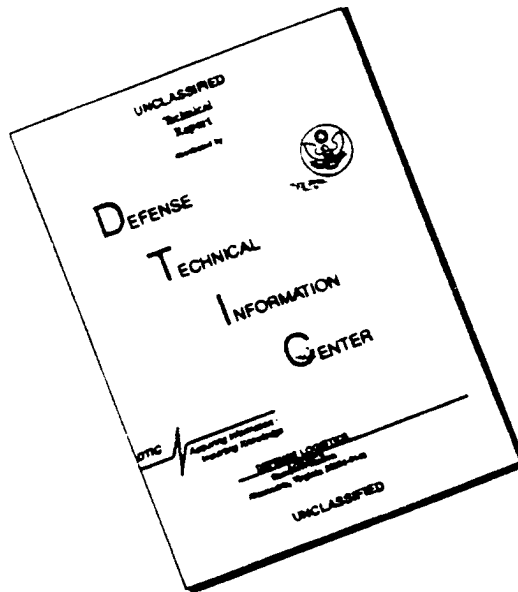

THIS DOCUMENT IS BEST QUALITY AVAILABLE. THE COPY FURNISHED TO DTIC CONTAINED A SIGNIFICANT NUMBER OF PAGES WHICH DO NOT REPRODUCE LEGIBLY.

# REPORT DOCUMENTATION PAGE

Form Approved  
OMB No. 0704-0188

Public reporting burden for this collection of information is estimated to average 1 hour per response, including the time for reviewing instructions, searching existing data sources, gathering and maintaining the data needed, and completing and reviewing the collection of information. Send comments regarding this burden estimate or any other aspect of this collection of information, including suggestions for reducing this burden, to Washington Headquarters Service, Directorate for Information Operations and Reports, 1215 Jefferson Davis Highway, Suite 1204, Arlington, VA 22202-4302, and to the Office of Management and Budget, Paperwork Reduction Project (0704-0188), Washington, DC 20503.

1. AGENCY USE ONLY (Leave blank)		2. REPORT DATE 4/12/95	3. REPORT TYPE AND DATES COVERED Final No Further Action Decision Document	
4. TITLE AND SUBTITLE No Further Action Decision Document for Study Area P19, Clearing, Tracked Road, Fort Devens Sudbury Training Annex			5. FUNDING NUMBERS  C	
6. AUTHOR(S) Noel Novak-Schulz OHM Remediation Services Corp.			8. PERFORMING ORGANIZATION REPORT NUMBER DAAA15-90-D-0019 Task Order No. DA06 OHM Project No.14316	
7. PERFORMING ORGANIZATION NAME(S) AND ADDRESS(ES) OHM Remediation Services Corp. 200 Horizon Center Blvd. Trenton, New Jersey 08691-1904			10. SPONSORING/MONITORING AGENCY REPORT NUMBER  SFIM-AEC-IR-CR-95015	
9. SPONSORING/MONITORING AGENCY NAME(S) AND ADDRESS(ES) United States Army Environmental Center Aberdeen Proving Ground, MD 21010-5401			11. SUPPLEMENTARY NOTES  This report is a revision of a draft final report issued in February 1995.	
12a. DISTRIBUTION/AVAILABILITY STATEMENT Approved for public release; distribution is unlimited.			12b. DISTRIBUTION CODE	
13. ABSTRACT (Maximum 200 words) This report is a Final No Further Action Decision Document for Study Area P19, Clearing, Tracked Road at the Fort Devens Sudbury Training Annex located in Sudbury, Massachusetts. This NFADD explains why no further investigation or remediation is required at Area P19. The NFADD provides a review of the site reconnaissance and soil sampling results to applicable human health and ecological standards.				
14. SUBJECT TERMS No Further Action CERCLA (Superfund) Sudbury Training Annex			15. NUMBER OF PAGES	
17. SECURITY CLASSIFICATION OF REPORT unclassified			16. PRICE CODE NA	
18. SECURITY CLASSIFICATION OF THIS PAGE unclassified		19. SECURITY CLASSIFICATION OF ABSTRACT unclassified		20. LIMITATION OF ABSTRACT SAR

NSN 7540-01-280-3500

Standard Form 298 (Rev. 2-89)  
Prescribed by ANSI Std. Z39-18  
298-102

## TABLE OF CONTENTS

<u>SECTION</u>	<u>PAGE</u>
LIST OF TABLES AND FIGURES .....	ii
GLOSSARY OF ACRONYMS AND ABBREVIATIONS .....	iii
EXECUTIVE SUMMARY .....	ES-1
1.0 INTRODUCTION .....	1-1
2.0 BACKGROUND AND PHYSICAL SETTING .....	2-1
2.1 DESCRIPTION AND LAND USE .....	2-2
2.2 CLIMATE .....	2-2
2.3 REGIONAL GEOLOGY AND HYDROGEOLOGY .....	2-3
2.4 STUDY AREA DESCRIPTION AND HISTORY .....	2-6
2.5 RELATED INVESTIGATIONS .....	2-6
3.0 AREA-SPECIFIC CHARACTERISTICS .....	3-1
4.0 CONTAMINATION ASSESSMENT .....	4-1
5.0 PRELIMINARY RISK EVALUATION .....	5-1
6.0 CONCLUSIONS .....	6-1
7.0 DECISION .....	7-1
8.0 REFERENCES .....	8-1

LIST OF TABLES

<u>TABLE NO.</u>	<u>TITLE</u>
4-1	Phase II Soil/ Drum Detections

LIST OF FIGURES

<u>FIGURE NO.</u>	<u>TITLE</u>
2-1	Site Map
3-1	Study Area P19 - Site Plan
4-1	Phase II Sample Location

## GLOSSARY OF ACRONYMS AND ABBREVIATIONS

AMSL	- Above Mean Sea Level
Annex	- Fort Devens Sudbury Training Annex
BGS	- Below Ground Surface
CERCLA	- Comprehensive Environmental Response, Compensation, and Liability Act of 1980
CFHA	- Capehart Family Housing Area
CX	- Categorical exclusion
DOD	- U.S. Department of Defense
EM	- Electromagnetics
FEMA	- Federal Emergency Management Agency
FID	- Flame Ionization Detector
IRP	- Installation Restoration Program
MEP	- Master Environmental Plan
NEPA	- National Environmental Policy Act of 1969
NFADD	- No Further Action Decision Document
OHM	- OHM Remediation Services Corp., A Wholly-Owned Subsidiary of OHM Corporation
PA/SI	- Preliminary Assessment/Site Investigation
PCBs	- Polychlorinated Biphenyls
PID	- Photoionization Detector
POL	- Petroleum, Oil, or Lubricants
QM R&E	- Quarter Master Research and Engineering

**GLOSSARY OF ACRONYMS AND ABBREVIATIONS  
(CONTINUED)**

RBC	- USEPA Region III Risk-based Concentration
ROTC	- Reserve Officer Training Corps
SARA	- Superfund Amendments and Reauthorization Act of 1986
SI	- Site Investigation
SI/RI	- Site Investigation/Remedial Investigation
SM	- Scanning Magnetometry
SMCLs	- Safe Drinking Water Act National Secondary Drinking Water Standards
TAL	- Target Analyte List
TCL	- Target Compound List
USAF	- U.S. Air Force
USAEC	- U.S. Army Environmental Center
USATHAMA	- U.S. Army Toxic and Hazardous Materials Agency
USEPA	- U.S. Environmental Protection Agency
USGS	- U.S. Geological Survey
µg/g	- Micrograms per gram
µg/l	- Micrograms per liter

## EXECUTIVE SUMMARY

Investigation of Area P19, Clearing, Tracked Road, at the Fort Devens Sudbury Training Annex has resulted in the decision that no further studies or remediation are required at this study area. Area P19 was identified by the USEPA in the Installation Assessment as a possible area of concern (USEPA, 1982).

The Fort Devens Training Annex was placed on the National Priorities List under the Comprehensive Environmental Response, Compensation, and Liability Act of 1980, as amended by the Superfund Amendments and Reauthorizations Act of 1986 on February 21, 1990. In accordance with these acts and the U.S. Army Installation Restoration Program, a Master Environmental Plan has been initiated and an enhanced area reconnaissance has been conducted, both of which address Area P19.

Field investigation of Area P19 was initiated between 1991 and 1992 in conjunction with the Site Investigation/Remedial Investigation of sixty-eight study areas on the Annex. The field investigation consisted of an enhanced area reconnaissance. Several pieces of wood debris, a rusted drum and scrap metal were found. An additional drum, located in the forest on the northwest edge of the area, was removed. One confirmatory sample was collected and analyzed from the drum location. No volatile organic compounds, base neutral organic compounds or organophosphorous pesticides were detected. Analytical results did not identify any signs of environmental contamination and showed metals concentrations similar to Phase I background levels for the area of 0.28 to 0.64  $\mu\text{g/g}$ .

Based on the preliminary risk evaluation at Area P19, it is concluded that no further investigation or remediation is required at this area.

## SECTION 1.0 INTRODUCTION

This decision document has been prepared to support a no further action decision at Study Area P19, Clearing, Tracked Road, at the Fort Devens Sudbury Training Annex in Middlesex County, Massachusetts. The report was prepared as part of the U.S. Department of Defense (DOD) Installation Restoration Program (IRP) to assess the nature and extent of contamination associated with site operations at the Sudbury Training Annex.

On February 21, 1990, the Sudbury Training Annex was placed on the National Priorities List under the Comprehensive Environmental Response, Compensation, and Liability Act of 1980 (CERCLA), as amended by the Superfund Amendments and Reauthorization Act of 1986 (SARA). The U.S. Army Environmental Center (USAEC), formerly the U.S. Army Toxic and Hazardous Materials Agency (USATHAMA), initiated a Master Environmental Plan (MEP) in 1991. Study Area P19 was identified in the MEP as a potential area of concern. In July 1991, DOD, through USAEC, initiated a Site Investigation/Remedial Investigation (SI/RI) for the sixty-eight areas identified by the MEP. The SI/RI was conducted by OHM Remediation Services Corp. (OHM). Study Area P19 was included in the SI/RI.

The activities involved in the OHM investigation qualified for a categorical exclusion (CX) in accordance with National Environmental Policy Act (NEPA), as amended, and did not require prior preparation of an environmental assessment or an environmental impact statement. The investigation qualified for CX following criteria set forth in Appendix A of Army Regulation 200-2.

The Sudbury Training Annex, acquired by the government in the early 1940s during World War II, is located approximately two miles north of the town of Sudbury, Massachusetts. It has historically served as a munitions holding ground, an ordnance test station, a research and development facility, and as a troop training ground. Currently, the facility contains family housing for armed services personnel, a geophysical radar station, and guest houses.

## SECTION 2.0 BACKGROUND AND PHYSICAL SETTING

The Sudbury Training Annex is located 20 miles west of Boston, 12 miles northwest of Natick, Massachusetts and 2 miles northwest of the town of Sudbury in Middlesex County, Massachusetts. The installation is located in the Maynard, Massachusetts 7½-minute United States Geological Survey (USGS) quadrangle map. Figure 2-1 presents the site map.

Military operations began at the Annex in 1942, when formal petition was filed by the United States to acquire the land by eminent domain (District Court of United States for District of Massachusetts, Misc. Civil No. 6507, March 25). Transfer of the property (3,100 acres) occurred on November 10, 1942, and initial use of the property, then known as the Maynard Ammunition Depot, was to store ammunition for subsequent shipment to the Port of Boston. The location was selected due to its strategic location (out of range of naval guns) and close proximity to four active railroad lines. Provision of safe storage of ammunition was attained by the construction of 50 earth-covered concrete bunkers located in the center of the Annex. Railroad spurs were developed to provide access between bunkers and the main railroad lines. The railroad spurs were removed in 1966 and no munitions have been stored within the Annex bunkers since 1975.

After World War II, the Maynard Ammunition Depot became known as the Maynard Ordnance Test Station, and in 1957 was acquired by the Quartermaster Research and Engineering (QM R&E) Center to relieve restrictions this command was experiencing at Natick, Massachusetts due to the continuous influx of new projects. The QM R&E used the Annex for testing various materials associated with its mission of research and development in the physical, behavioral, and biological sciences and engineering of clothing and protective equipment. Physical research and development included airdrop techniques, field shelters and equipment, field organization equipment, food, and food service systems. Scientific research and development uses included determination of the stability of various fungicides in materials exposed to outdoor environments, foamed plastics field tests, flame testing of clothing and equipment, toxic fumigant effects on insects, the study of climatic data in support of various test programs, and airdrop testing.

In 1982, custody of the entire Annex was transferred to Fort Devens, which is located 17 miles northwest of Sudbury in the town of Ayer, Massachusetts. The major mission of Fort Devens is to train active duty and reserve personnel, and to support the U.S. Army Security Agency Training Center and School, U.S. Army Reserves, National Guard, ROTC, and Air Defense sites in New England. The Annex presently supports this mission.

### 2.1 DESCRIPTION AND LAND USE

The 4.3-square-mile Annex is comprised of sections of the towns of Sudbury, Maynard, Hudson, and Stow. The installation is divided into two irregularly shaped parcels by Hudson Road. Approximately 500 acres in the northern parcel of the Annex are leased to the USAF for radar instrumentation. This facility, located near the Assabet River, is supervised by personnel from Bedford Research Laboratories. The Region One Office of FEMA leases approximately 262 acres on the northern parcel, near the East Gate. A relatively flat area on the northern parcel, consisting of approximately 30 acres, is presently used as a drop zone by the Airdrop Engineering Laboratory for testing equipment in actual parachute drops. A number of individual housing units are scattered across the northern parcel of the Annex. In the southern

parcel of the Annex, the Capehart Family Housing Area (CFHA), a military family housing area, occupies approximately 18 acres and includes a small recreational area for children.

The installation is also used by a number of local groups, including Army Reserve units, the National Guard, the Massachusetts State Police, and permitted recreational users. Because of its easy accessibility, the site is also used by unauthorized persons.

## **2.2 CLIMATE**

Site-specific meteorological data are recorded at the USAF radar installation and at the Natick Weather Station on the southern parcel of the installation. A review of meteorological data indicates moderately cold, moist winters and warm, moist summers. July is recorded as the warmest month with a mean temperature of 22.2 degrees Celsius (72 degrees Fahrenheit). Temperatures at or above 27 degrees Celsius (81 degrees Fahrenheit) generally occur between the months of June, July, and August, with the possibility of temperatures dropping below freezing during the months of December through March. Late summer to early fall months bring the possibility of hurricane-influenced weather patterns.

Annual precipitation is moderately abundant with an annual mean of 121 centimeters (44 inches) per year. Winter precipitation is usually in the form of snow with occasional ice storms. Precipitation is, for the most part, distributed evenly throughout the year. The driest months are July and October with mean precipitation of 8½ centimeters (3.3 inches), and the wettest months are March and November with mean precipitation of 12 centimeters (4.7 inches).

Summer precipitation is usually confined to short duration, high intensity thunderstorms (frontal and convective). Winds are light to moderate throughout the year.

## **2.3 REGIONAL GEOLOGY AND HYDROGEOLOGY**

### **2.3.1 Topography**

The installation lies near the western boundary of the Seaboard Lowland Section of the New England-Maritime Physiographic Province. Elevations range from 321 feet above mean sea level (AMSL) along the northern boundary of the installation to 170 feet AMSL in Marlboro Brook on the southern parcel of the installation. The topography at the Annex is dominated by broad flat plains with elevations between 190 and 200 feet AMSL. Hills are scattered throughout the Annex, with most lying in an arc along the northern boundary and concentrated in the central section of the northern parcel. Topographic trends are generally north to south. A previous investigation classified the topographic features as follows: 81 percent lowlands, 16 percent hills, and 3 percent water bodies (USATHAMA, 1980).

### **2.3.2 Bedrock Geology**

The Annex is underlain by igneous and metamorphic rocks of Pre-Cambrian(?) and Paleozoic Age. Six formations underlie the site as part of a tightly-folded, northeast-plunging asymmetrical anticline with a northeast-southwest strike. The Marlboro Formation, a fine-grained amphibolite schist (Pre-Cambrian?) is exposed on the Annex in a band extending from Vose Hill to White Pond. Two formations cross the southeast corner of the Annex: the Salem(?) gabbrodiorite and a quartz diorite facies of the Dedham granodiorite. Both formations are presumably of Devonian age. The Nashoba Formation (Carboniferous),

a light gray biotite gneiss, runs along the northern boundary of the site and underlies the extreme northwest corner of the Annex. Central and northern portions of the Annex are underlain by the Gospel Hill gneiss (Carboniferous). The Gospel Hill is a medium- to coarse-textured granite gneiss and is probably a granitized product of the Nashoba and Marlboro formations. Small bodies of the Assabet quartz diorite (Late Paleozoic?) crop out in northern portions of the site.

Bedrock across the site is closely folded with steep dips. Joints are common in the bedrock outcrops and are mostly vertical or nearly vertical. Joints at the surface were found to have a general northwestward trend. The occurrence and vertical orientation of the joints was confirmed at depth in the pilot hole near the northern boundary of the installation. All bedrock formations are dense and hard. No surface or subsurface indications of major faults were noted in the bedrock.

With the exception of widely-scattered outcrops, bedrock is covered by glacial deposits ranging in thickness from a veneer up to 120 feet. Field examination of the few outcrop locations and the results of the subsurface investigation indicated the bedrock surface to be highly irregular. Previous studies have indicated the existence of a buried bedrock valley beneath the southern parcel of the Annex and other abandoned stream channels in the area (Barnes, 1956).

### 2.3.3 Surface Geology

The surficial geology at the Annex is dominated by two glacial deposits: glacial till and outwash. Deposits of Recent age include alluvium and organic silt and peat.

Glacial till was deposited by the glacial ice sheet and rests directly on bedrock. When exposed at the surface, till forms both ground moraine and drumlins. As ground moraine, the till creates an irregular blanket on the bedrock surface. Tuttle Hill has been classified as ground moraine (Hansen, 1956). Till also forms drumlins, which are scattered across the Annex (Vose Hill, Hill 321, and Hill 235), and whose long axes have a crude northwesterly alignment.

Glacial till at the Annex is a compact, poorly sorted mixture of soil with grain sizes ranging from clay to boulders. Due to its compactness and poor sorting, till has a low permeability which retards the movement of ground water. At some locations at the Annex, however, the till was found to contain heavily oxidized fissures which greatly increased the flow of ground water.

Over most of the Annex, the glacial till is overlain by glacial outwash. The glacial outwash forms broad plains of well-stratified sand and gravel locally trenched by streams and pitted by shallow depressions containing lakes or swamps. Disregarding the soil zone and thin deposits of Recent age, the outwash is the uppermost deposit across nearly the entire installation.

The glacial outwash plains are of two major types: proglacial deposits and ice-contact deposits. Proglacial deposits were laid down by melt-water streams issuing from the ice margin. These deposits are fine to coarse textured and well stratified. Beneath this upper deposit is a lower zone composed chiefly of beds of gray, very fine sand and silt representing lake-bottom deposits. This lithologic sequence was encountered in the deep boring along White Pond Road, near Patrol Road. Ice-contact deposits on the Annex were laid down against the ice or in holes within the ice, forming roughly circular hills called kames. The stratification of the deposits ranges from poor to good, and the grains range in size from clay to cobble. Examples of ice-contact deposits can be found near the northern and eastern boundaries of the

Annex, where groups of kames have been closely spaced and form kame fields.

Recent deposits are relatively thin and restricted in distribution. They consist of alluvium composed of reworked outwash sand and gravel deposited along stream channels, of gray organic silt and peat deposited on lake bottoms and in swamps, and of loess-like deposits of uniform brown fine sand. The peat and organic silt locally retard the movement of water into or out of the outwash.

#### **2.3.4 Soils**

Generalized stratigraphic units prevalent across the site are soil, outwash, till, and bedrock. Weathering of the glacial deposits and the bedrock could have produced the existing soil, while in certain areas, erosion may have removed this soil. Surface soils developed on the kame landforms, the outwash plain, and the alluvium are sandy loam with lenses of gravel. Soils in the lowland swamps and bogs are composed of muck and peat. Soils developed on ground moraines and drumlins are stony loam.

#### **2.3.5 Drainage**

Glaciation has profoundly affected surface drainage at the site. Accumulation of glacial debris within the preglacial stream valleys has not only caused streams to alter their course, but in some places disrupted drainage entirely. Drainage on the Annex as a whole is poorly integrated as indicated by the numerous swamps, ponds, and small water holes. Previous geologic investigations have determined that the Assabet River once flowed across the Annex in a southeast trend from Boons Pond, beneath the southern shore of White Pond, and then curving to the northeast towards Hudson Road (Hansen, 1953). The cut of this earlier channel has been located at depths between 80 and 120 feet below ground level through seismic and test drilling surveys (Barnes, 1956; Perlmutter, 1962).

The northern parcel of the Annex lies within the drainage basin of the Assabet River, which flows along the northwestern perimeter of the installation. Taylor Brook, flowing north to the river, is the largest stream draining the area. Honey Brook, Taylor Brooks' major tributary, flows northeastward in a man-made channel along a bunker access path. The southern parcel of the Annex is within the drainage basin of the Sudbury River. The largest stream in the area, Marlboro Brook, flows southeastward from the former railroad classification yard towards the installation boundary.

#### **2.3.6 Regional Hydrogeology**

The overburden water-bearing zone is a glacial deposit, consisting of glacial outwash, glacial till, and glacial moraine deposits. The glacial outwash is the most permeable zone and consists of stratified silt, sands and gravels. Ground water flow conditions within the outwash are controlled by changes in the surficial geology, the areal extent of the outwash, and by the less-permeable boundary conditions created by glacial till and bedrock. The glacial till is a dense, poorly sorted mixture of clay, silt, sand, gravel, and boulders. The till has a low hydraulic conductivity and does not provide an appreciable source of water (less than 10 gpm).

Bedrock is hydraulically connected with the overburden. Due to the composition of the bedrock and the slight fracturing observed in the rock cores, the bedrock water-bearing zone may have a very low primary and secondary porosity. This hypothesis is supported by previous studies (Perlmutter, 1962), and by the low hydraulic conductivity values ( $2 \times 10^{-5}$  ft/min) found during the OHM investigation. Although the

bedrock does transmit water, the configuration and depth of the bedrock surface have greater influence of the ground water flow regime than does its water-yielding characteristics.

Depth to ground water is relatively shallow, ranging from flowing artesian conditions to 15 feet below ground surface (BGS). On topographic highs, the water table has been measured at depths to 30 feet BGS. The ground water elevation, hydraulic gradient, and flow direction roughly mimic ground surface topography and drainage.

The hydraulic conductivity of the overburden unit varies greatly across the Annex. The portions of the site with the highest permeability were near the southwestern boundary of the installation, and at the western side of the site, near Patrol Road and White Pond Road. The region with the lowest permeability was the eastern portion of the site, and the study areas around Puffer Pond. The highest hydraulic conductivity reported in the literature was from a location in a buried river valley beneath the southern parcel of the installation.

A pumping test was conducted on the abandoned Maynard water supply well installed within the buried valley (Perlmutter, 1962). The pumping test determined the overburden formation to have a hydraulic conductivity of 800 gpd/ft<sup>2</sup> ( $8 \times 10^{-2}$  ft/min), with a storage coefficient of 0.20. Slug tests conducted during the OHM investigation in this vicinity produced results similar to those of the pumping test ( $2 \times 10^{-2}$  ft/min).

In locations where the outwash is thick and permeable, the unit can yield approximately 100 gallons per minute. Results of a pump test performed in the 1970s on Maynard Town Well No. 3 reported well yields of 700 gpm.

#### **2.4 STUDY AREA DESCRIPTION AND HISTORY**

Area P19, Clearing, Tracked Road, was identified by the USEPA in the Installation Assessment conducted on the Natick Laboratories and the Sudbury Training Annex (USEPA, 1982). The area was identified as No.4 on the USEPA site location map and describing as a clearing with visible vehicle tracks and dead trees.

#### **2.5 RELATED INVESTIGATIONS**

In 1978, the DOD established the IRP. Under the IRP, the DOD sought to identify, investigate, and clean up contamination from hazardous substances at federal facilities. Environmental investigations were started at the Annex in 1980 under the IRP in order to address the environmental impact of past land usage.

To date, the following organizations have conducted investigations at the Annex funded under the IRP:

- USAEC in 1980
- United States Army Environmental Hygiene Agency in 1983
- Dames & Moore of Bethesda, Maryland in 1986 and 1991
- OHM, Final Master Environmental Plan in 1992
- OHM, Site Investigation/Remedial Investigations in 1993.

A number of other investigations have been performed at the Annex. NUS Corporation (1985/1987), as

a contractor to USEPA, conducted a preliminary assessment/site investigation (PA/SI) at the site in fulfillment of the requirements of CERCLA. SEA Consultants, Inc. (1991) conducted an environmental assessment/ environmental impact study for the Massachusetts Air National Guard at the western boundary of the Annex. GZA Geoenvironmental (1991) conducted a site investigation near the eastern boundary of the Annex, as a contractor to the U.S. Army Corps of Engineers, under the Defense Environmental Restoration Program.

The Site Investigation/Remedial Investigation Report (OHM, 1993) presents a summary of the investigations conducted by each of the above organizations. The following sections present a summary of the investigations conducted in Study Area P19.

### **2.5.1 Site Reconnaissance**

The site reconnaissance was performed in 1985 as part of the IRP action at the Annex. The reconnaissance was conducted during the Dames & Moore Remedial Investigation to review sites identified by the USEPA Installation Assessment. The area was determined to be used as an encampment during troop exercises. No disposal or contamination-generating activities were noted.

### **2.5.2 Master Environmental Plan**

The MEP was initiated in 1991 as a part of the IRP action at the Annex. The MEP was completed by OHM in 1992, under contract to USAEC, and listed 68 study areas. Clearing, Tracked Road was designated as Study Area P19.

The study conducted under the MEP consisted primarily of a review of existing studies and identification of potential environmentally significant areas. Area P19 was designated as a possible source for release of contaminants into the environment and the MEP recommended that a site investigation be performed.

### **2.5.3 Enhanced Area Reconnaissance**

An Enhanced Area Reconnaissance (EAR) was performed at Area P19 by OHM, under contract to USAEC, in 1992. The EAR is a starting point for the field investigation and serves to qualitatively evaluate environmental conditions within a potential area of concern. Results of the EAR are used to determine the appropriate course of action for the study area. Subsequent actions involve either removing the area from further consideration through the use of a No Further Action Decision Document, or elevating the field investigation to a site or remedial investigation.

The objectives of the investigation at Area P19 were to identify stressed vegetation, drums, surface debris, or other evidence of contamination. The technical approach and the results of the EAR at this study area are presented in Section 4.0.



2

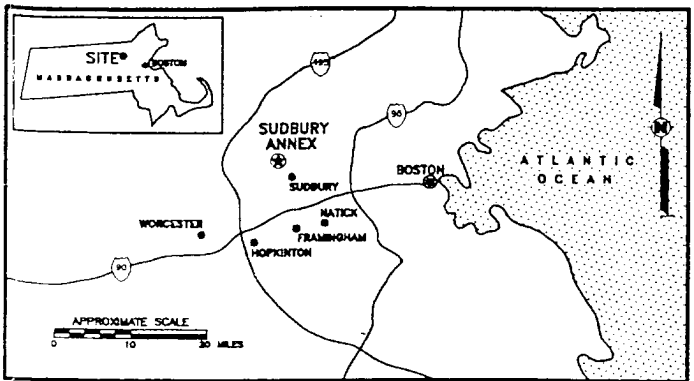

KEY MAP

- LEGEND:**
- BUILDING/STRUCTURE
  - ROAD (SURFACED)
  - ROAD (UNIMPROVED OR TRAIL)
  - RAILROAD
  - FENCE
  - INSTALLATION BOUNDARY
  - CONTOUR (5' INTERVAL)
  - SWAMP

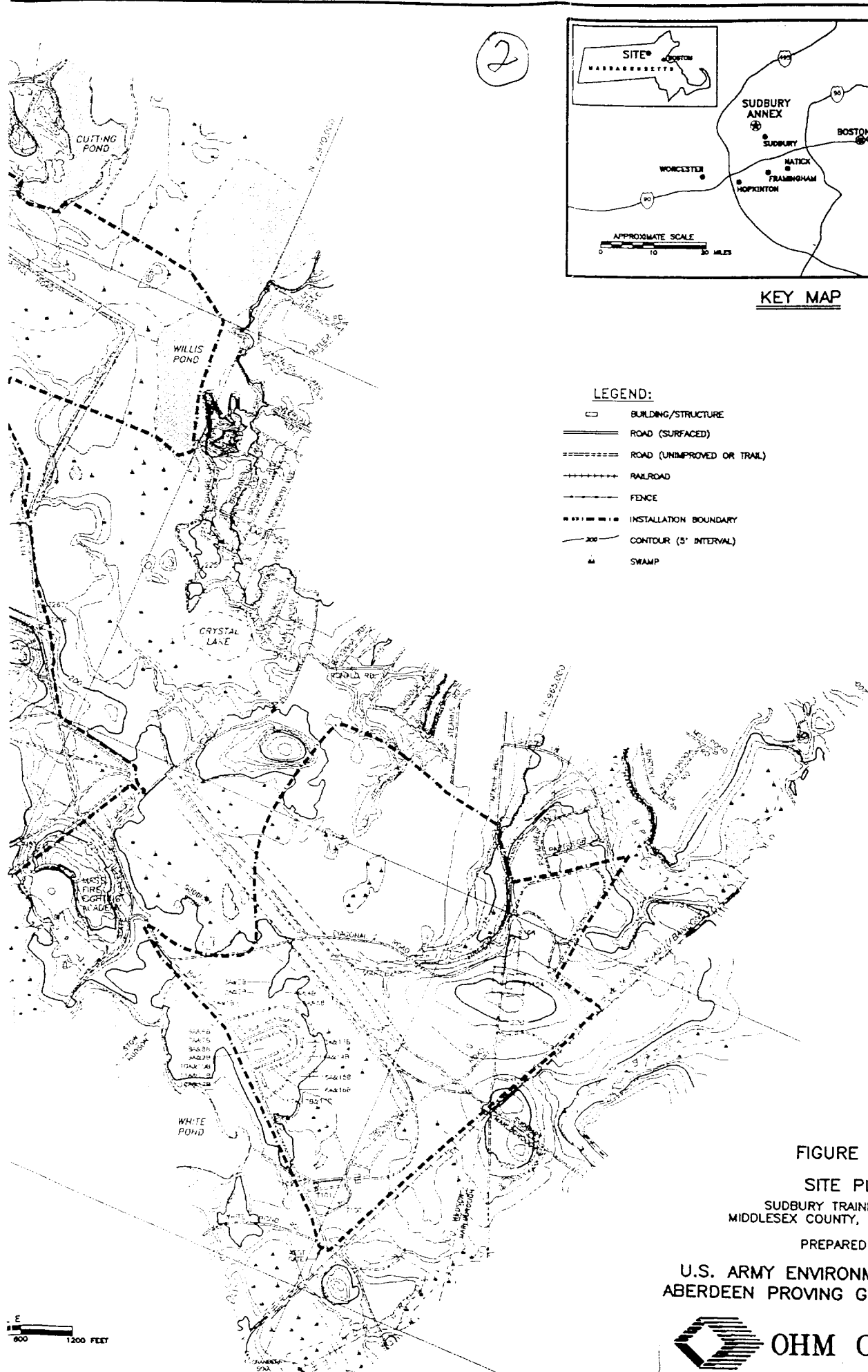
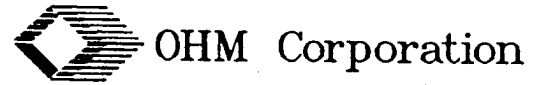

FIGURE 2-1  
 SITE PLAN  
 SUDBURY TRAINING ANNEX  
 MIDDLESEX COUNTY, MASSACHUSETTS

PREPARED FOR  
 U.S. ARMY ENVIRONMENTAL CENTER  
 ABERDEEN PROVING GROUND, MARYLAND



### SECTION 3.0 AREA-SPECIFIC CHARACTERISTICS

Area P19 is located near the northern border of the installation on the south side of Patrol Road. The area is 500 feet north of Area A2 and 1,500 feet northeast of the North Gate. Figure 3-1 presents a map of the area. The surficial geology of this area has been classified as ground moraine (Hansen,1956). The area is a wide clearing situated on a small hill. The clearing is visible on aerial photographs.

Several small mounds, trenches, and pits were noted in the area which were believed to be the remains of fighting positions left by military training units. Record searches do not indicate disposal activities in this area.

DRAWING NUMBER 14316-A76

APPROVED BY

CHECKED BY

DRAWN BY M. WARNICK 9-29-94

OHM CORPORATION PITTSBURGH, PA

PLOT SCALE: 1" = 100'

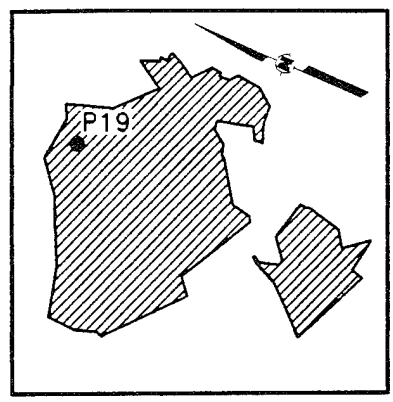

KEY MAP

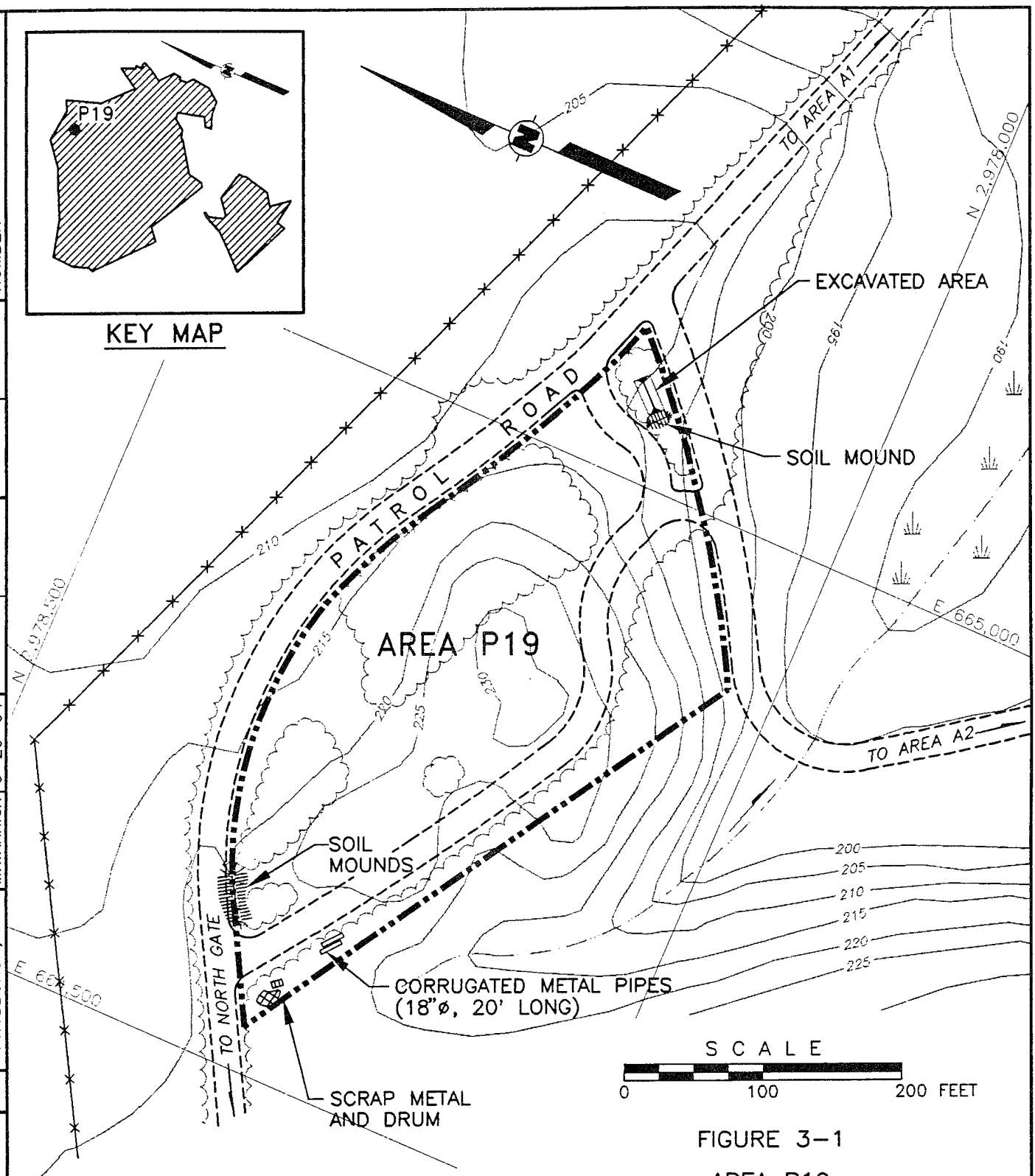

- LEGEND:
- PAVED ROAD
  - UNPAVED ROAD
  - FENCE
  - SWAMP
  - TREELINE
  - DRUM ON SURFACE
  - STREAM

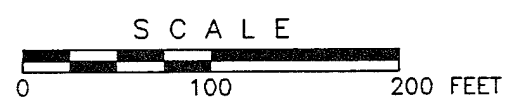
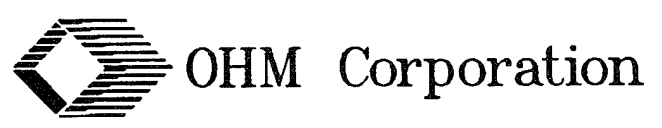

FIGURE 3-1  
 AREA P19  
 SITE MAP  
 SUDBURY TRAINING ANNEX  
 MIDDLESEX COUNTY, MASSACHUSETTS

PREPARED FOR  
 U.S. ARMY ENVIRONMENTAL CENTER  
 ABERDEEN PROVING GROUND, MARYLAND



## SECTION 4.0 CONTAMINATION ASSESSMENT

A site reconnaissance was performed by representatives of Dames & Moore, USAEC, Fort Devens, and the MADEQE during 1985. Evidence of disposal or contamination-generating activities in the area was not observed.

In 1992, OHM conducted an Enhanced Area Reconnaissance (EAR) to identify stressed vegetation, drums, surface debris, or other evidence of disposal in the area. The procedure for enhanced area reconnaissance is detailed in the Site Investigation/Remedial Investigation Report (OHM, 1993). Several soil mounds, trenches and clearings were noted. A drum and scrap metal was also found in the northwest edge of the area. Black corrugated pipe was found east of the drum along one of the paths. No environmental samples were collected during the Phase I investigation.

The single drum was removed and placed in a staging area at the old MFFA. During the Phase II investigation one confirmatory sample, P19CD1, was collected and analyzed for TCL volatile and semi-volatile organics, pesticides/PCBs and TAL metals. The sample location is presented in Figure 4-1. No staining, unusual odors, or PID or radiological readings were noted during sampling. A complete list of positive detections from Area P19 is provided in Table 4-1. The pesticides, DDT and DDE, were positively detected at 0.0341 and 0.0751  $\mu\text{g/g}$ . Among the positive metal detections, arsenic, barium, cobalt, lead, and potassium were detected above their respective 95% UCL for background soils, however arsenic, barium, beryllium, cobalt, and potassium are not considered contaminants of potential concern since their detections were within the range concentrations in the background samples. Selenium was detected at 0.64  $\mu\text{g/g}$  and does not have a background level.

DRAWING NUMBER 14316-A71

APPROVED BY

CHECKED BY

DRAWN BY M. WARNICK 9-29-94

OHM CORPORATION PITTSBURGH, PA

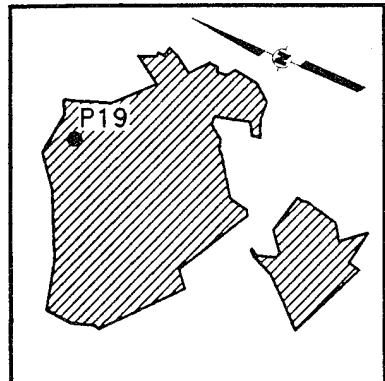

KEY MAP

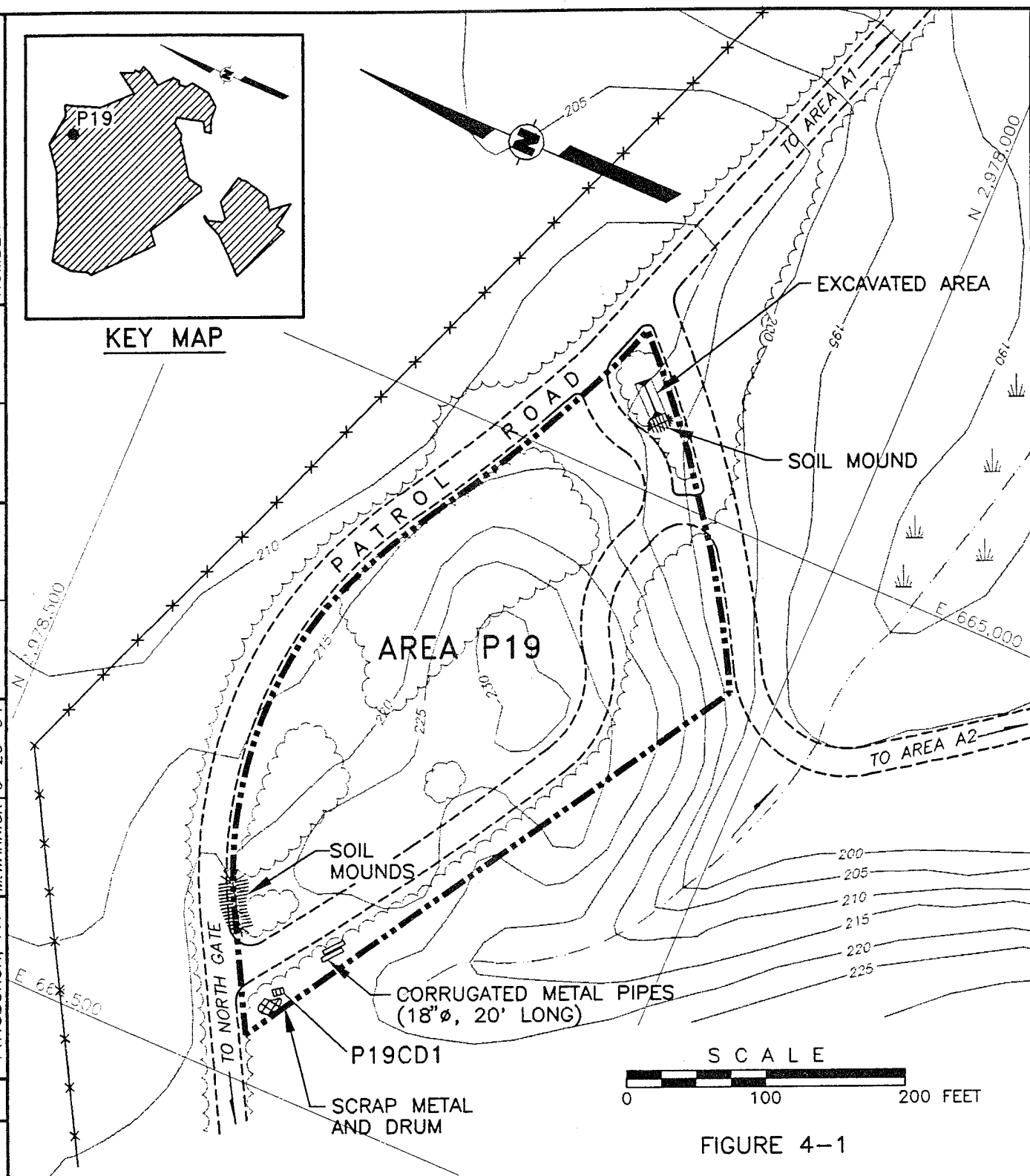

LEGEND:

- PAVED ROAD
- UNPAVED ROAD
- FENCE
- SWAMP
- TREELINE
- DRUM ON SURFACE
- STREAM

PLOT SCALE: 1" = 100'

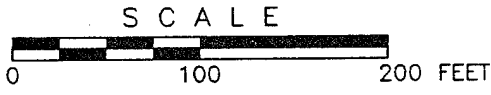

FIGURE 4-1

AREA P19 SITE MAP AND PHASE II SAMPLE LOCATION SUDBURY TRAINING ANNEX MIDDLESEX COUNTY, MASSACHUSETTS

PREPARED FOR

U.S. ARMY ENVIRONMENTAL CENTER ABERDEEN PROVING GROUND, MARYLAND

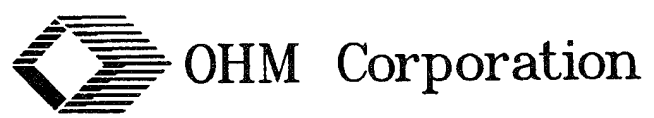

Table 4-1  
 Area P19  
 Summary of Positive Detections  
 Phase II Soil (ug/g)

Site ID	P19CD1
Field Sample Number	P19CD1B
Sample Date	27-Oct-93
Depth (ft)	0.0

Pesticides/PCBs

ppDDE	0.0751
ppDDT	0.0341

Volatile Organics

Unknown 157	0.007
-------------	-------

Metals

Aluminum	11000
Arsenic	10
Barium	34.8
Beryllium	0.479
Calcium	223
Chromium	12.9
Cobalt	4.38
Copper	7.45
Iron	11000
Lead	80
Lead	94.1
Magnesium	1470
Manganese	238
Pottasium	480
Selenium	0.64
Vanadium	20.7
Zinc	38.7

## SECTION 5.0 PRELIMINARY RISK EVALUATION

### Human Health

For the human health preliminary risk evaluation, the soil sample was compared to MCP S-1/GW-1 soil standards. Neither DDE nor DDT pose a human health risk since their detections, 0.0751 and 0.0341  $\mu\text{g/g}$ , were below their 2  $\mu\text{g/g}$  standard. Of the metals detected, lead and selenium were evaluated because MCP S-1/GW-1 soil standards exist for them. With a detection of 94.1 and 0.64  $\mu\text{g/g}$ , lead and selenium also do not pose a concern since their detections do not exceed their 300  $\mu\text{g/g}$  standard.

### Ecological

For the ecological risk evaluation, the soil sample was compared to eco-risk screening values (ESAT, 1994). With detections of 0.0341 and 0.0751  $\mu\text{g/g}$ , both DDT and DDE do not pose an ecological concern since neither exceed their 0.5  $\mu\text{g/g}$  screening value. For metals, neither lead nor selenium pose an ecological concern since their detections are below 200 and 2  $\mu\text{g/g}$ .

**SECTION 6.0**  
**CONCLUSION**

During record searches and the field investigation, no indication of possible contamination was identified. In a drum confirmatory sample, concentrations of contaminants of potential concern were not above human health and ecological screening values. Therefore, it is concluded that not further action is required at Study Area P19.

**SECTION 7.0  
DECISION**

On the basis of study at Area P19, there is no reason or evidence to conclude that activities at this location have caused significant environmental contamination or pose a threat to human health or the environment. The decision has been made to remove Area P19 from further consideration in the Installation Restoration Program and the Comprehensive Environmental Response, Compensation, and Liability Act, as amended.

Commander, Fort Devens

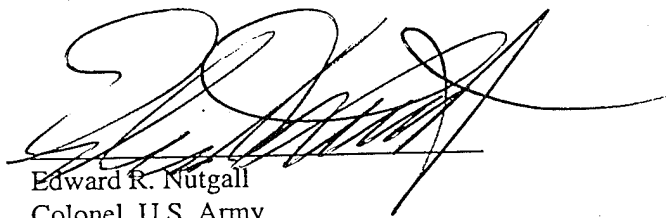

Edward R. Nutgall  
Colonel, U.S. Army  
Commanding

31 Aug 95

Date

U.S. Environmental Protection Agency  
Region I, Federal Facilities Office

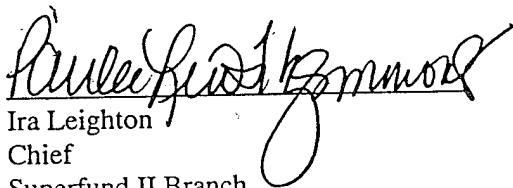

Ira Leighton  
Chief  
Superfund II Branch

11/14/95

Date

Concur

Non-concur (please provide reasons)

---

---

## SECTION 8.0 REFERENCES

Barnes, D.F., 1956, "Seismic Surveys of Maynard Ordnance Test Station, Maynard, Massachusetts," USGS, Open-File Report.

B.H. Keith Service, 1983, "Land Cover of the Fort Devens - Sudbury Training Annex," U.S. Army, Sudbury, Massachusetts.

Dames & Moore, November 26, 1986, "Remedial Investigation Report", Contract No. DAAK11-84-D-0002, submitted to USATHAMA, Aberdeen Proving Ground, Maryland.

Fort Devens, May 8, 1990, "Additional Installation Restoration Program (IRP) Sites for Investigation at Sudbury Training Annex, Sudbury, Massachusetts," Memorandum for: Commander, USATHAMA.

Hansen, W.R., 1953, "Late Tertiary and Pleistocene Drainage Changes in the Hudson and Maynard Quadrangles, Massachusetts," Journal of Geology, Vol. 61, No. 4, p. 353-362.

Hansen, W. R., 1956, "Geology and Mineral Resources of the Hudson and Maynard Quadrangles, Massachusetts," USGS, Geological Survey Bulletin 1038.

Interview, 1991, "Notes On Interview Between, and Site Visit With Dr. Murray Hamlet of ARIEM and USTHAMA/OHM."

Leupold Forestry Service, 1983, "Land Cover at the Fort Devens - Sudbury Training Annex," U.S. Army, Sudbury, Massachusetts.

OHM Corporation, January 1992, "Final Master Environmental Plan for the Fort Devens Sudbury Training Annex, Middlesex County, Massachusetts."

OHM Corporation, July 1993, "Draft Final Site Investigation/Remedial Investigation Report for the Fort Devens Sudbury Training Annex, Middlesex County, Massachusetts."

Perlmutter, N. M., 1962, "Ground-Water Geology and Hydrology of the Maynard Area, Massachusetts," USGS, Water Supply Paper 1539-E.

USATHAMA, May 1980, "Installation Assessment of U.S. Army Natick Research and Development Command, Report 170."