



STUDY OF AN ANTITERRORISM / FORCE PROTECTION

Base Entrance Improvements in an Historic District

Report Documentation Page

Form Approved
OMB No. 0704-0188

Public reporting burden for the collection of information is estimated to average 1 hour per response, including the time for reviewing instructions, searching existing data sources, gathering and maintaining the data needed, and completing and reviewing the collection of information. Send comments regarding this burden estimate or any other aspect of this collection of information, including suggestions for reducing this burden, to Washington Headquarters Services, Directorate for Information Operations and Reports, 1215 Jefferson Davis Highway, Suite 1204, Arlington VA 22202-4302. Respondents should be aware that notwithstanding any other provision of law, no person shall be subject to a penalty for failing to comply with a collection of information if it does not display a currently valid OMB control number.

1. REPORT DATE 01 AUG 2004		2. REPORT TYPE N/A		3. DATES COVERED -	
4. TITLE AND SUBTITLE Study of an Antiterrorism/Force Protection				5a. CONTRACT NUMBER	
				5b. GRANT NUMBER	
				5c. PROGRAM ELEMENT NUMBER	
6. AUTHOR(S)				5d. PROJECT NUMBER	
				5e. TASK NUMBER	
				5f. WORK UNIT NUMBER	
7. PERFORMING ORGANIZATION NAME(S) AND ADDRESS(ES) Fort McPherson				8. PERFORMING ORGANIZATION REPORT NUMBER	
9. SPONSORING/MONITORING AGENCY NAME(S) AND ADDRESS(ES)				10. SPONSOR/MONITOR'S ACRONYM(S)	
				11. SPONSOR/MONITOR'S REPORT NUMBER(S)	
12. DISTRIBUTION/AVAILABILITY STATEMENT Approved for public release, distribution unlimited					
13. SUPPLEMENTARY NOTES See also ADM002111. Department of Defense Conservation Conference. Held in Savannah, Georgia on August 22-27, 2004, The original document contains color images.					
14. ABSTRACT					
15. SUBJECT TERMS					
16. SECURITY CLASSIFICATION OF:			17. LIMITATION OF ABSTRACT	18. NUMBER OF PAGES	19a. NAME OF RESPONSIBLE PERSON
a. REPORT unclassified	b. ABSTRACT unclassified	c. THIS PAGE unclassified			

PRESENTATION SUMMARY

- . Entrances: Locations & Existing Conditions**
- . Base Entrance Improvements: The Project**
- . Historic District: The Typology of Buildings**
- . Conclusion**

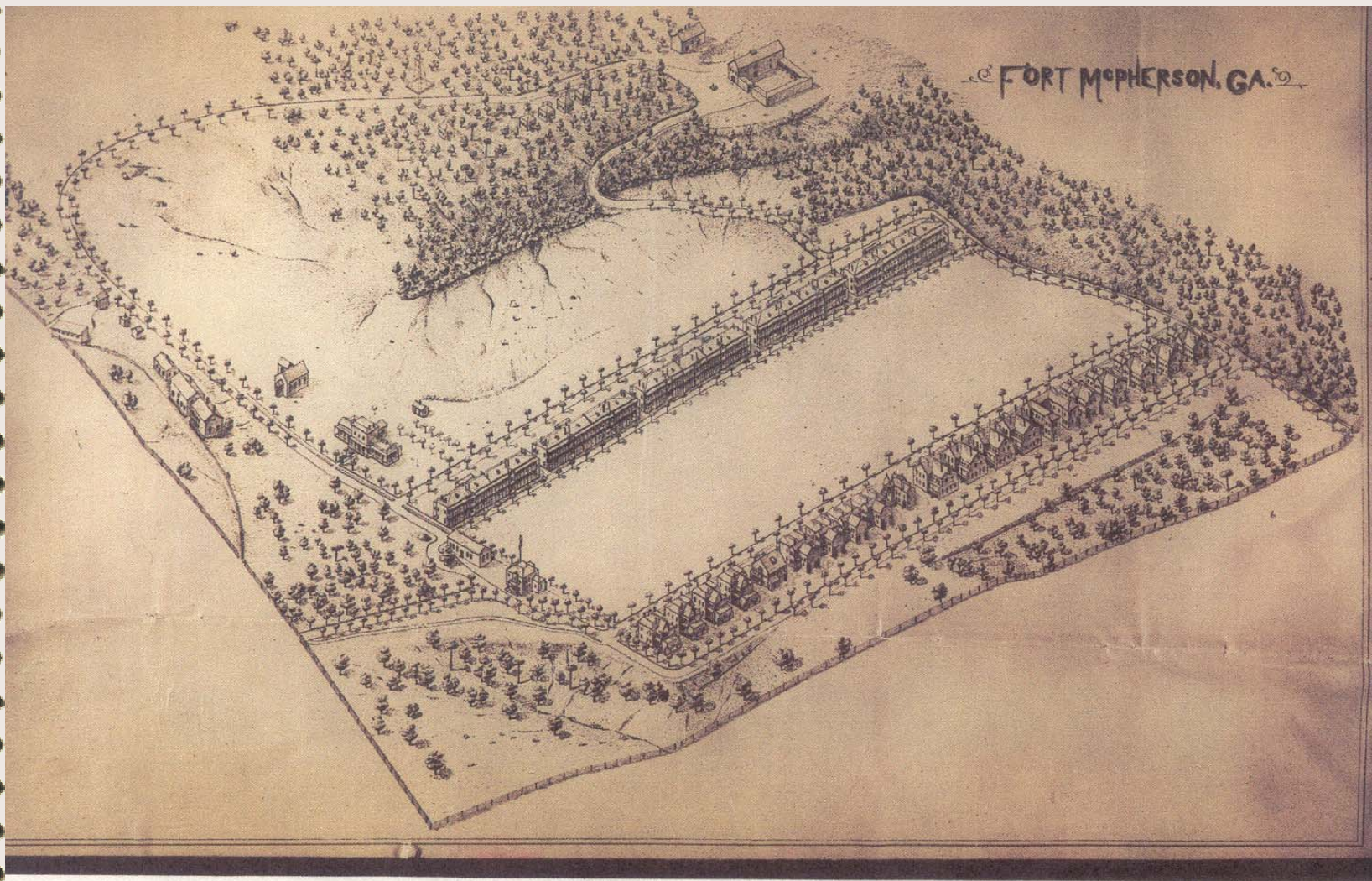

Artist's Rendition of the Post, circa 1890



**Fort McPherson
Aerial view of the Historic District, 1984**

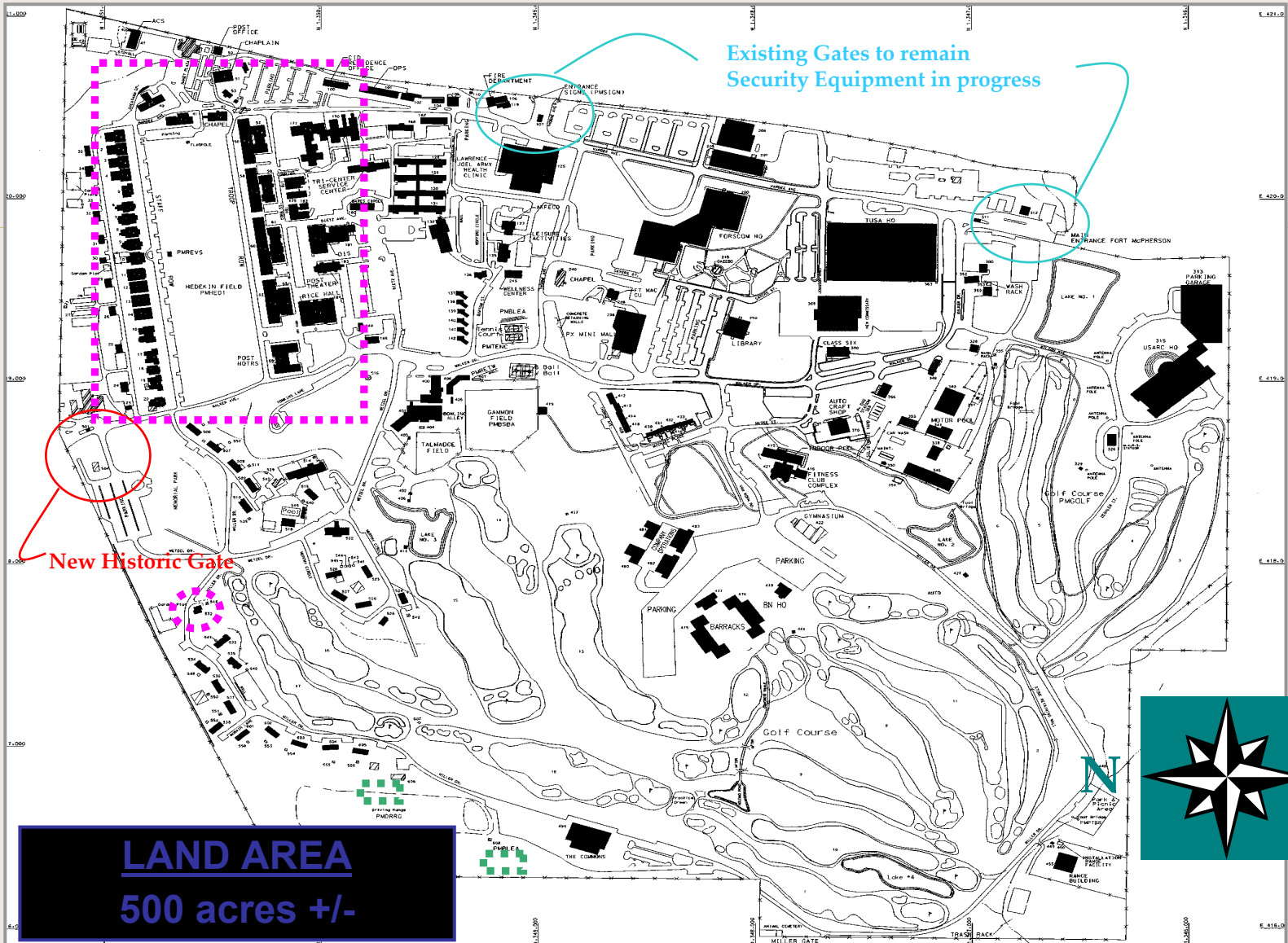

New Historic Gate

Existing Gates to remain Security Equipment in progress

LAND AREA
500 acres +/-

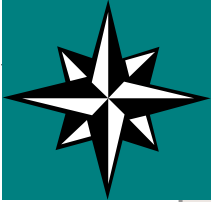



Figure 14. Main Gate, 1918 - Red Cross Convalescent Building (Bldg. 46) in Background



Location of old Main Gate seen from inside (September 2003)

Inactive Gate located in the North Side of the installation. Circa 1988 Aerial Photograph



Gate
Location

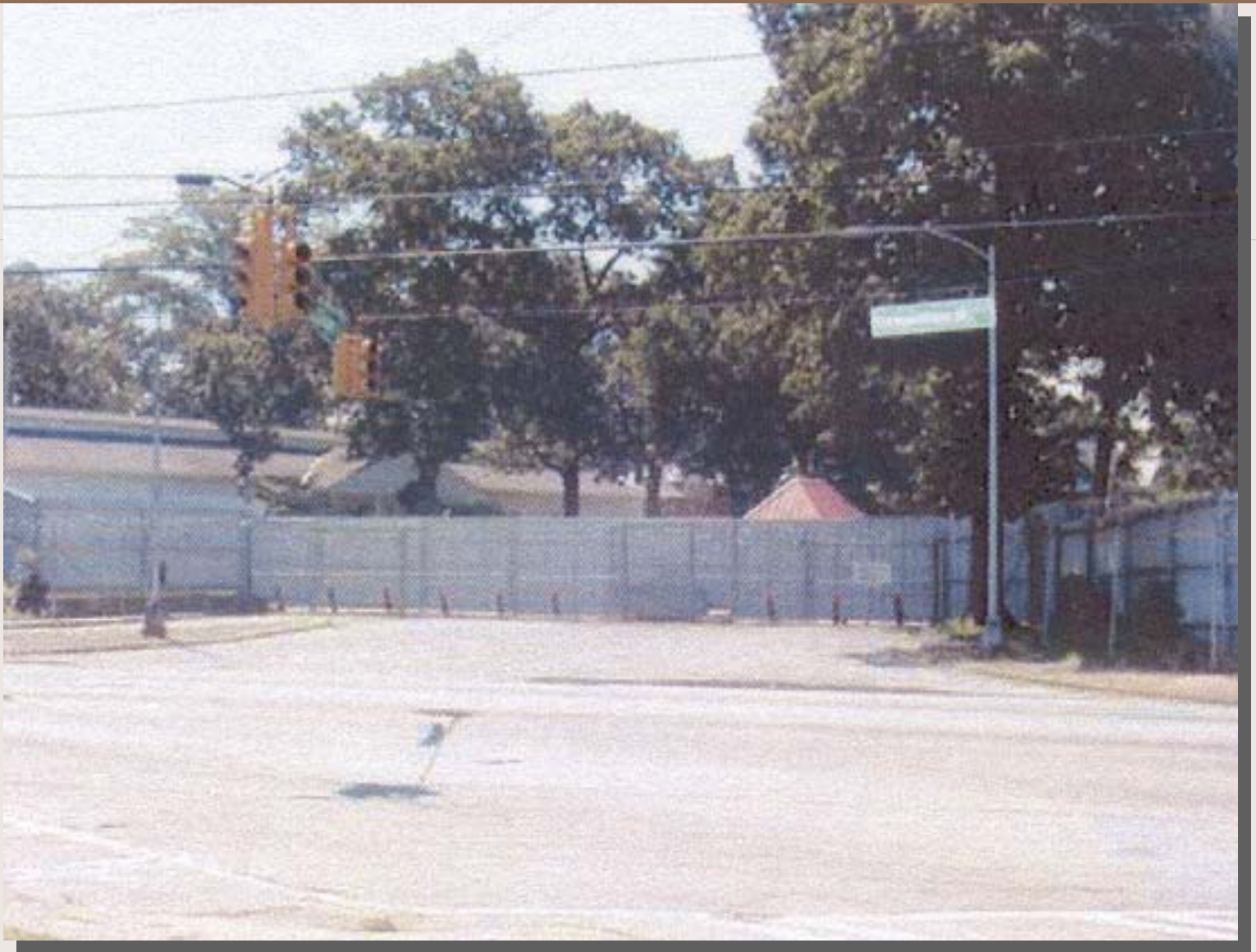

Entrance seen from the street



Inactive Gate located in the North Side of the installation. Circa 1992 Photograph

Beneficial Applications of the New Gate

- . Better access for Residents living in the Staff Row**
- . Convenient Entrance for visiting The Historic District**
- . Easier Exit and Access for Employees working on the North Side of the Post.**

Map 18 -
Existing Conditions
at Entrance 1

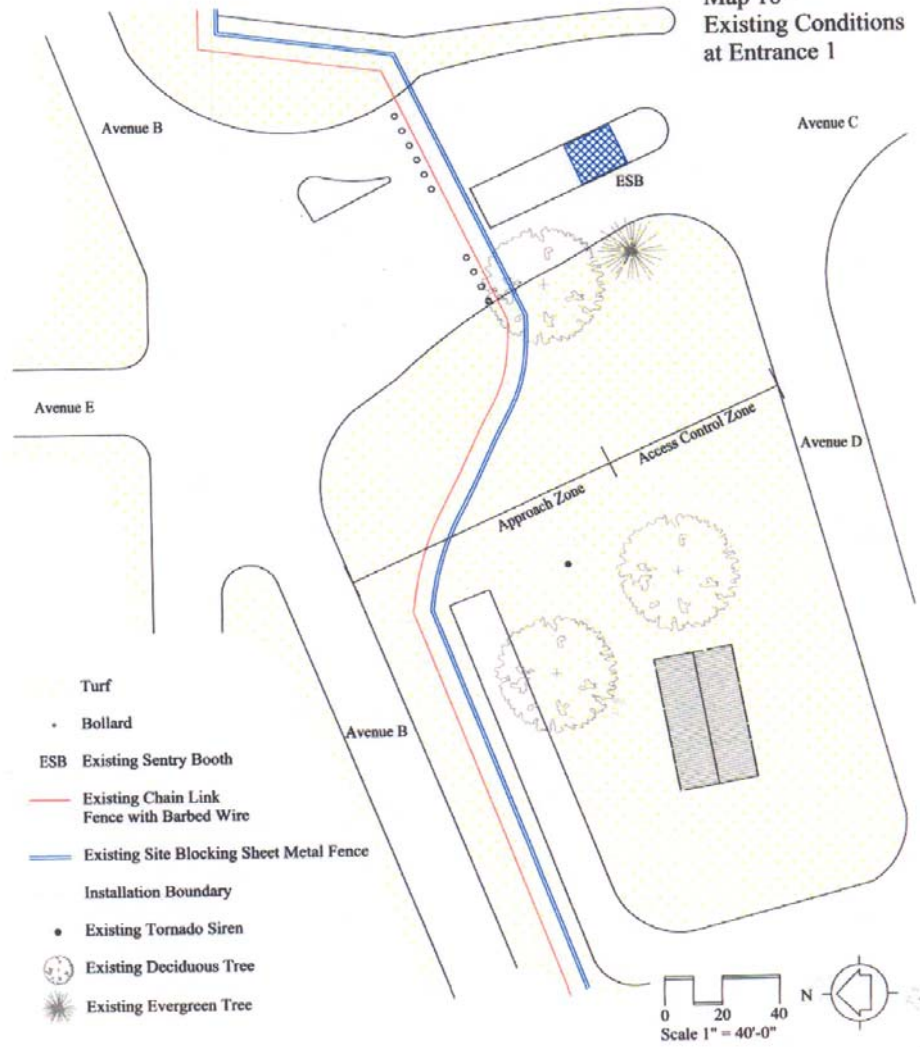

Turf

• Bollard

ESB Existing Sentry Booth

— Existing Chain Link
Fence with Barbed Wire

— Existing Site Blocking Sheet Metal Fence

Installation Boundary

• Existing Tornado Siren

⊙ Existing Deciduous Tree

⊛ Existing Evergreen Tree

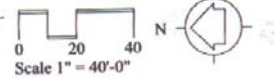

Map 19 - Solution 1 Installation B

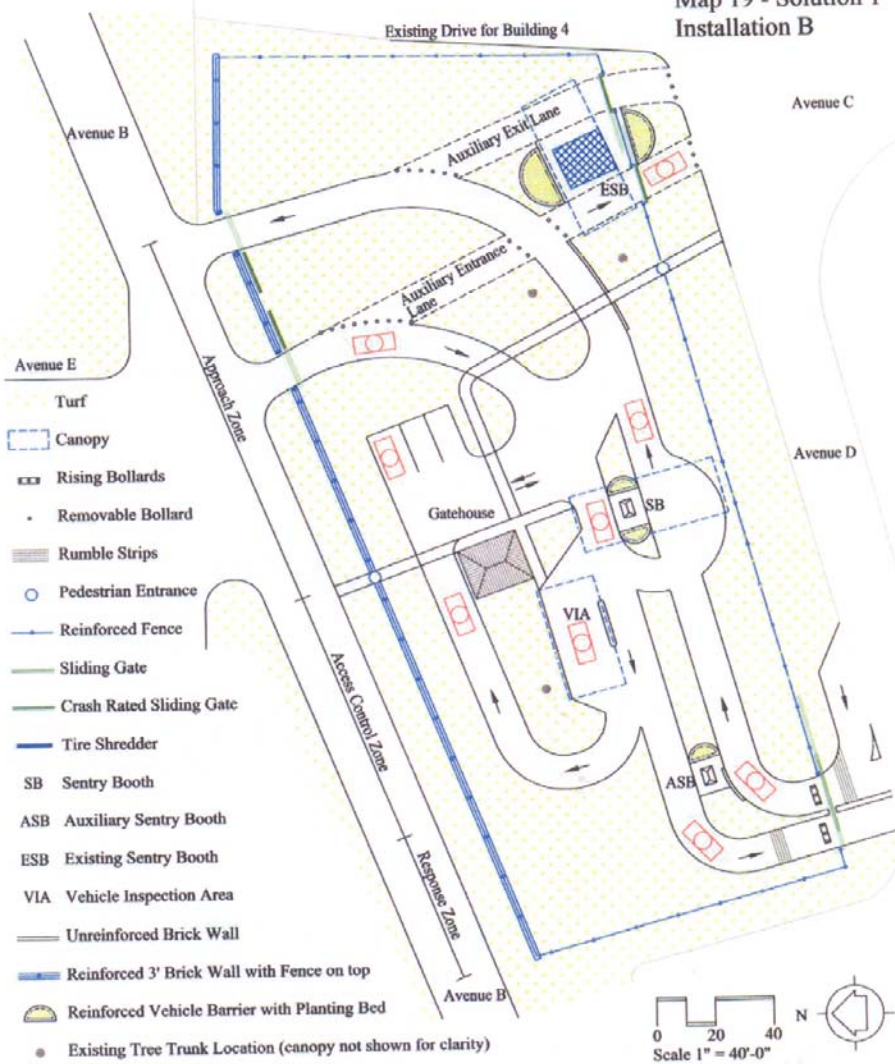

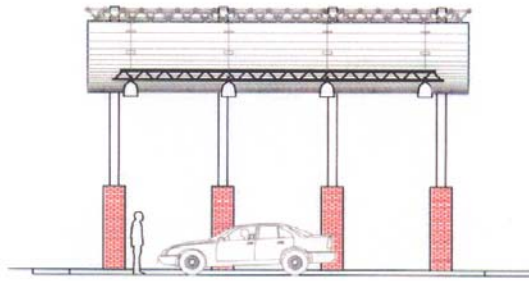

Figure 3. Longitudinal Section of Vehicle Inspection Canopy Example

Scale 1" = 10'-0"
0 5 10



Example of Gatehouse suitable for Historic district.



Example of Retracting Bollards

THE HISTORIC DISTRICT FROM 1885 TO 1910



Joshua West Jacobs
Officer-in-Charge of the Construction of Fort McPherson
Shown as a Major, U.S. Volunteers, in 1898

- . Inventory: 40 Buildings listed on the National Register
- . Major Buildings:
 - Staff Row: 20 Quarters
 - Troop Row: 5 Buildings
 - Old Headquarters
 - Chapel
 - Old Bachelor officers Building
 - Ex Hospital



QUARTERS # 1



Figure 73. Quarters 10 on Staff Row, 1984



QUARTERS # 14
Influences from Georgian and Adam's Types
Palladian and Italianate Components



Stairway after stripping



Stairway stained and finished with two coats of Polyurethane



Figure 78. Troop Row Barracks (Bldg. 56), 1984



Figure 80. Van Horn Hall (Bldg. 41), 1985

CONCLUSION

.Could such Entrances be part of our Historic Patrimony?

. If these Security Gates are parts of our Historic Patrimony, which criteria will justify their Eligibility?

. Are these Antiterrorism Constructions comparable to the Cold War Era?



Cold War Military Shelter

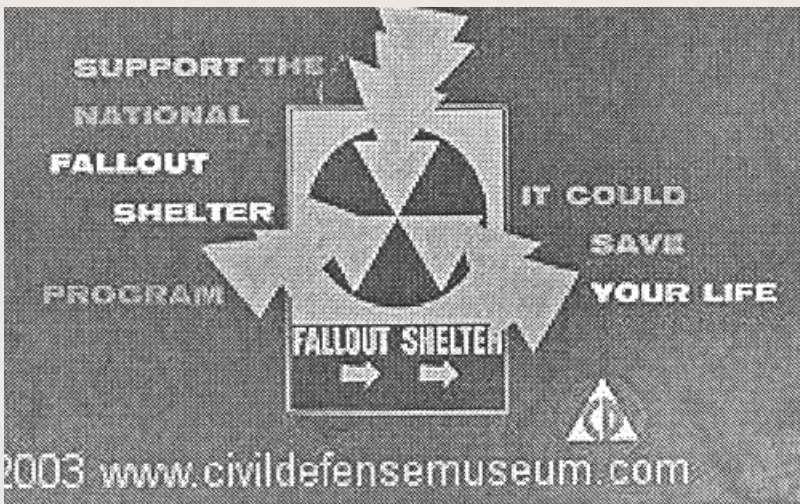

Cold War Bus and Subway Posters

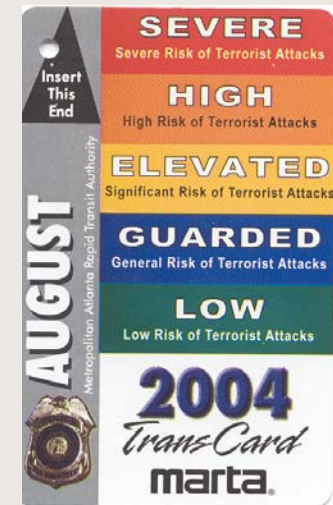

UTAH BEACH 1944

**20,000 men stormed this shore and took the beach.
57 years later Bill Kelly walks with his grandson
Jake, who listens as Grandpa's war takes him from
this beach across the Rhine to Victory**

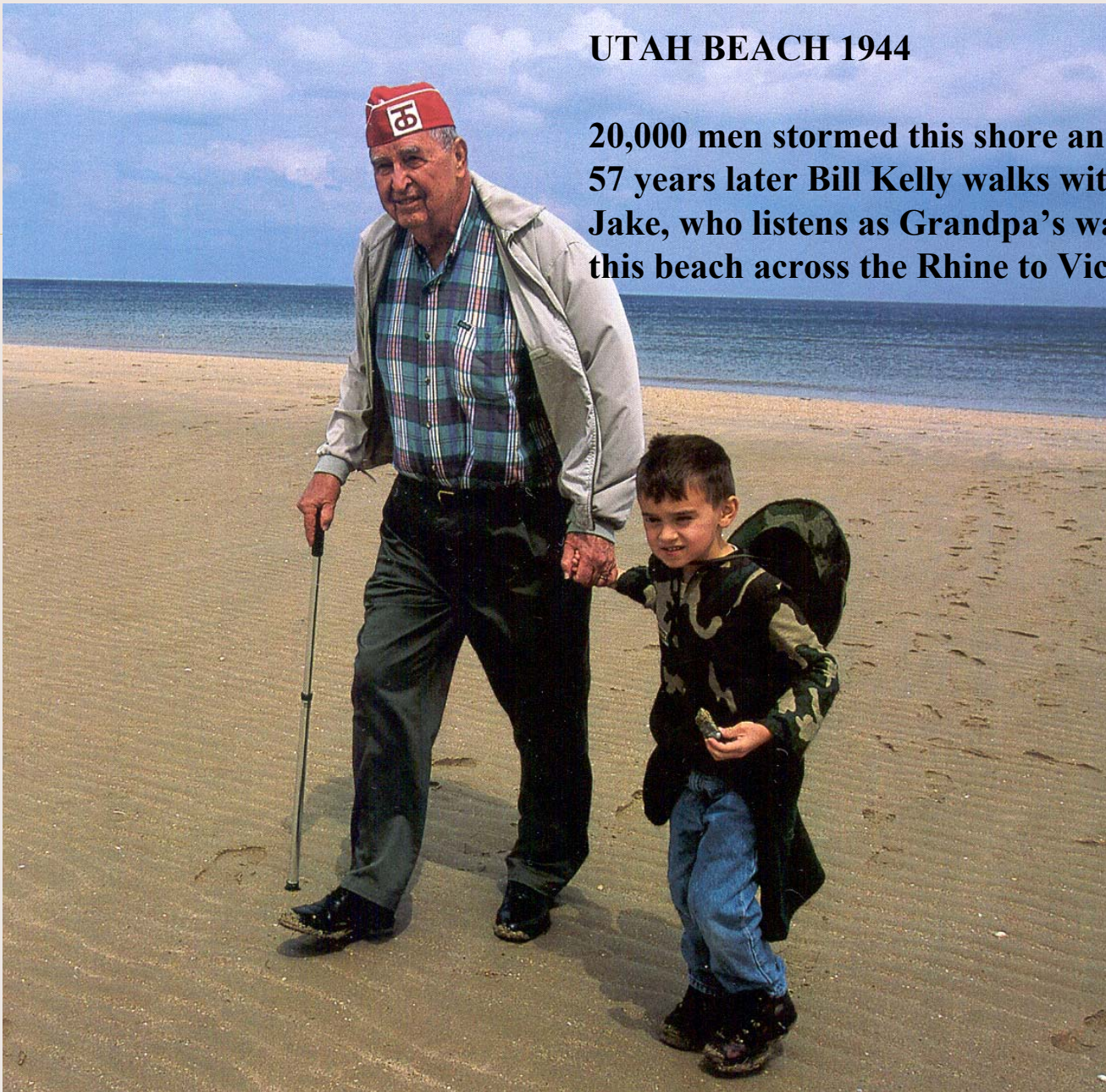



**THANK YOU FOR SHARING THIS PRESENTATION
WITH ME**

JEAN PAUL PENTECOUTEAU

