

**REPORT DOCUMENTATION PAGE**Form Approved  
OMB No. 0704-0188

Public reporting burden for this collection of information is estimated to average 1 hour per response, including the time for reviewing instructions, searching existing data sources, gathering and maintaining the data needed, and completing and reviewing this collection of information. Send comments regarding this burden estimate or any other aspect of this collection of information, including suggestions for reducing this burden to Department of Defense, Washington Headquarters Services, Directorate for Information Operations and Reports (0704-0188), 1215 Jefferson Davis Highway, Suite 1204, Arlington, VA 22202-4302. Respondents should be aware that notwithstanding any other provision of law, no person shall be subject to any penalty for failing to comply with a collection of information if it does not display a currently valid OMB control number. **PLEASE DO NOT RETURN YOUR FORM TO THE ABOVE ADDRESS.**

<b>1. REPORT DATE (DD-MM-YYYY)</b> 08-06-2010		<b>2. REPORT TYPE</b> CONFERENCE PROCEEDING		<b>3. DATES COVERED (From - To)</b> 2010-2010	
<b>4. TITLE AND SUBTITLE</b>  In Situ Metrology for the Corrective Polishing of Replicating Mandrels				<b>5a. CONTRACT NUMBER</b> NNX10CD72P	
				<b>5b. GRANT NUMBER</b>	
				<b>5c. PROGRAM ELEMENT NUMBER</b>	
<b>6. AUTHOR(S)</b>  Dan Thompson, Dave Youden, John Kelchner				<b>5d. PROJECT NUMBER</b>	
				<b>5e. TASK NUMBER</b>	
				<b>5f. WORK UNIT NUMBER</b>	
<b>7. PERFORMING ORGANIZATION NAME(S) AND ADDRESS(ES)</b>  Zeeko Technologies, LLC 3495 KENT AVE STE K100 WEST LAFAYETTE, IN 47906				<b>8. PERFORMING ORGANIZATION REPORT NUMBER</b>	
<b>9. SPONSORING / MONITORING AGENCY NAME(S) AND ADDRESS(ES)</b>  NASA Goddard Space Flight Center				<b>10. SPONSOR/MONITOR'S ACRONYM(S)</b> NASA GSFC	
				<b>11. SPONSOR/MONITOR'S REPORT NUMBER(S)</b>	
<b>12. DISTRIBUTION / AVAILABILITY STATEMENT</b>  DISTRIBUTION STATEMENT A: Approved for public release; distribution is unlimited.					
<b>13. SUPPLEMENTARY NOTES</b> Presented at Mirror Technology Days, Boulder, Colorado, USA, 7-9 June 2010.					
<b>14. ABSTRACT</b> The International X-ray Observatory (IXO) will require mandrel metrology with extremely tight tolerances on mirrors with up to 1.6 meter radii. Metrology on these shapes using conventional interferometry is difficult. A system that could perform in-situ metrology on the polishers may be ideal. Error budgets for the IXO mirror segments are presented. A potential solution is presented that uses a voice-coil controlled gauging head, air bearings, novel probes, and temperature control.					
<b>15. SUBJECT TERMS</b>					
<b>16. SECURITY CLASSIFICATION OF:</b>			<b>17. LIMITATION OF ABSTRACT</b>  SAR	<b>18. NUMBER OF PAGES</b>  17	<b>19a. NAME OF RESPONSIBLE PERSON</b> Hans-Peter Dumm
<b>a. REPORT</b> UNCLASSIFIED	<b>b. ABSTRACT</b> UNCLASSIFIED	<b>c. THIS PAGE</b> UNCLASSIFIED			<b>19b. TELEPHONE NUMBER (include area code)</b> 505-853-8397

# In Situ Metrology for the Corrective Polishing of Replicating Mandrels

---

NASA Phase I Contract NNX10CD72P

Dan Thompson  
Dave Youden  
John Kelchner  
Zeeko Technologies, LLC

Mirror Technology SBIR/STTR Workshop  
Boulder, CO  
June 8, 2010

The Challenge: Develop an instrument for the process-intermittent metrology of the IXO mandrels to control the corrective polishing process

---

- Extremely tight tolerances
- Very large radii (to 1.6 m)
- Unsuitable for interferometry
- Radii too large for on-center polishing or metrology
- Ultimate need to provide in-situ metrology on the polisher(s) for rapid process control

Our solution: Develop a dedicated metrology **instrument using a “virtual axis of rotation”**

# Mandrel Sizes for IXO

	<b>Inner Ring</b>	<b>Middle Ring</b>	<b>Outer Ring</b>
<b>Azimuthal Span of Each Module (degrees)</b>	<b>30</b>	<b>15</b>	<b>15</b>
<b>Number of mandrels</b>	<b>286</b>	<b>230</b>	<b>206</b>
<b>Radius of Each Module</b>	<b>372-693 mm</b>	<b>740-1110 mm</b>	<b>1156-1605 mm</b>
<b>Polished chord width of Slab Mandrels</b>	<b>255-475 mm</b>	<b>310-470 mm</b>	<b>500-700mm</b>
<b>Clear Aperture length</b>	<b>200 mm</b>	<b>200 mm</b>	<b>200 mm</b>
<b>Mandrel polished length</b>	<b>275 mm</b>	<b>275 mm</b>	<b>275 mm</b>

# Error budget for individual forming mandrels for IXO

Mandrel Surface Parameters		Error Allocation for either Primary or Secondary (assuming perfection for the other)		RSS Contribution to HPD (arcsec)	Cumulative HPD (arcsec)
		Numerical Value	Unit		
Radius	Average Radius	10.00	μm	0.2	0.2
	Radius Variation	0.20	μm	0.1	0.2
Cone Angle	Average Cone Angle	0.50	arcsec	0.7	0.8
	Cone Angle Variation	0.40	arcsec	0.7	1.0
Axial Sag	Average Sag	0.05	μm	0.5	1.1
	Sag Variation	0.05	μm	0.2	1.1
Axial Figure	Low Frequency Figure (200mm-20mm)	5.00	nm	0.4	1.2
	Mid Frequency Figure (20mm-2mm)	2.00	nm	0.9	1.5
	High Frequency Figure (2mm-0.002mm)	NA	nm	NA	1.5

# A 3 Phase Approach:

---

- Phase 1: Develop a conceptual design
- Phase 2: Develop a stand-alone metrology system
- Phase 3: Integrate the metrology and manufacturing systems

# Phase 1 Work Plan

---

- ❑ Establish a detailed specification for the instrument
- ❑ Develop a conceptual design for metrology equipment
- ❑ Create an error budget for metrology equipment
- ❑ Develop a plan to combine polishing and metrology equipment
- ❑ Prepare a final report and a project plan for Phase 2 of the SBIR

# Zeeko IRP 400

---

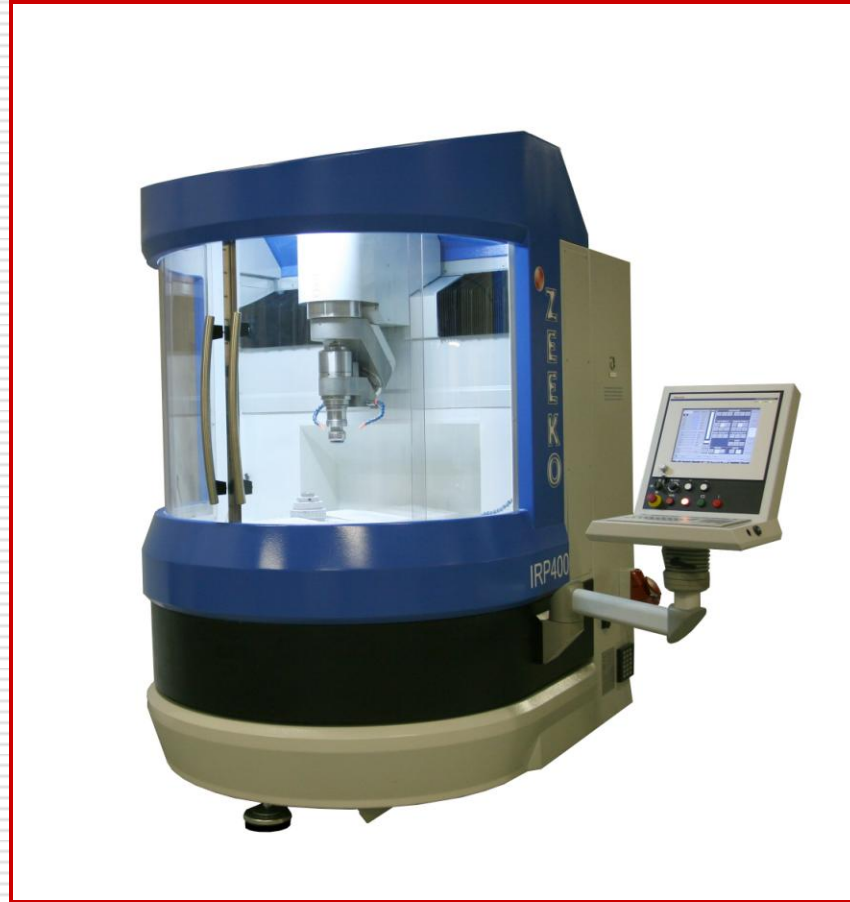

# Key Technologies and Principals

---

- ❑ Extensive use of error budgeting as a design guidance tool
- ❑ The development of a novel contact voice-coil controlled gauging head, with dynamic range, resolution and uncertainty necessary to meet component metrology requirements
- ❑ The merging of an array of precision engineering principles and design elements including air-bearing components, a novel probe design, temperature control in a radical environment, and the integration of all of these technologies on a computer controlled machine to control the manufacturing process

# How it Works

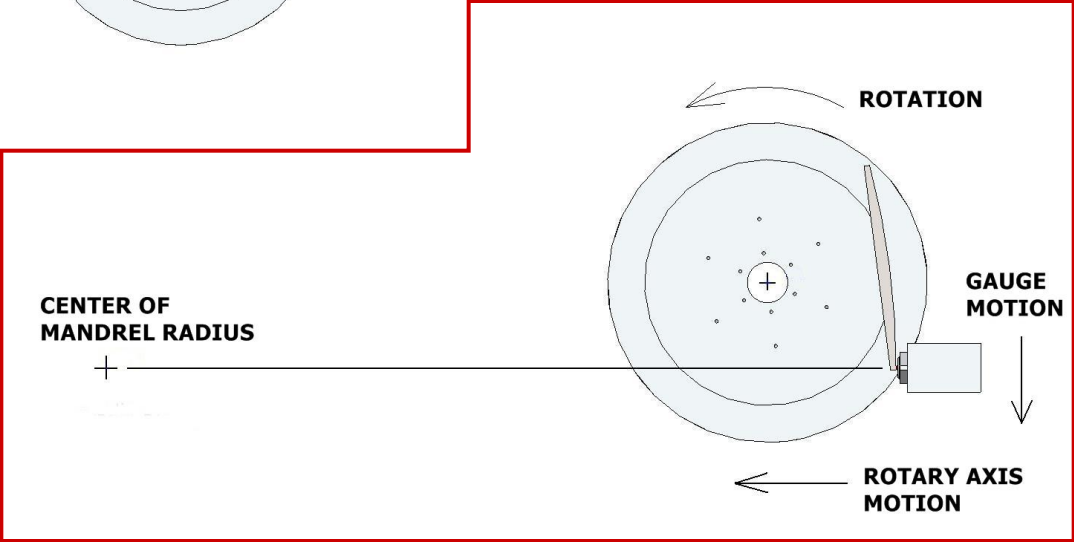
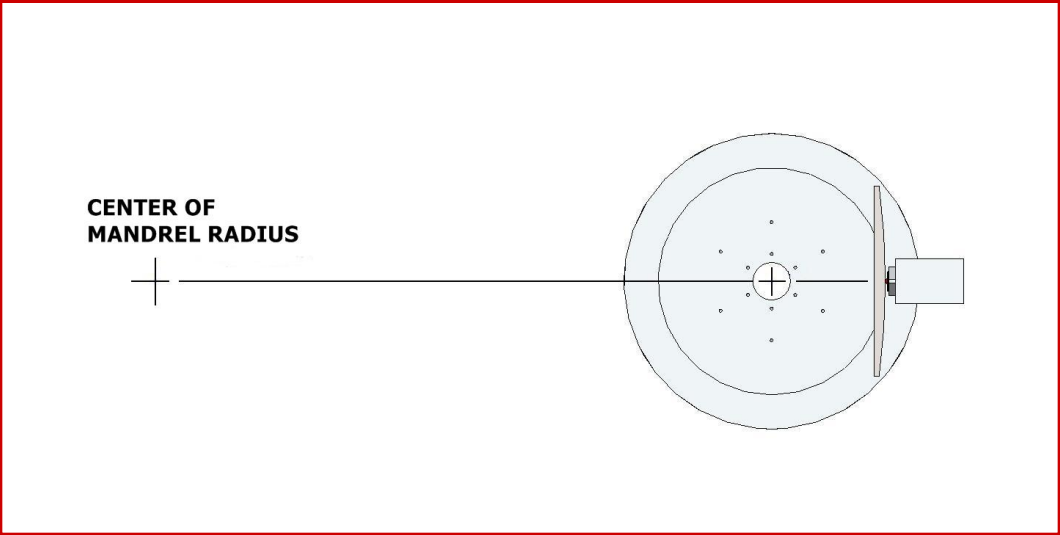

An overall perspective of the IXOMMM (without temperature enclosure)

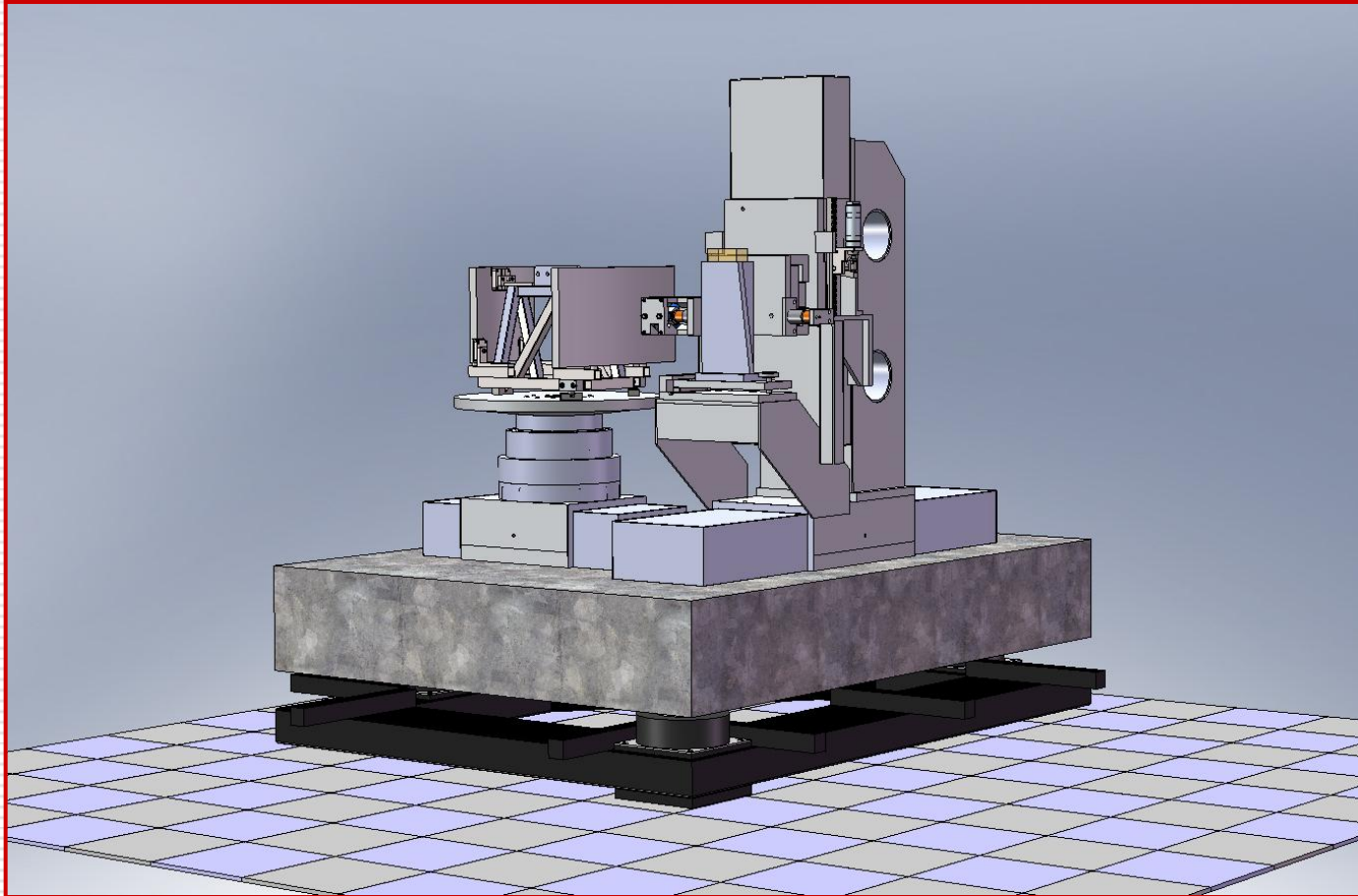

# Axis nomenclature and critical components and details of the IXOMMM

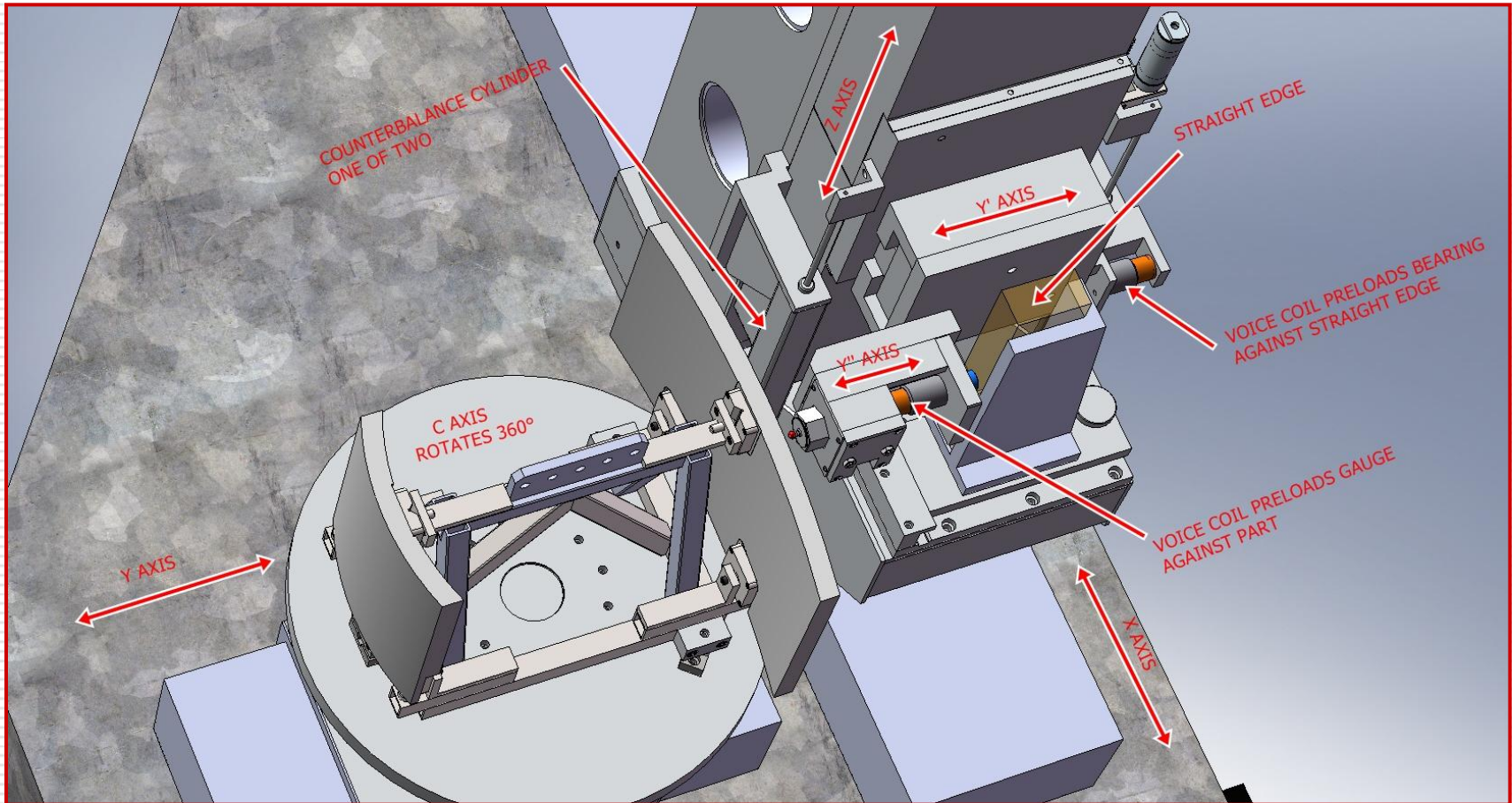

The gaugehead is actuated with a voice coil to provide a gauging range of 30 mm. Resolution is 53 pm, construction is principally Zerodur

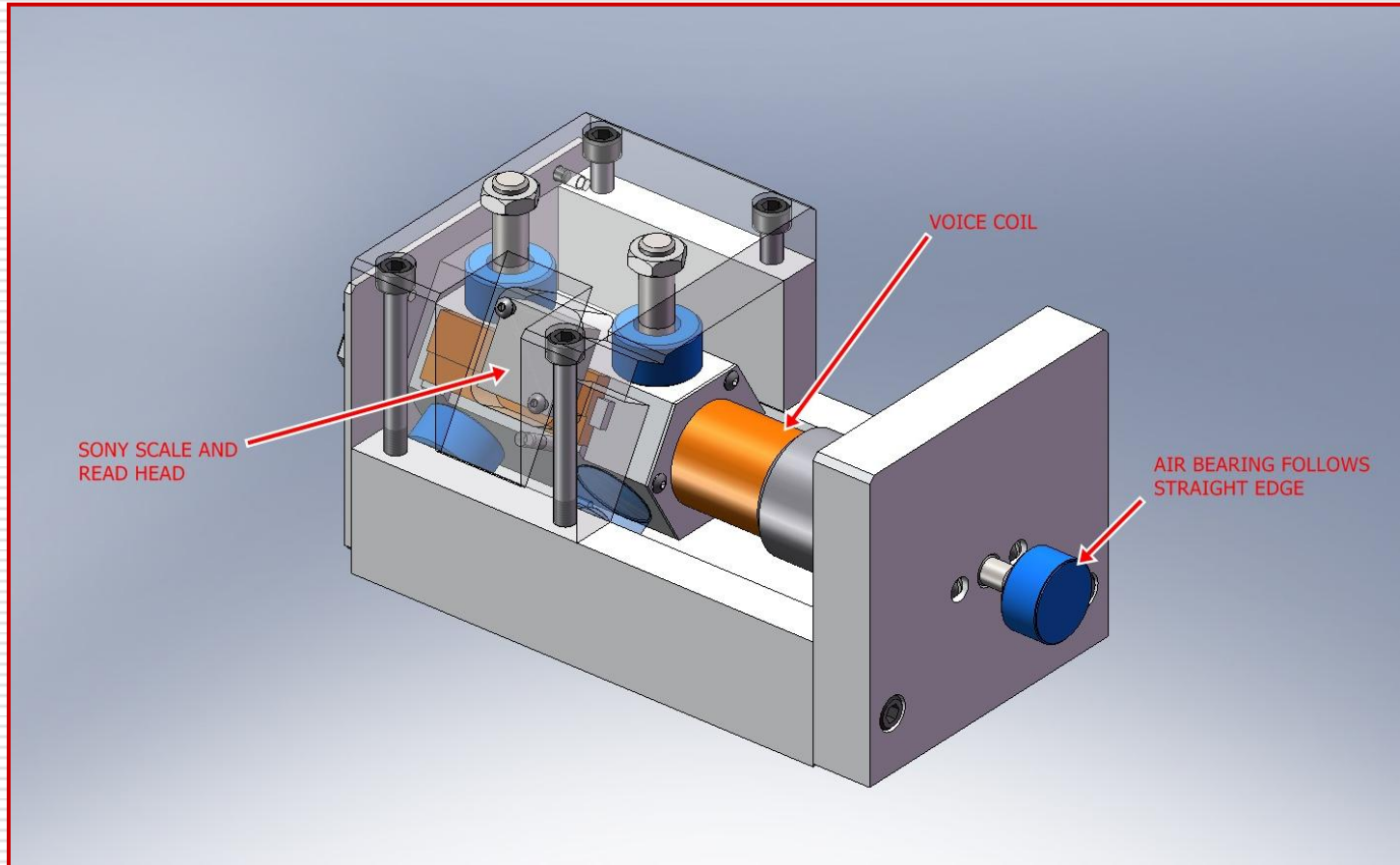

## Section view of the gaugehead

---

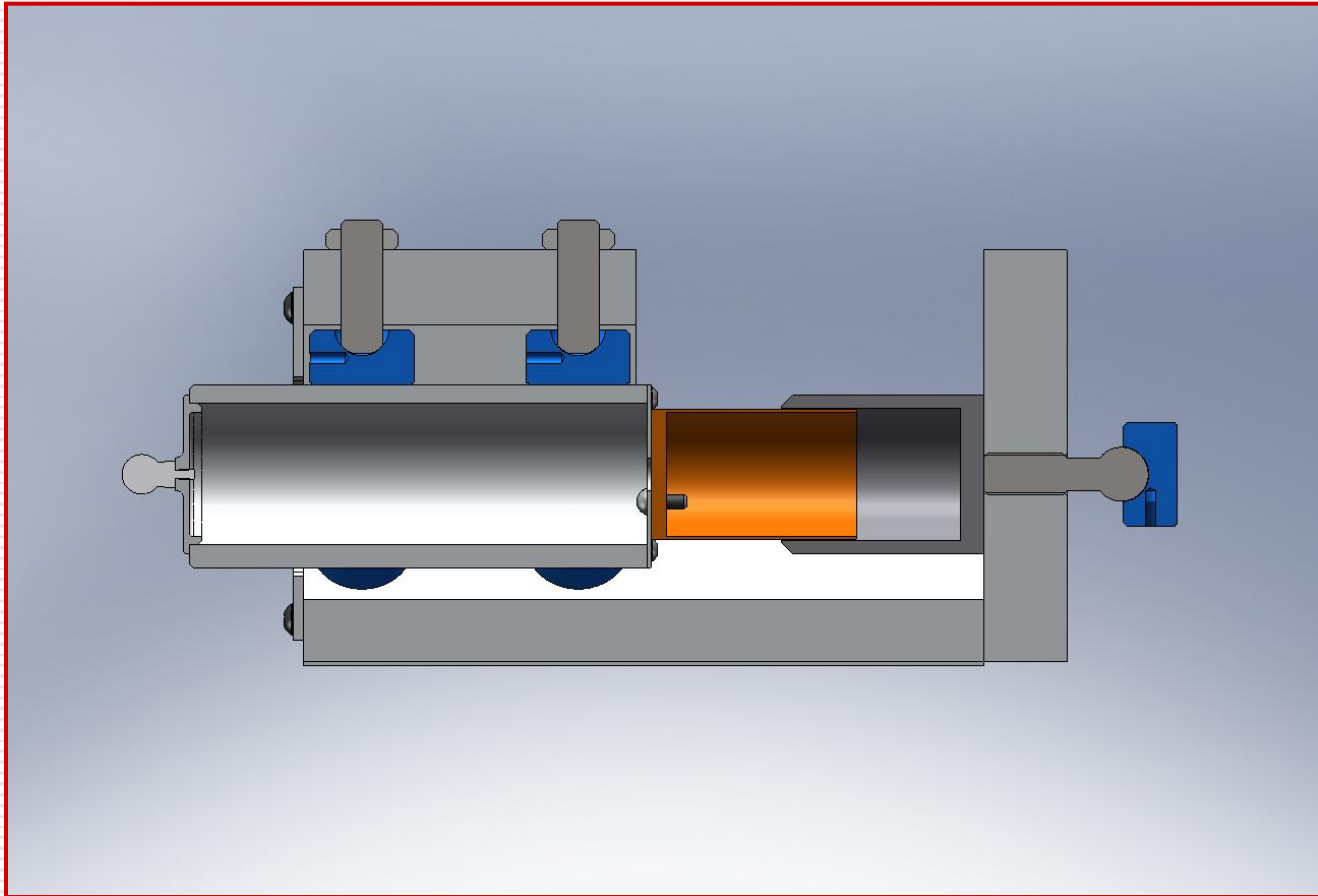

Mandrel components are mounted kinematically to a frame, which is kinematically supported to the rotary table. The entire assembly can then be kinematically mounted on the polisher.

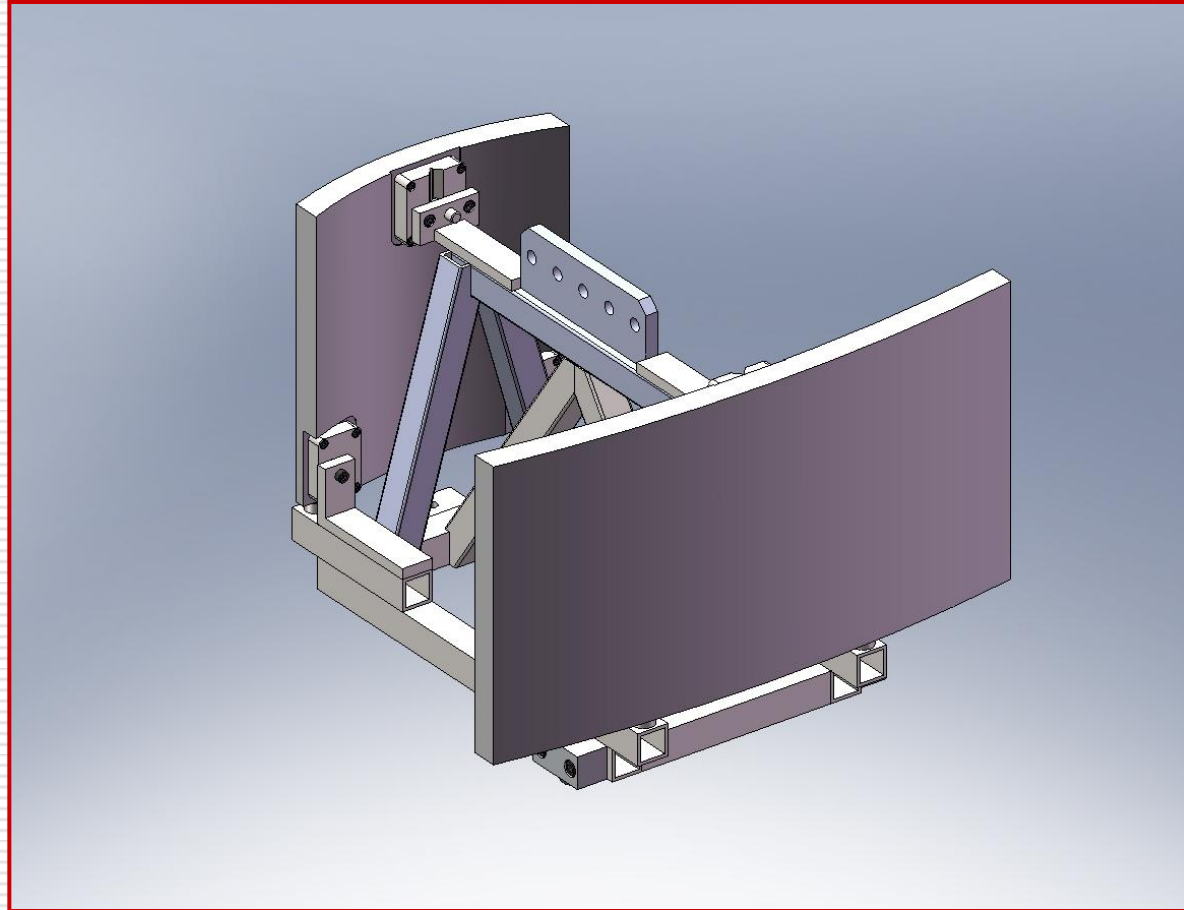

Temperature in the enclosure around the IXOMMM will be maintained within  $\pm 0.005^{\circ} \text{C}$ .

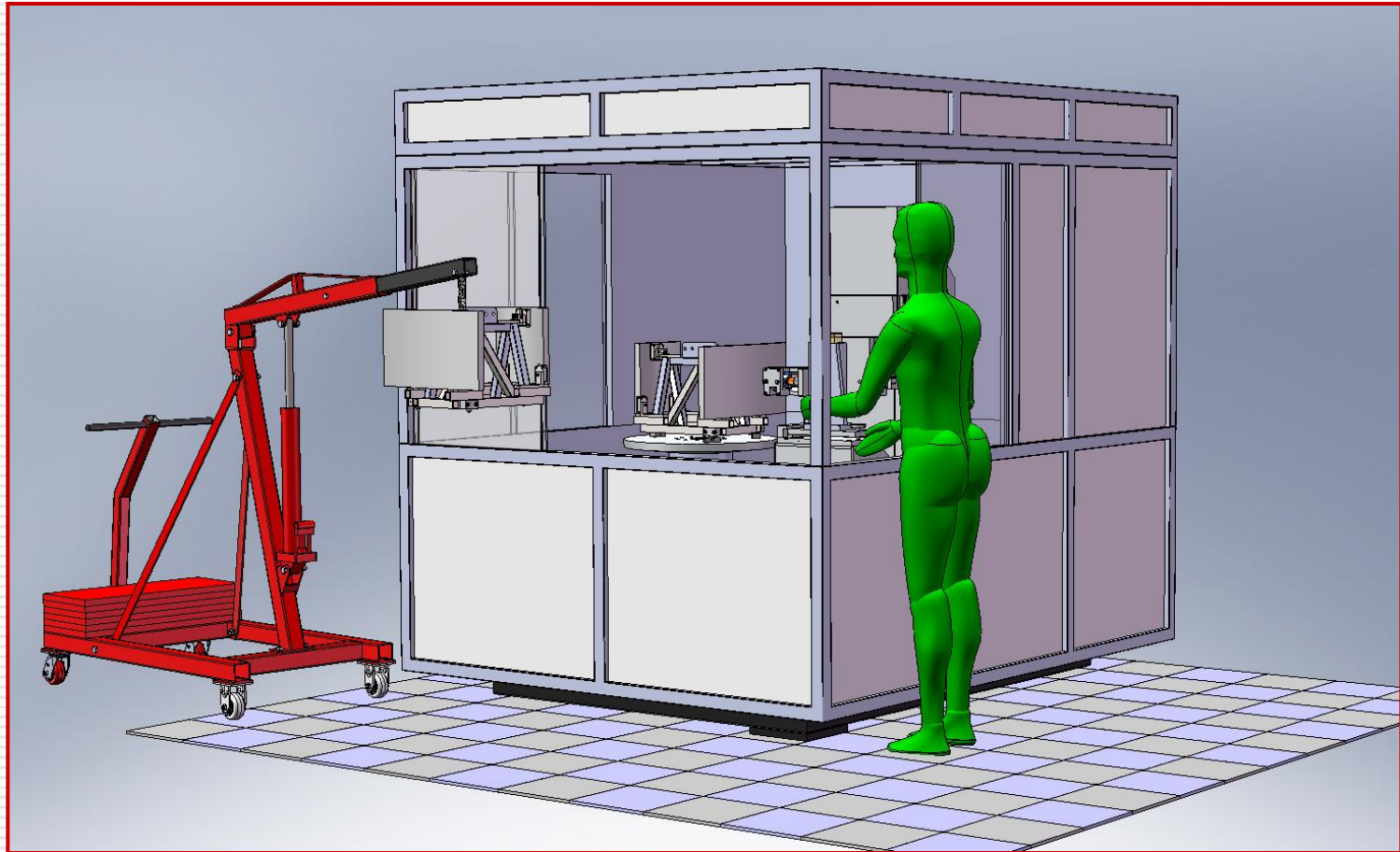

## Summary of current project status, Phase I work remaining

---

- ❑ Conceptual design is 95% complete
- ❑ Error budget is in progress—and has been used as a tool to guide the design, materials selection
- ❑ Specification is complete, measuring process established
- ❑ Phase I work remaining: Completion of error budget, Final Report, Plan for Implementation (Phase II), Plan for integrating to polisher (Phase III)

## Acknowledgements

---

We gratefully acknowledge the input of Peter Blake (COTR) and William Zhang. This work was supported by NASA SBIR S4.04-9574.